

TMR-LTXX09-XXXXSCXXX

KEYING OPTIONS	
A	LIGHT BROWN
B	RED
C	BLUE
D	GREEN

CONTACT FINISH	
0	GOLD

TERMINATION SIZE	
0	STANDARD

INSERT CODE	
008A	8 POSITION, STD
010A	10 POSITION, STD

HOUSING FINISH	
N	TIN NICKEL

HOUSING MATERIAL	
A	ALUMINUM

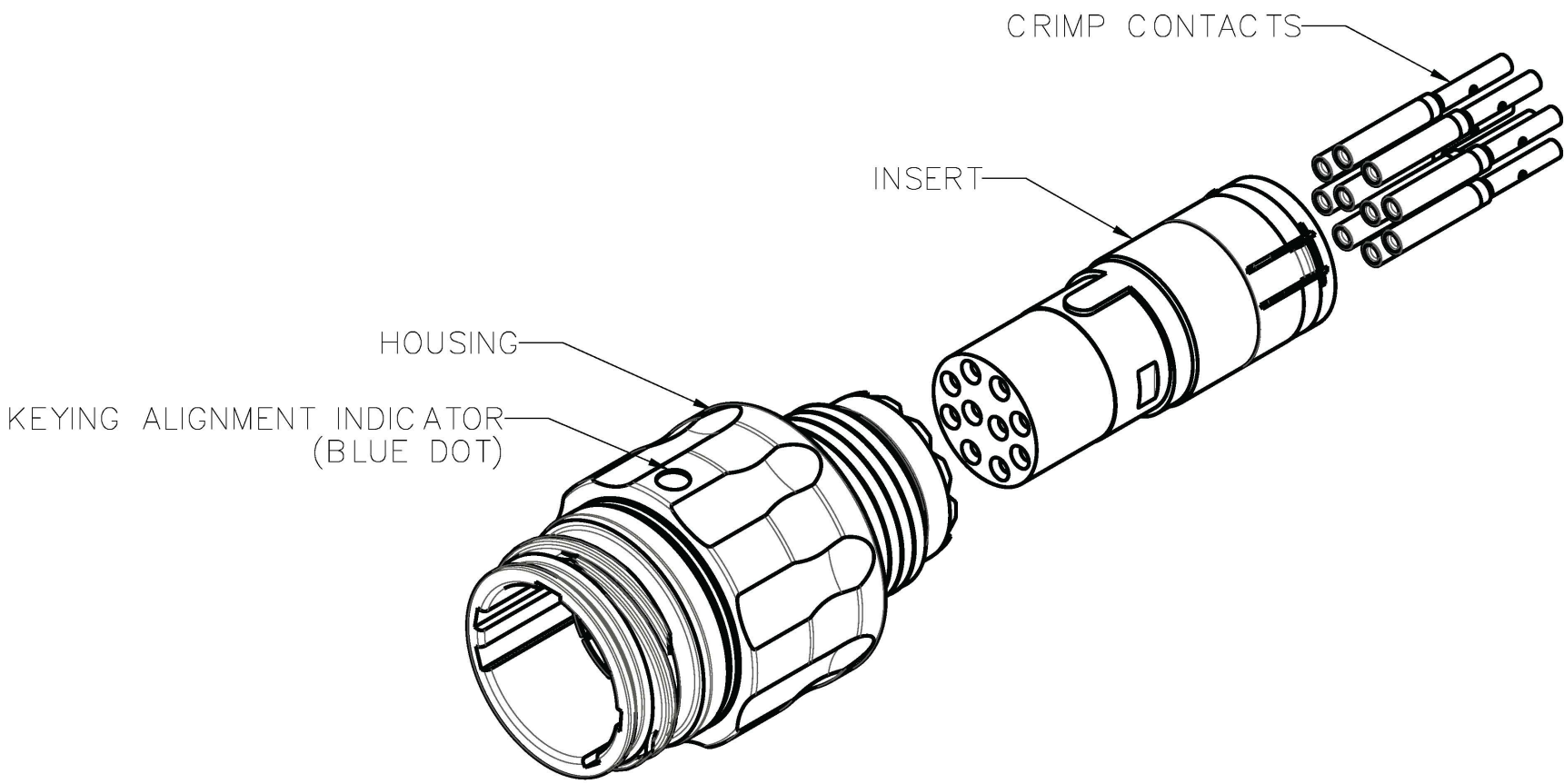

ISOMETRIC VIEW
FOR REFERENCE ONLY
TMR-LTAN09-010ASC00A SHOWN

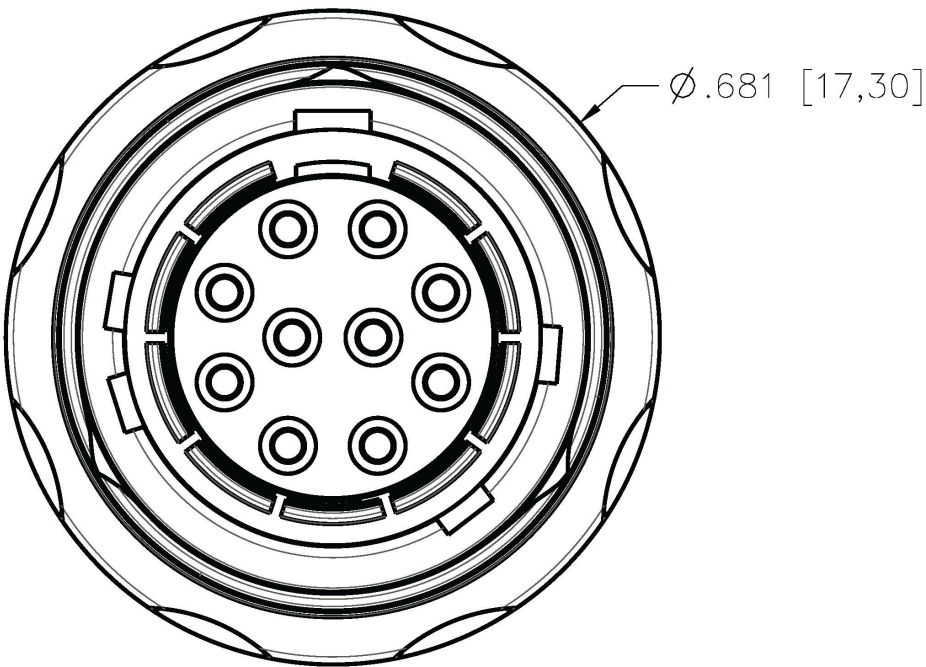
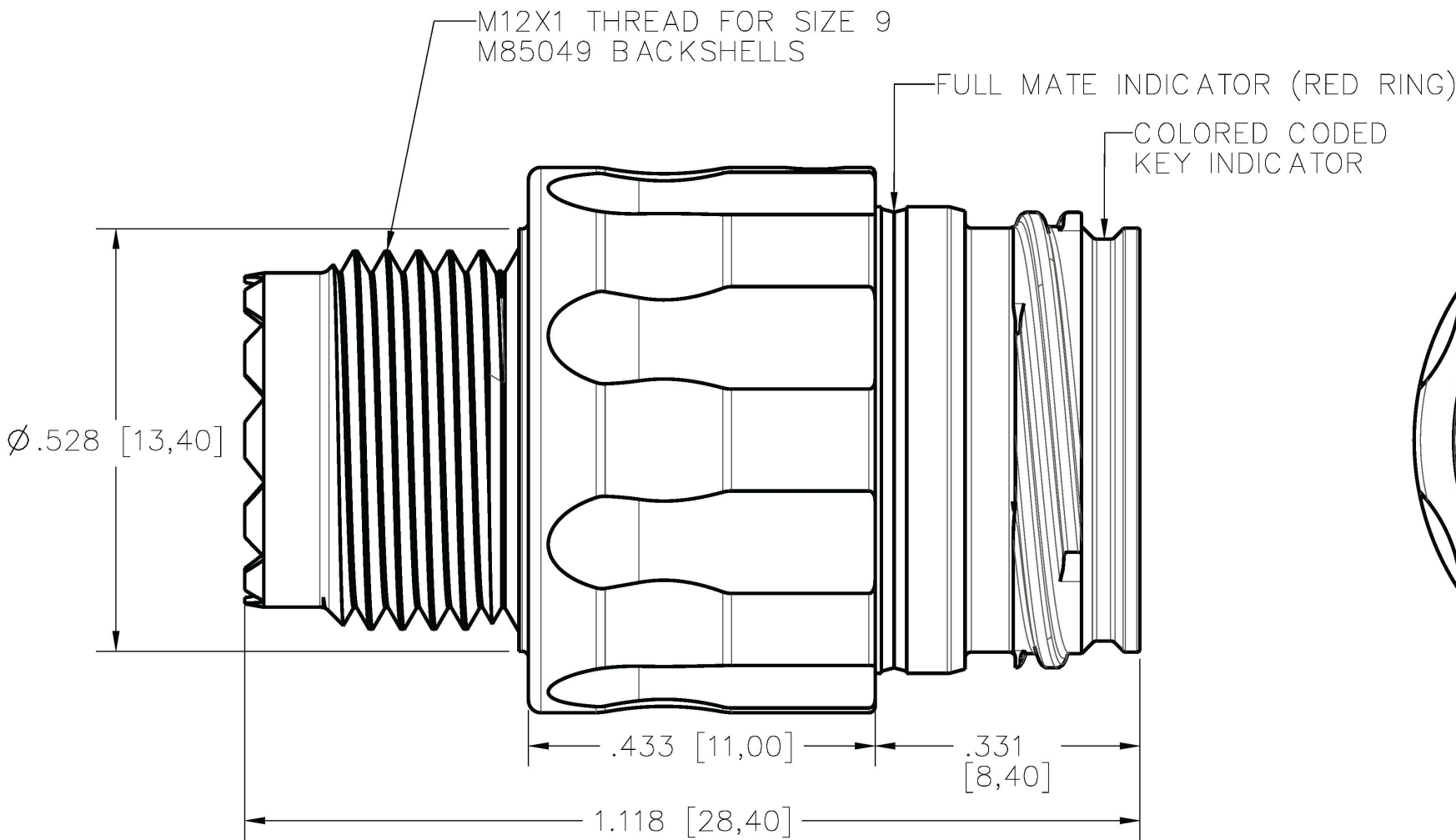

KEYING OPTIONS (VIEW LOOKING AT RECEPTACLE FACE)

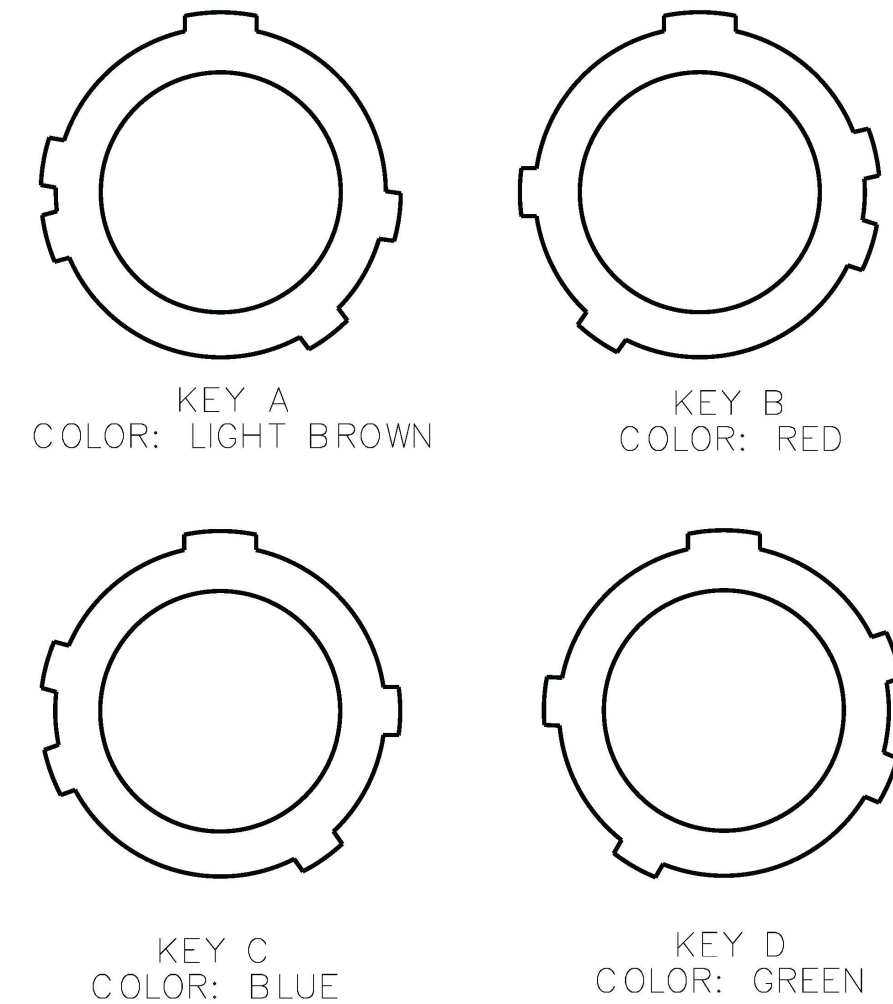

- NOTES:
- SEE ESG6092 FOR MATERIAL AND PERFORMANCE SPECIFICATIONS
 - SEE ESG6093 FOR ASSEMBLY INSTRUCTIONS
 - SIZE 22D SOCKET CONTACTS PER M39029/57-354



MATERIAL: SEE NOTES		UNLESS OTHERWISE SPECIFIED, TOLERANCES ARE: Decimals: .XX ± 0.01 Concentricity: Decimals: .XXX ± 0.008 Angles: ± 1° Decimals: .XXXX ± 0.0040 Radius: ± Parts are to be symmetrical about centerline within ± .005 Surfaces to be flat, perpendicular parallel within .004 T.I.R. Dimensions are in inches/DO NOT SCALE PRINT Surface finish to be $\sqrt{\text{ }}$ or better		AirBorn Georgetown, Texas 78626		Cage Code 10400	
HEAT TREAT: SEE NOTES		APPLICATION: TRIMATE SERIES		DRAWING STATE: Released		<input checked="" type="checkbox"/> RELEASED	
Per Spec.: Certification required: NO		- INITIAL RELEASE		DR. CC 060923		T I T L E	
FINISH: SEE NOTES		REV DESCRIPTION		DR. BY DATE		RCS 060923	
Per Spec.: Certification required: NO		MAKE FROM: N/A		REL. CC 060923		APPD. RCS 060923	
NEXT ASSY: N/A		▶ = CRITICAL CHARACTERISTIC ● = MAJOR CHARACTERISTIC		THIRD ANGLE PROJECTION		DWG# TMR-LTXX09-XXXXSCXXX	
						REV. SHEET - 1/3	

TMR-LTXX09-XXXXSCXXX

INSERT CODE	
008A	8 POSITION, STD

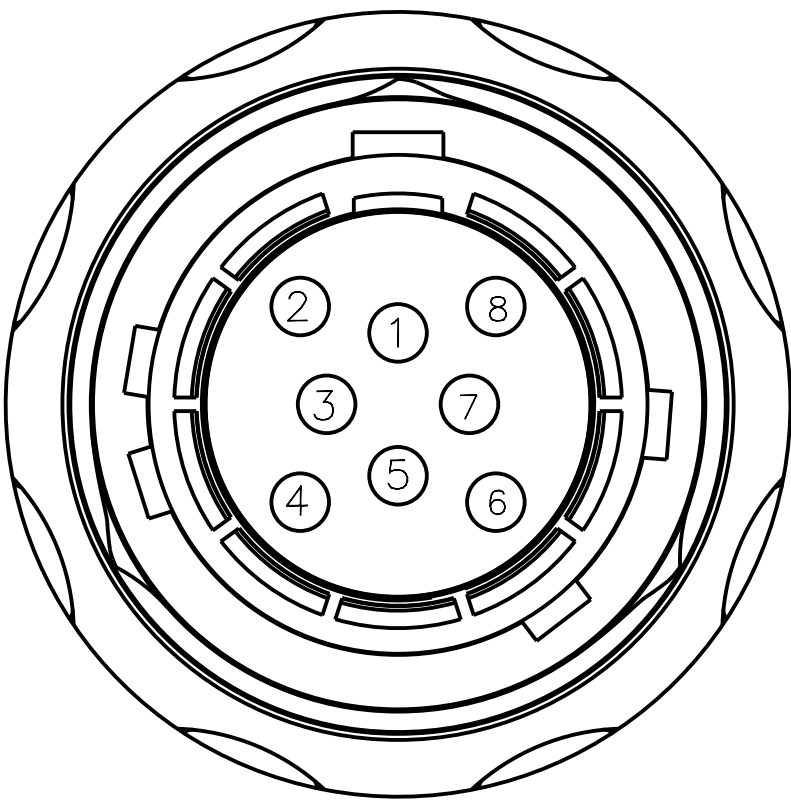
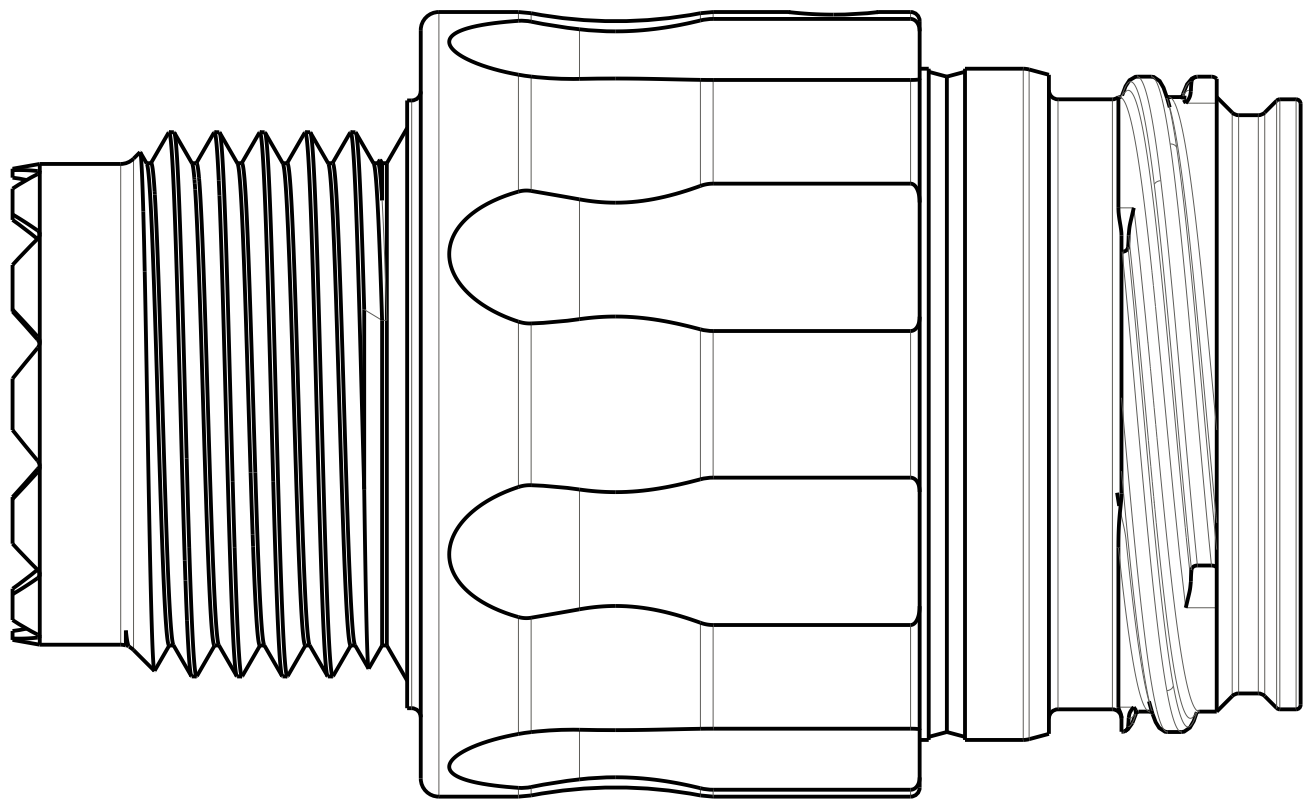
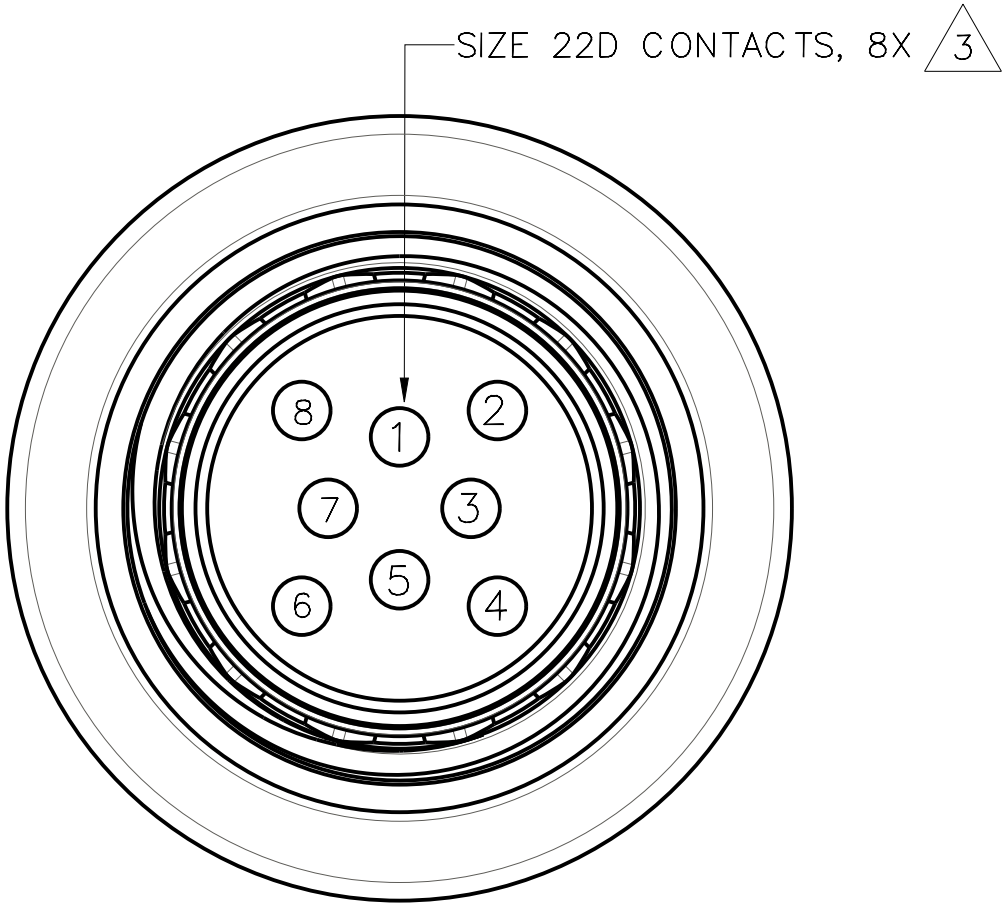

INSERT ARRANGEMENT 008A
FIGURES SHOWN ASSEMBLED WITH KEY OPTION A

FORMAT: CERNPRO.FRM A.7

TMR-LTXX09-XXXXSCXXX

INSERT CODE	
010A	10 POSITION, STD

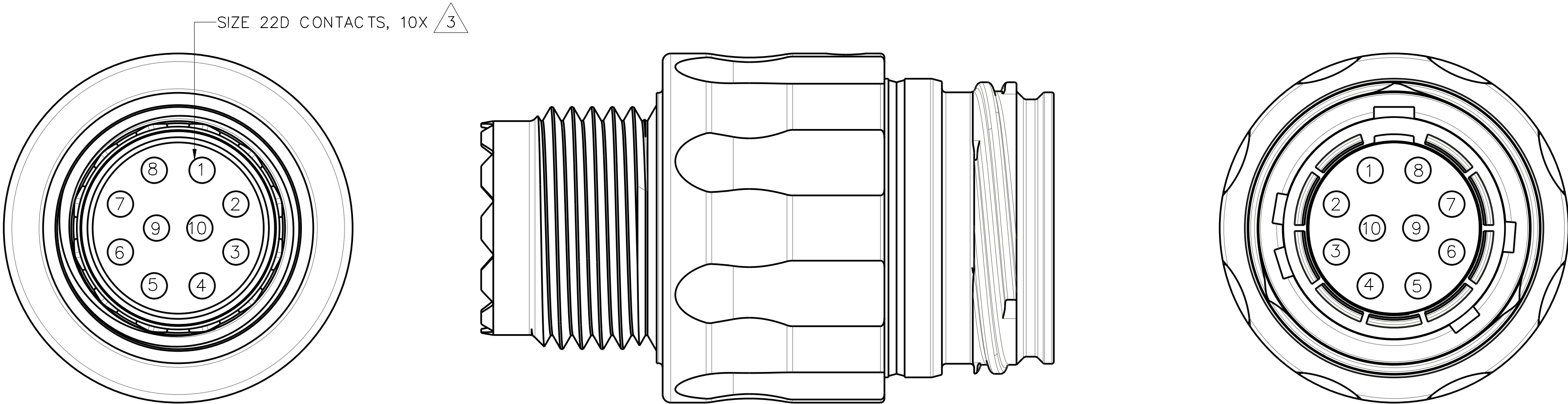

INSERT ARRANGEMENT 010A
FIGURES SHOWN ASSEMBLED WITH KEY OPTION A