

TMR-JSXX12-XXXXPCXXX

KEYING OPTIONS	
A	LIGHT BROWN
B	RED
C	BLUE
D	GREEN

CONTACT FINISH	
0	GOLD

TERMINATION SIZE	
0	STANDARD

INSERT CODE	
005A	5 POSITION, STD
018A	18 POSITION, STD

HOUSING FINISH	
N	TIN NICKEL

HOUSING MATERIAL	
A	ALUMINUM

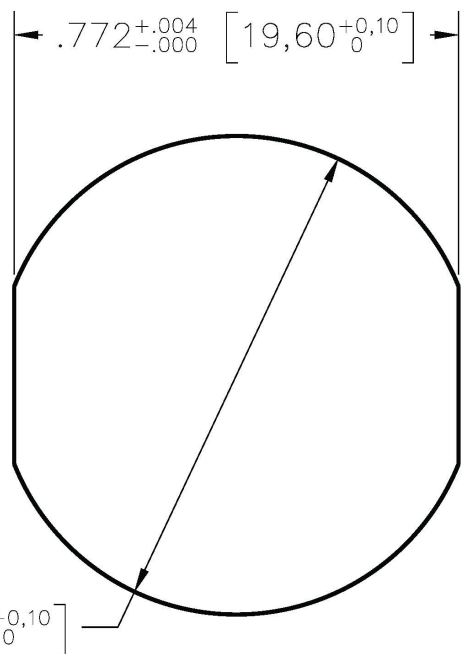

PANEL CUTOUT

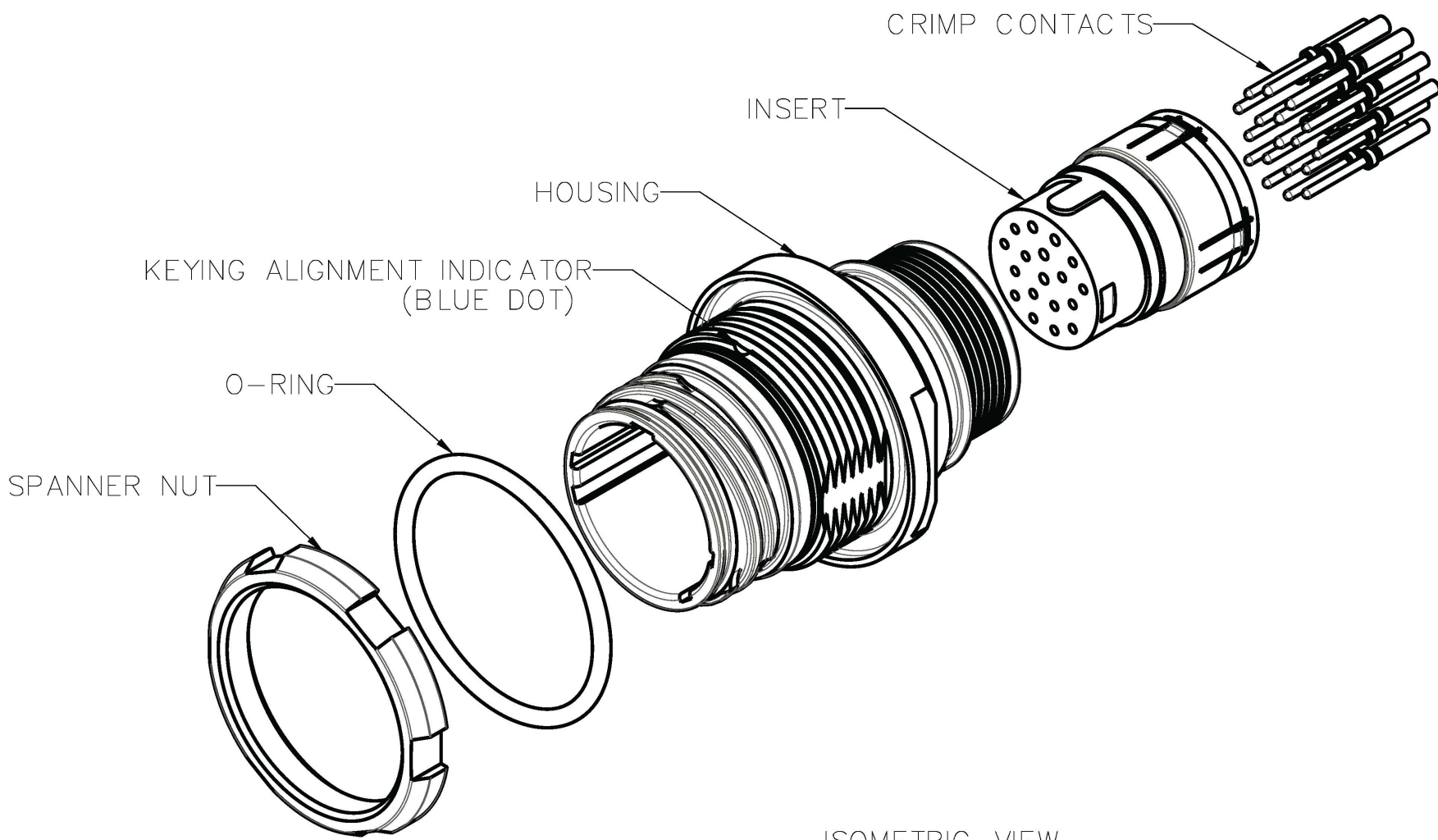

ISOMETRIC VIEW
FOR REFERENCE ONLY
TMR-JSAN12-018APC00A SHOWN

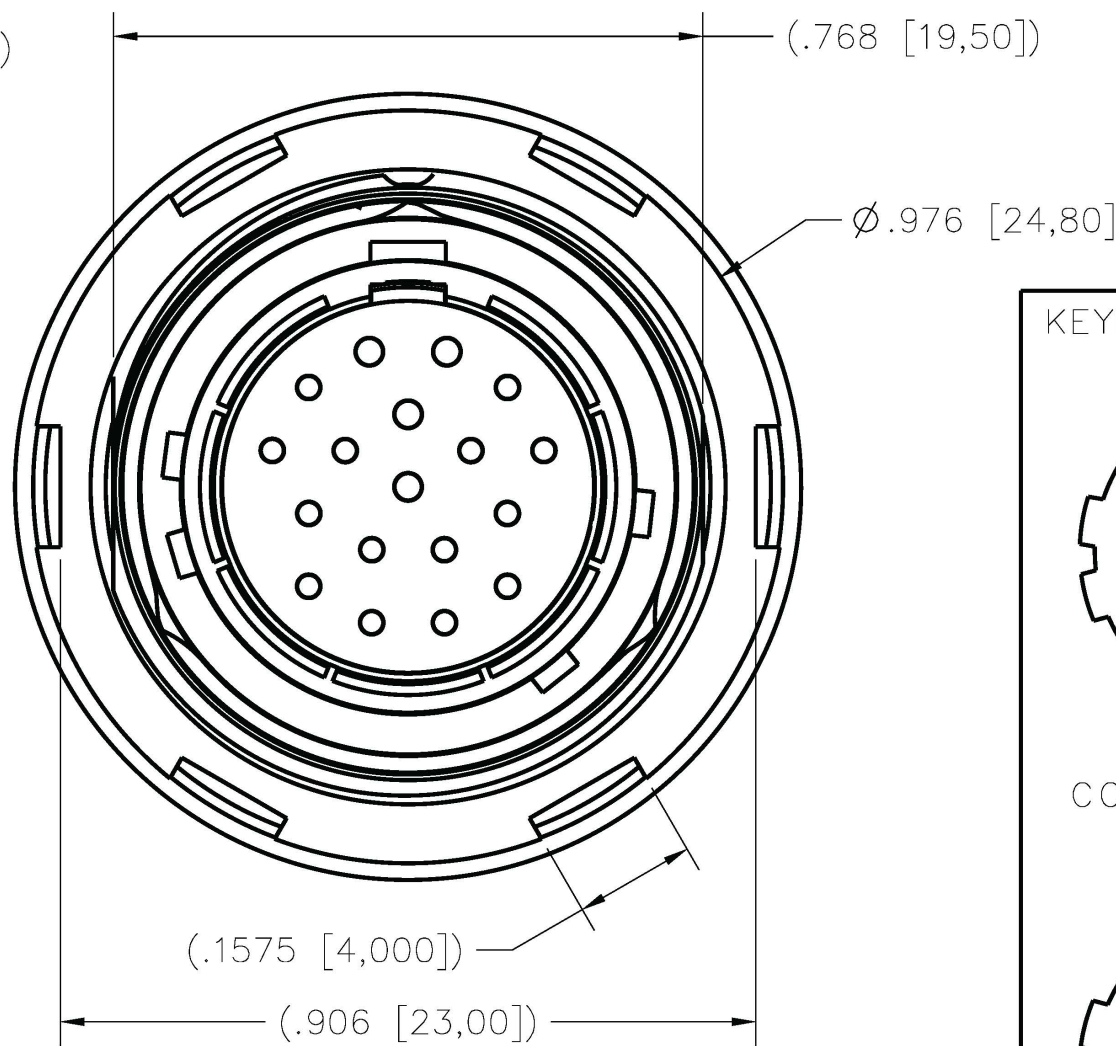
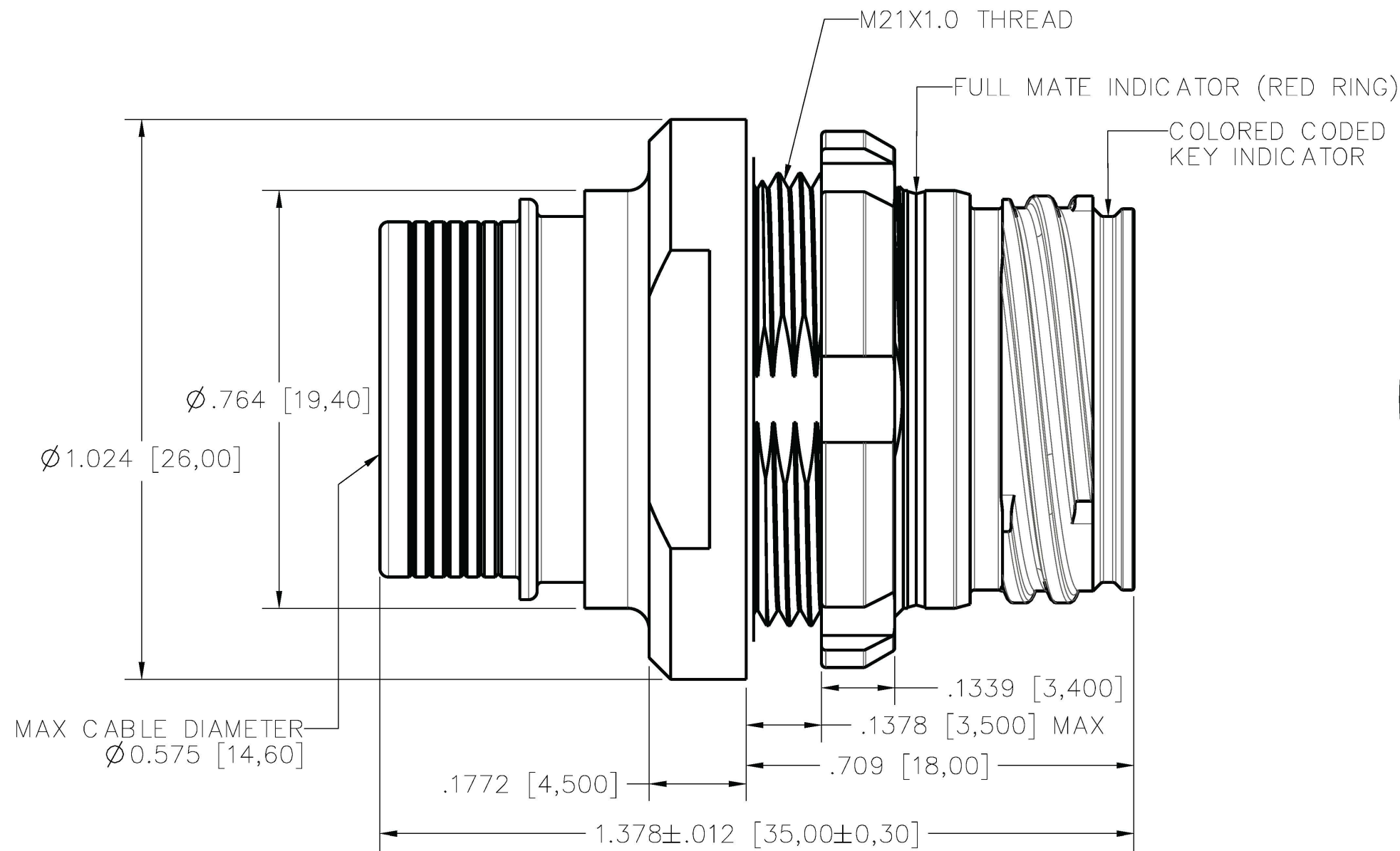

KEYING OPTIONS (VIEW LOOKING AT RECEPTACLE FACE)

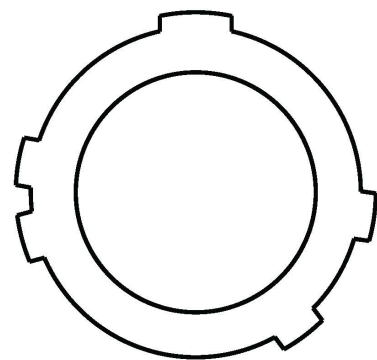

KEY A
COLOR: LIGHT BROWN

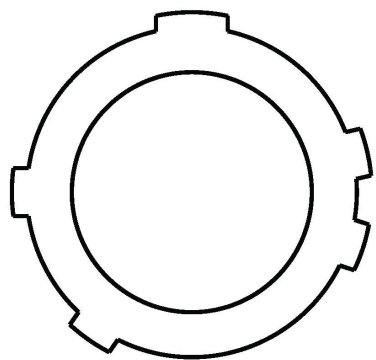

KEY B
COLOR: RED

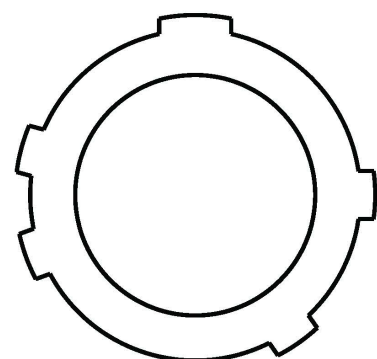

KEY C
COLOR: BLUE

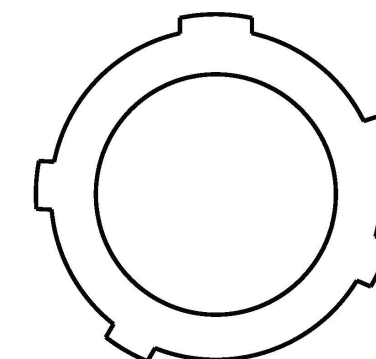

KEY D
COLOR: GREEN

- NOTES:
- 1. SEE ESG6092 FOR MATERIAL AND PERFORMANCE SPECIFICATIONS
 - 2. SEE ESG6093 FOR ASSEMBLY INSTRUCTIONS
 - 3. SIZE 16 PIN CONTACTS PER M39029/58-364
 - 4. SIZE 22D PIN CONTACTS PER M39029/58-360
 - 5. SIZE 20MD PIN CONTACTS PER AIRBORN TMC-P20MD
 - 6. SPANNER WRENCH PART NUMBER: TMT-N0012
 - 7. TORQUE NUT TO 88.5±8 IN-LB [10±1 Nm]

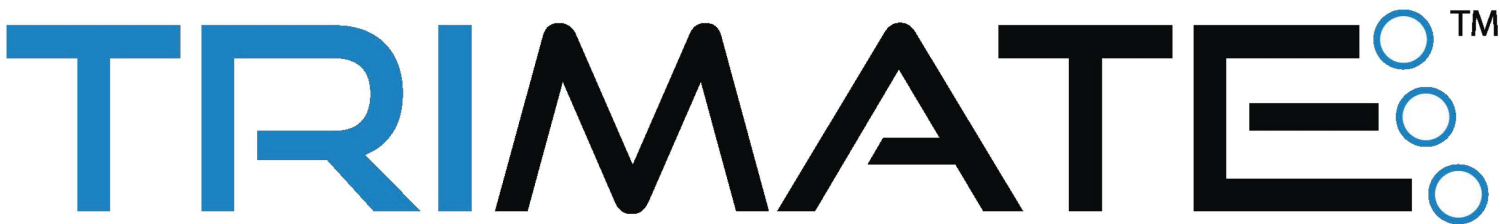

MATERIAL: SEE NOTES Temper: Per Spec.: R/M P/N ref: N/A Certification required: NO		UNLESS OTHERWISE SPECIFIED, TOLERANCES ARE: Decimals: .XX ± 0.01 Concentricity: Decimals: .XXX ± 0.008 Angles: ± 1° Decimals: .XXXX ± 0.0040 Radius: ± Parts are to be symmetrical about centerline within ± .005 Surfaces to be flat, perpendicular parallel within .004 T.I.R. Dimensions are in inches/DO NOT SCALE PRINT Surface finish to be or better					AirBorn Georgetown, Texas 78626		Cage Code 10400	
HEAT TREAT: SEE NOTES Per Spec.: Certification required: NO		APPLICATION: TRIMATE SERIES					DRAWING STATE: Released This drawing is not authorized for production unless it is released		<input checked="" type="checkbox"/> RELEASED	
FINISH: SEE NOTES Per Spec.: Certification required: NO		- INITIAL RELEASE		CC 060923		CC 060923		RECEPTACLE, SIZE 12		SIZE
		REV DESCRIPTION		DR. BY DATE		ECO NO. APPD. BY		JAM NUT, 1ST PINS, CRIMP		C
MAKE FROM: N/A NEXT ASSY: N/A		▶ - CRITICAL CHARACTERISTIC ● - MAJOR CHARACTERISTIC		THIRD ANGLE PROJECTION		REL. CC 060923		APPD. RCS 060923		DWG# TMR-JSXX12-XXXXPCXXX
								REV. -		SHEET 1/3

TMR-JSXX12-XXXXPCXXX

INSERT CODE	
005A	5 POSITION, STD

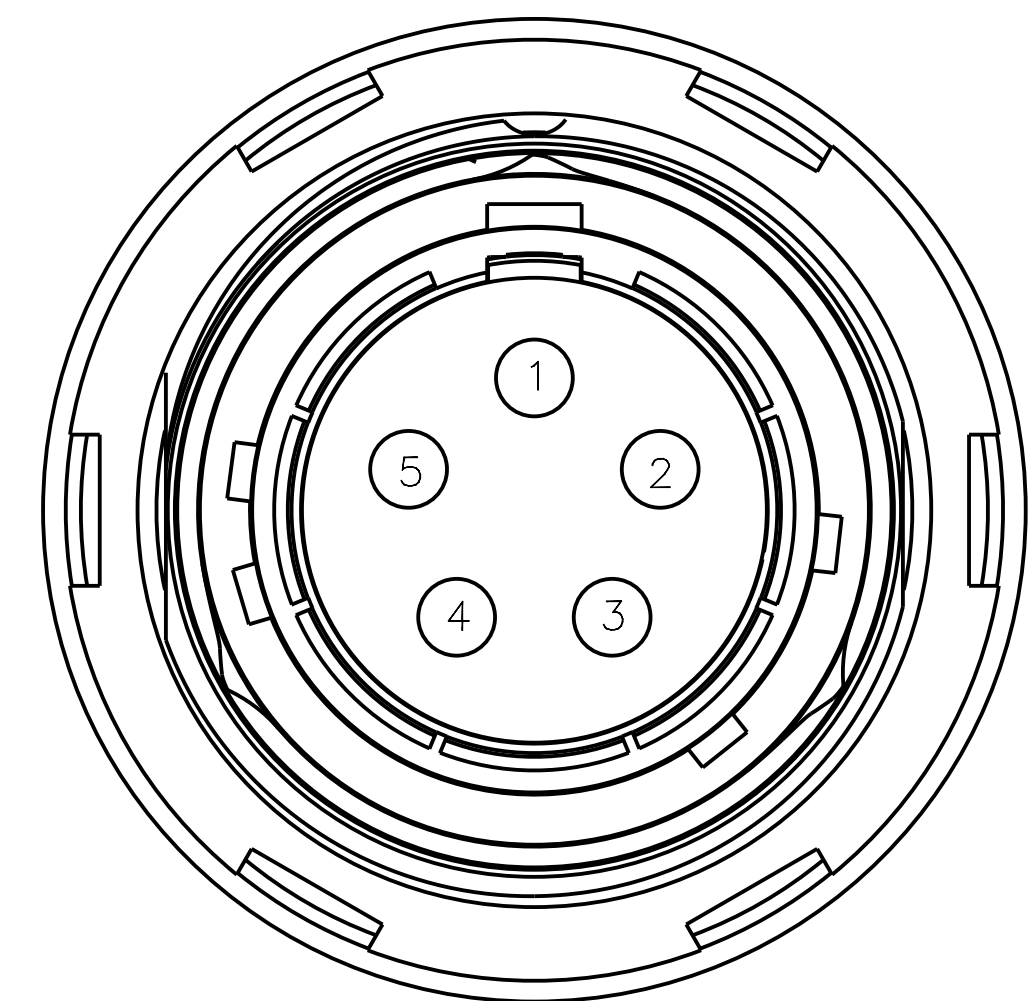
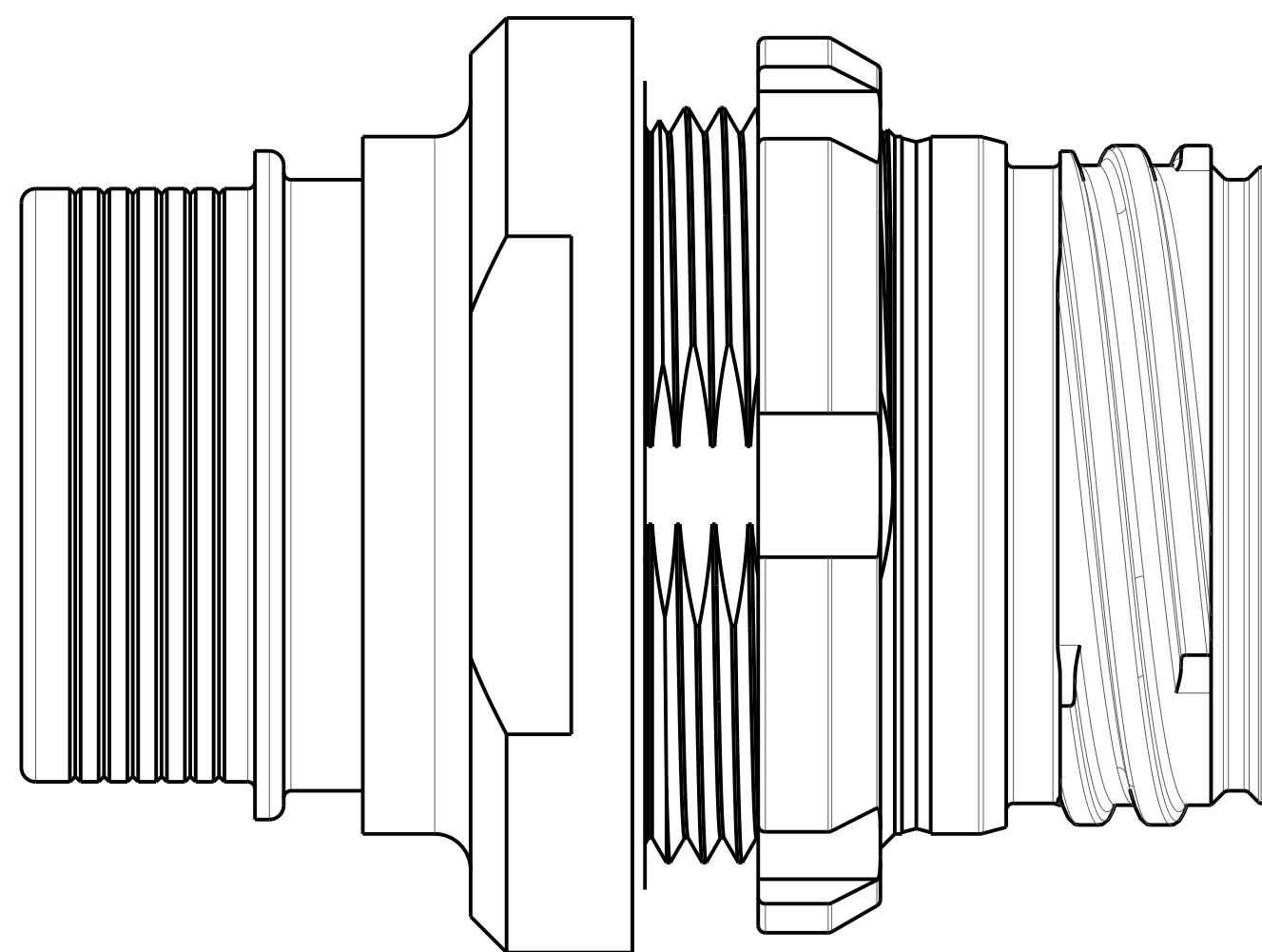
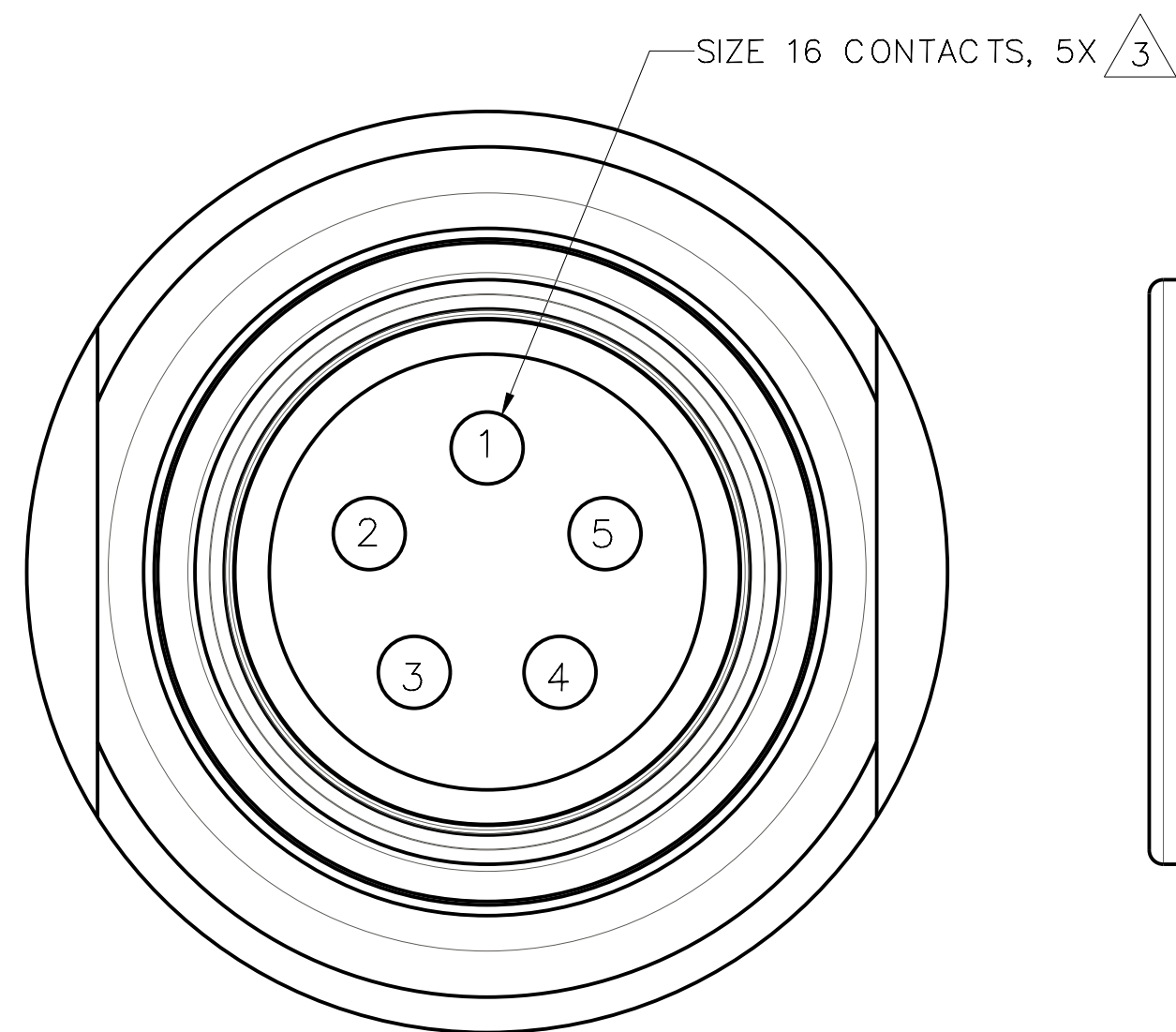

INSERT ARRANGEMENT 005A
FIGURES SHOWN ASSEMBLED WITH KEY OPTION A

FORMAT: CEMTPRO.FRM A.7

AirBorn
Georgetown, Texas 78626

RECEPTACLE, SIZE 12
JAM NUT, IST
PINS, CRIMP

DRAWING STATE: *Released* ☒ **RELEASED**
This drawing is not authorized for production unless it is released
DWG# TMR-JSXX12-XXXXPCXXX REV. - SHEET 2 / 3

SIZE
C

TMR-JSXX12-XXXXPCXXX

INSERT CODE	
018A	18 POSITION, STD

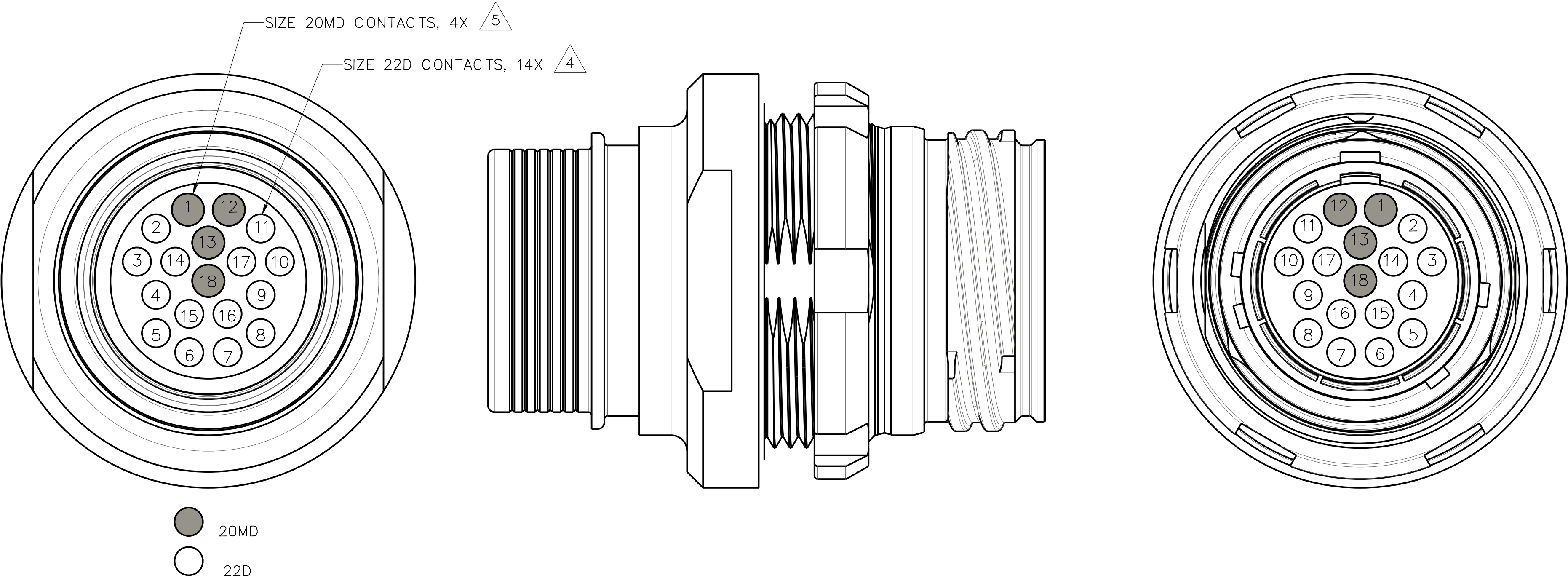

INSERT ARRANGEMENT 018A
FIGURES SHOWN ASSEMBLED WITH KEY OPTION A

FORMAT: CERNPRO.FRM A.7