

Quick Start Guide for SenseCAP Tracker

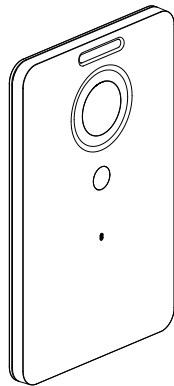

seeed studio

Download SenseCAP Mate App

SenseCAP Mate provides

- Configure device via Bluetooth
- Device binding and data viewing
- Upgrade the firmware via OTA

Scan the QR code to download App for iPhone or Android Phones.



Apple Store



Google Play



Android APK

Tips: To enjoy the full experience, we recommend signing up for an account and selecting Global as your platform.

1

Step 1 Add Device by Scanning QR Code



On the Device page, click on "+" to add a new device.



2

Step 2 Power On and Open Bluetooth



Please follow App guide step by step.

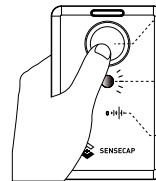

Press and hold the button for 3 seconds

LED: Blink at 1 second

Buzzer: Heard an ascending melody

You will hear a power-on sound from the device, and the LED will blink every second for 1 minute while waiting for Bluetooth pairing.

3

Step 3 Bluetooth Pairing and Configuration

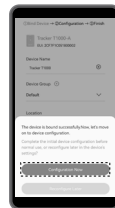

Select the "Configuration Now", and set frequency, interval and other parameters.

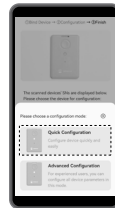

Select "Quick Configuration" when using SenseCAP platform as default. If you use another platform, select "Advanced Configuration".

Tips: Tracker needs LoRaWAN® to send data, please ensure nearby LoRaWAN® gateways or Helium network signals are available. Scan the QR code of User Guide for more guidance.

4

Step 4 Join the LoRaWAN® Network

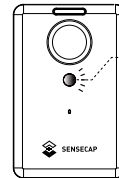

LED: Start breathing flash slowly

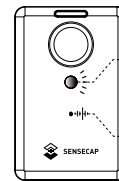

LED: Join succeed with LED flashes rapidly, if fails, LED will turn off

Buzzer: Join succeed with a cheerful ring

The device will try joining the LoRaWAN® network after being disconnected from Bluetooth. A successful ring and a rapid LED flash indicate joining successfully.

5

Step 5 Check the Location on Map



How to Enable Bluetooth Configuration

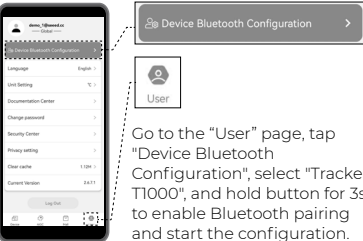

User Guide

For further guidance, please scan the user guide QR code or visit sensecap-docs.seeed.cc for download.



Documents

Support

Contact Seeed technical support at sensecap@seeed.cc. Please kindly provide the Product name, model, EUI and a detailed description of your device issue.

FAQs:

- Why can't I get the data?**
Please check the gateway connection to ensure that the LoRaWAN® network is working properly.
- Why is the location not successful?**
Select outdoor for Tracker GNSS testing as GNSS may not work well indoors.
- How to use Wi-Fi or Bluetooth location?**
GNSS is used by default. Set a geolocation strategy by referring to the User Guide.

Explanation of Other Button Functions

One-Click Positioning

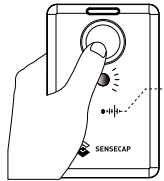
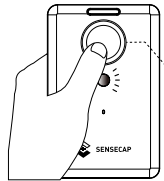

Press button once to retrieve the current location and upload to the server, the LED turns and for 2 seconds, and after around 30 seconds, the buzzer will beep once when the server received data successfully.

Double-Click SOS Mode

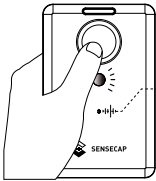
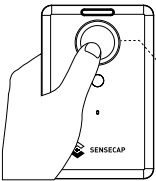

Double-click the button to activate SOS mode, uploading location and SOS event every minute. The device will automatically exit SOS mode after 30 uplink cycles, or exit by a Double-click again.

Power Off

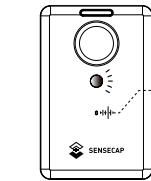
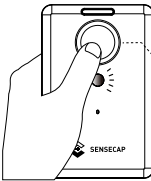

Press button and hold for 9 seconds, Melody of descent.

Charge the battery

Connect the USB magnet cable to a 5V adapter (voltage range 4.5~5.5V).

Charging	The LED will flash once every 3 seconds.
Fully charged	The LED will stay always on.

Warranty

Warranty period for device is 12 months as of the date of delivery. Please refer to this link for detailed information: seeedstudio.com/get_help>ReturnsRefund

WARNING

Please use SenseCAP Tracker with caution in hazardous environments or systems, including aircraft navigation or communication systems, air traffic control systems, transport management systems, medical or life-support systems, vehicle operation applications and safety response systems like police and fire departments. Also avoid using it for military or aerospace applications and weapons systems