

## INTRODUCTION



# CLIK-Mate™ 1.50mm (.059") Pitch Single and Dual Row Wire-to-Board System With Positive Lock

Molex's new CLIK-Mate™ 1.5 system offers designers a wide variety of styles in order to cover as many signal and power needs as possible for applications such as gaming machines and LCD/PDP TVs.

CLIK-Mate™ 1.5 is the latest edition to Molex's CLIK-Mate™ wire-to-board family. This new version is intended to bridge the gap between CLIK-Mate™ 1.25 and 2.0 by offering the optimum range of wire gauge choices in the smallest pitch possible.

The system is available in single and dual row styles, and includes both SMT and through-hole options. Circuit sizes range from 2-24. Both single and dual row versions use the same crimp terminal so you only need to hold one terminal in inventory and order just one application tool.

### Specifications:

- Current: 2.0A (1.0A for 503148)
- Voltage: 100V
- Contact Plating: Tin
- Contact Resistance: 20 milliohms max.
- Insulation Resistance: 500 Megohms min.
- Dielectric Withstanding Voltage: 500V AC
- Durability: 30 cycles
- Flammability: UL 94V-0

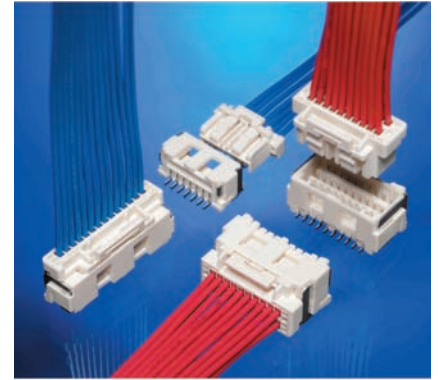

### Features

### Benefits

- |  |   |
|--|---|
| <ul style="list-style-type: none"> <li>• Wide variety of circuit sizes, mounting styles and wire gauges</li> </ul> | <ul style="list-style-type: none"> <li>• Design flexibility</li> </ul>  |
| <ul style="list-style-type: none"> <li>• Dual positive inner lock (6 circuits and above)</li> </ul>                | <ul style="list-style-type: none"> <li>• Greater mating assurance compared to outer-lock types</li> </ul>                               |
| <ul style="list-style-type: none"> <li>• Compact 1.50mm pitch</li> </ul>   | <ul style="list-style-type: none"> <li>• About 30% space savings versus similar 2.00mm versions</li> </ul>                              |
| <ul style="list-style-type: none"> <li>• Dual contact tuning fork design</li> </ul>                                | <ul style="list-style-type: none"> <li>• Low insertion force, secure mating contact and protection against terminal stubbing</li> </ul> |
| <ul style="list-style-type: none"> <li>• Footprint compatible with some competitive versions</li> </ul>            | <ul style="list-style-type: none"> <li>• Drop-in replacement</li> </ul>   |

CLIK-Mate™ terminal design protects against terminal stubbing and damage

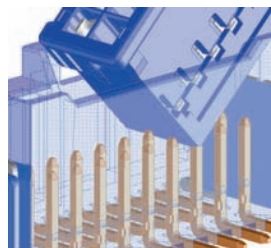

Pin and socket type

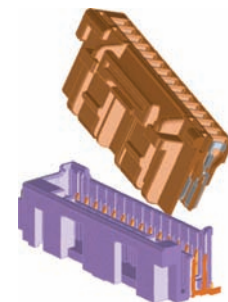

CLIK-Mate™ 1.5 Tuning-fork terminal interface

## MARKETS AND APPLICATIONS

- Pachinko/Gaming Machines
- LCD and PDP TVs
- Data Communication Equipment



**ORDERING INFORMATION**

# CLIK-Mate™ 1.50mm (.059") Pitch Single and Dual Row Wire-to-Board System With Positive Lock

		Single Row SMT		Single Row Through Hole		Dual Row SMT	
		Vertical	R/A	Vertical	R/A	Vertical	R/A
Part Number	Plug Housing	502578-**00				503149-**00	
	Terminal (Reel)	502579-0000 (AWG # 24-28)					
	PCB Receptacle	502584-**70 (*60 w./tape)	502585-**70	503159-**10 (*00 with peg)	503175-**10 (*00 with peg)	503154-**90	503148-**90
Current Rating		2A 100V				2A 100V	1A 100V
Circuits		2~15				10~24	
Size	Width	6.4	9.7	6.55	9.65	9.2	11.2
	Height	9.7	6.4	10.35	6.95	11.2	9.2
Lock Type		Inner lock Number of Locks (1: 2-5 cks, 2: 6-15 cks)				Inner lock Locks (1: 10 cks, 2: 12-24 cks)	
Plating		Tin					

Note: Replace \*\* with circuit size.

**molex**<sup>®</sup>  
one company > a world of innovation

**Americas Headquarters**  
2222 Wellington Ct.  
Lisle, Illinois 60532 USA  
Tel: 1-800-78MOLEX  
amerinfo@molex.com

**Asia Pacific North Headquarters**  
Yamato, Kanagawa, Japan  
Tel: 81-46-265-2325  
apninfo@molex.com

**Asia Pacific South Headquarters**  
Jurong, Singapore  
Tel: 65-6-268-6868  
apsinfo@molex.com

**European Headquarters**  
Munich, Germany  
Tel: 49-89-413092-0  
euroinfo@molex.com

**Corporate Headquarters**  
2222 Wellington Ct.  
Lisle, Illinois 60532 USA  
Tel: 630-969-4550

Visit our website at [www.molex.com](http://www.molex.com)