

**Ordering number C10918_BRIDGET-S**

Family	Bridget	FWHM	33 degrees
Type	Reflector	Efficiency	88 %
LED	BXRA ES Star	cd/Im	-
Color	Metal	Gerber File	Available
Diameter	22.6 mm		
Height	12.8 mm		
Style	Hexag		
Optic Material	PC		
Holder Material	-		
Fastening	Glue		
Status	Ready		

**Ordering number C10919_BRIDGET-M**

Family	Bridget	FWHM	47 degrees
Type	Reflector	Efficiency	88 %
LED	BXRA ES Star	cd/Im	-
Color	Metal	Gerber File	Available
Diameter	22.6 mm		
Height	12.8 mm		
Style	Hexag		
Optic Material	PC		
Holder Material	-		
Fastening	Glue		
Status	Ready		

**Ordering number C10920_BRIDGET-W**

Family	Bridget	FWHM	65 degrees
Type	Reflector	Efficiency	90 %
LED	BXRA ES Star	cd/Im	-
Color	Metal	Gerber File	Available
Diameter	22.6 mm		
Height	12.8 mm		
Style	Hexag		
Optic Material	PC		
Holder Material	-		
Fastening	Glue		
Status	Ready		

NOTE: The typical divergence will be changed by different color, chip size and chip position tolerance. The typical total divergence is the full angle measured where the luminous intensity is half of the peak value.



PRODUCT DATASHEET

Bridget series

last update 3/10/2012



GENERAL INFORMATION

- Product series especially designed & optimized for BXRA ES Star series of LEDs.
- Special care taken to make light distribution as uniform as possible.
- Reflector is made of aluminium coated PC (120 degrees of Celcius / 248 degrees of Fahrenheit) with protective lacquer (110 degrees of Celcius / 230 degrees of Fahrenheit).
- Fastening to PCB with appropriate adhesive. By clicking link below you can find Ledil recommended glue options.
http://www.ledil.com/datasheets/DataSheet_GLUES.pdf

NOTE 1: We advise customer to ensure the suitability and sufficiency of the bond in the end product. For example, mechanical stress, vibration and holes on the surface of the circuit board weaken the strength of the glue.

NOTE 2: All surfaces where glue is applied must be clean, dry and free from grease and dirt. If cleaning of PCB surfaces is needed, please follow strictly the cleaning instructions of your LED manufacturer -this is important as cleaning shall under no circumstances damage LEDs or other electronics components on the PCB.

Further note that optical components shall not be cleaned with any chemicals - only micro fiber cloth may be used to remove fingerprints or other traces from handling.

Relative Intensity of C10920_Bridget-W

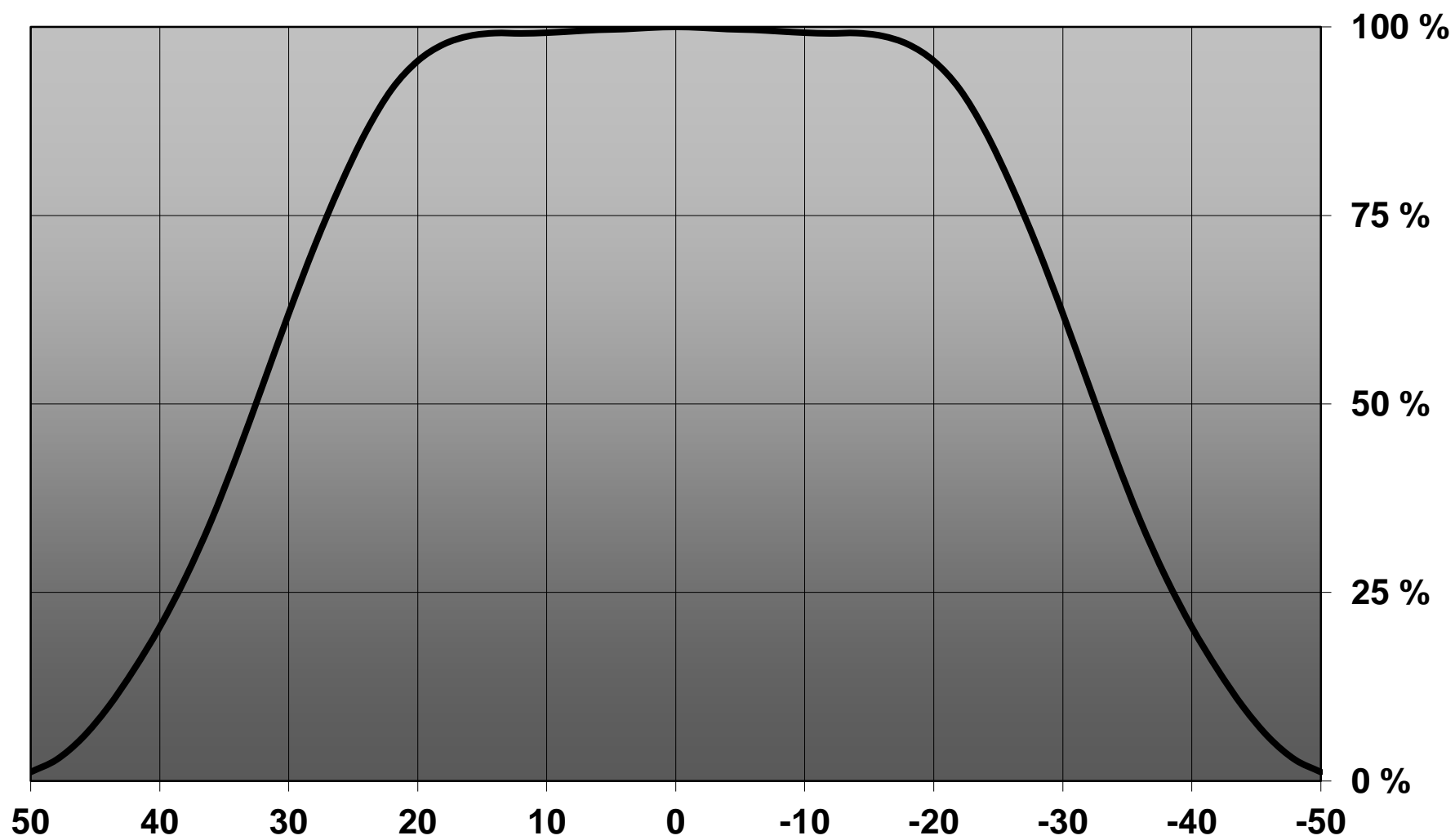



Isometric view
Scale: 1:1

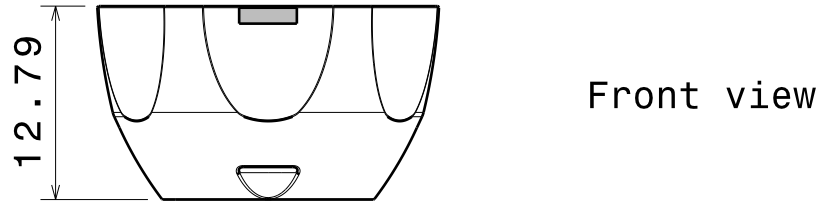
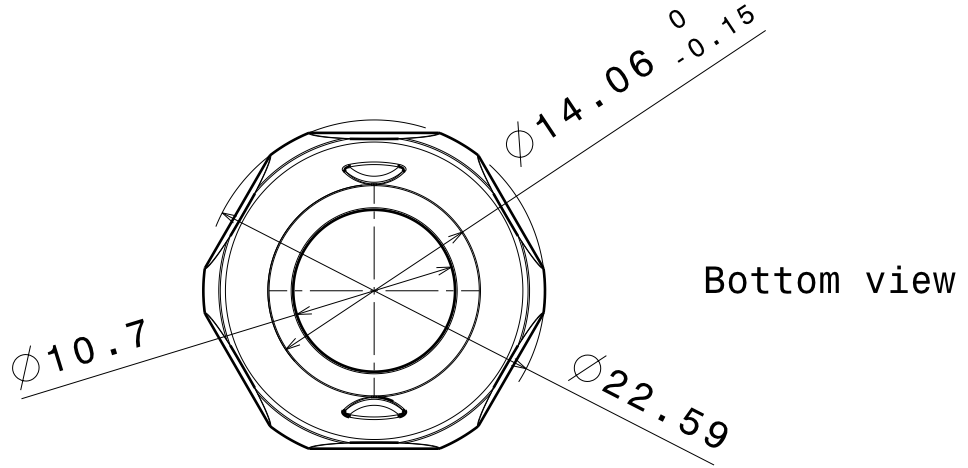

Material: PC with Metal coating
and clear lacquer

Part no.s:
Spot C10918_Bridget-S
Medium C10919_Bridget-M
Wide C10920_Bridget-W

This drawing is our property.
It can't be reproduced
or communicated without
our written agreement.



Ledil Oy
Tehdaskatu 13
FIN-24100 SALO
Finland

DRAWING TITLE

Datasheet Bridget Reflector

DRAWN BY pv	DATE 06.05.2009	DRAWING TITLE Datasheet Bridget Reflector					
CHECKED BY tk	DATE 27.04.2009	SIZE A4	DRAWING NUMBER C10918-10920				REV 1
DESIGNED BY hh	DATE 27.04.2009	SCALE 2:1	WEIGHT (g)			SHEET 1 / 1	