

# Spacers

## Brass Hexagonal Pillars

- ❖ Special body lengths can be specified, by modifying the order code. For example, R30-400xx02, xx denotes body length in mm.
- ❖ Please contact [technical@harwin.com](mailto:technical@harwin.com) for further information.
- ❖ Base material is free-machining brass, with nickel plating.

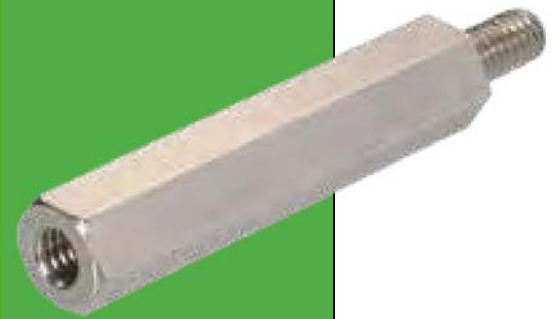

### MALE/MALE

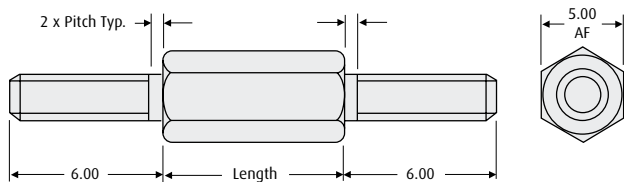

### MALE/FEMALE

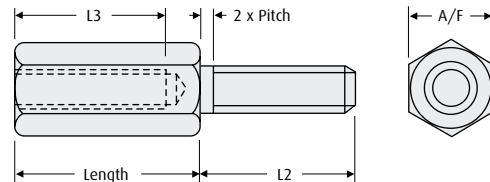

### CALCULATION OF L3 (min)

Series	Length mm										
	4	5	6	7	8	9	10	11	12	13	14+
R30-300	2.5	3.0	3.0	5.0	5.5	6.0	6.0	6.0	6.0	6.0	6.0
R30-301	2.5	3.0	3.0	5.0	5.5	6.0	7.0	8.0	8.0	8.0	8.0
R40-300	x	x	2.5	3.0	4.5	5.5	6.5	8.0	8.0	8.0	8.0
R50-300	x	x	x	x	4.0	5.0	6.0	7.5	8.0	10.0	10.0
R60-300	x	x	x	x	x	x	5.0	7.0	7.0	8.0	10.0

### HOW TO ORDER

**R XX - XXX XX 02**

#### SERIES CODE

#### THREAD SIZE & STYLE

R30-300	M3 Male/Female, 5.0mm A/F, L2 = 6mm
R30-301	M3 Male/Female, 5.0mm A/F, L2 = 8mm
R30-400	M3 Male/Male
R40-300	M4 Male/Female, 7.0mm A/F, L2 = 8mm
R50-300	M5 Male/Female, 8.0mm A/F, L2 = 10mm
R60-300	M6 Male/Female, 10.0mm A/F, L2 = 10mm

#### FINISH

**02** Nickel

#### LENGTH (mm)

<b>04-16, 18, 20, 25, 30, 35, 40</b>	R30
<b>06-16, 18, 20, 25, 30, 35</b>	R40
<b>08-16, 18, 20, 25, 30, 35, 40</b>	R50
<b>10-16, 18, 20, 25, 30, 40</b>	R60

All dimensions in mm.

[www.harwin.com](http://www.harwin.com)





# Spacers

## Clearance spacers

- ❖ Special body lengths can be specified, by modifying the order code. For example, R30-601xx02, xx denotes body length in mm.
- ❖ Please contact [technical@harwin.com](mailto:technical@harwin.com) for further information.
- ❖ Brass spacers: base material is free-machining brass, with nickel plating.
- ❖ Aluminium spacers: supplied with a chromate conversion protective coating.

### CLEARANCE SPACERS



Brass, circular



Aluminium, circular



Plastic, circular

### HOW TO ORDER

**R XX - XXX XX XX**

SERIES CODE

	THREAD SIZE	MATERIAL	OUTSIDE DIA.
<b>R30-601</b>	M3 Clearance	Brass	Ø4.75mm
<b>R30-620</b>	M3 Clearance	Aluminium	Ø5mm
<b>R30-670</b>	M3 Clearance	Plastic	Ø5mm
<b>R40-600</b>	M4 Clearance	Brass	Ø6.5mm
<b>R40-661</b>	M4 Clearance	Plastic	Ø8mm

MATERIAL/FINISH

<b>00</b>	Plastic	
<b>02</b>	Brass/Nickel	
<b>14</b>	Aluminium/Chromate	

LENGTH (mm)

**03 to 16, 18, 20, 25, 30**

[www.harwin.com](http://www.harwin.com)

All dimensions in mm.



**HARWIN**

SPACERS

151

# Spacers

## Threaded Female Spacers

- ❖ Special body lengths can be specified, by modifying the order code. For example, R30-100xx02, xx denotes body length in mm.
- ❖ Please contact [technical@harwin.com](mailto:technical@harwin.com) for further information.
- ❖ Brass spacers: base material is free-machining brass, with nickel plating.



### THREADED SPACERS



**R25-100**

Brass, Hexagonal  
M2.5, 5.0mm A/F



**R30-100**

Brass, Hexagonal  
M3, 5.0mm A/F



**R30-101**

Brass, Hexagonal  
M3, 5.5mm A/F



**R30-161**

Plastic, Hexagonal  
M3, 5.5mm A/F



**R30-500**

Brass, Circular  
M3, Ø4.75mm O/D



**R40-100**

Brass, Hexagonal  
M4, 7.0mm A/F



**R44-100**

Brass, Hexagonal  
4-40 UNC, 5.0mm A/F

### HOW TO ORDER

**RXX - XXX XX XX**

**SERIES CODE**

See pictures above

**LENGTH (mm)**

<b>04 to 16, 18, 20, 25</b>	Other
<b>06 to 16, 18, 20, 25</b>	R30-161, R40-100
<b>06 to 16, 18, 20, 25</b>	R44-100

**MATERIAL/FINISH**

<b>00</b>	Plastic	
<b>02</b>	Brass/Nickel	

All dimensions in mm.

[www.harwin.com](http://www.harwin.com)



