

SMT Coin Cell Holder

Battery retainer for Ø12mm coin cell

- ❖ Tape & reel packaged for auto-placement to PCB.
- ❖ Highly effective retention of coin cell batteries.
- ❖ Eliminates the need for soldered-in coin cells.
- ❖ Low profile design available with dual independent contact points for enhanced electrical reliability.
- ❖ Accommodates CR1220, CR1225 and similar coin cell batteries.

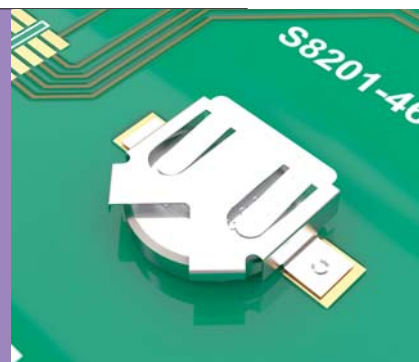

LOW PROFILE

❖ Packaging

Format: Tape and Reel
Reel quantity: 1,000 on a Ø330mm reel

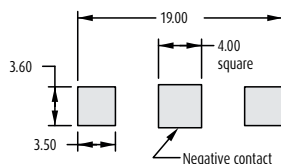
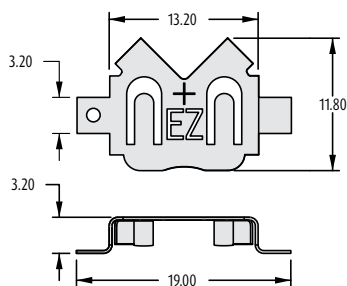

Recommended PC Board Pattern

STANDARD

❖ Packaging

Format: Tape and Reel
Reel quantity: 500 on a Ø330mm reel

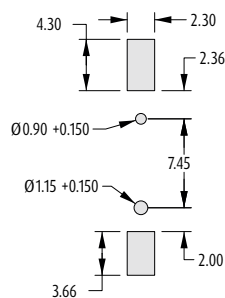
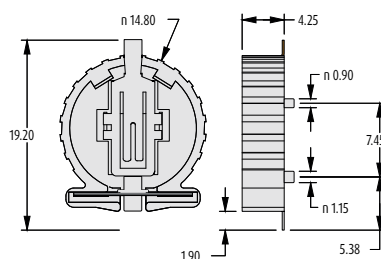

Recommended PC Board Pattern

HOW TO ORDER

SERIES CODE		PACKAGING	
S8 XX1 - XX R		R	Tape & Reeled

TYPE		FINISH	
201	Low Profile	45	Gold (S8411)
411	Standard	46	Tin (S8201)

All dimensions in mm.

www.harwin.com



SMT Coin Cell Holder

Battery retainer for Ø20mm coin cell

- ❖ Horizontal designs are tape & reel packaged for auto placement.
- ❖ Highly effective retention of coin cell batteries.
- ❖ Eliminates the need for soldered-in cells.
- ❖ Vertical mount minimises PCB real estate usage.
- ❖ Low profile design available with dual independent contact points for enhanced electrical reliability
- ❖ Accommodates CR2032 and similar coin cell batteries.



LOW PROFILE

❖ Packaging

Format: Tape and Reel
Reel quantity: 1,000 on a Ø330mm reel

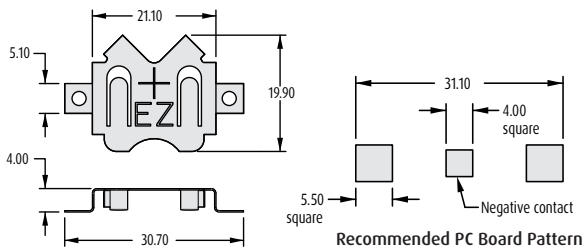

STANDARD

❖ Packaging

Format: Tape and Reel
Reel quantity: 500 on a Ø330mm reel

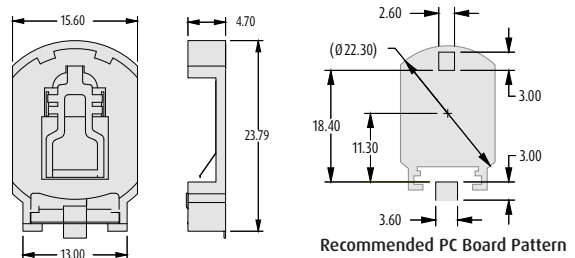

VERTICAL

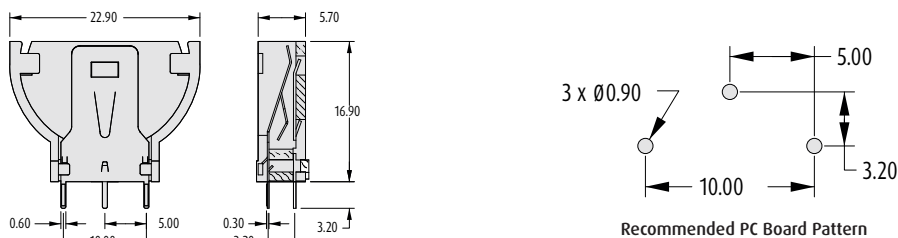

HOW TO ORDER

SERIES CODE

S8 XXX - XX R

PACKAGING

R Tape & Reeled

TYPE

201	Low Profile
411	Standard
401	Vertical

FINISH

45	Gold (S8411)	PG
46	Tin (S8201, S8401)	PG

All dimensions in mm.

www.harwin.com

