

# RIG-Lok



**Commanding the Global Market**

## FEATURES

- Ruggedized over-molded coupling nut
- Wire gages 4/0 awg through 777 MCM
- Utilizes patented Radsok Technology
- 1/4 Turn Reverse Bayonet
- Crimp or Busbar Termination
- Silver Plated Contacts
- Finger Proof
- Current: 800Amp
- Voltage: DC 2500V
- Operating Temperature: -40°C to +125°C
- 2000 Mating Cycles
- 300 Day Salt Spray Rating



## BENEFITS

- Quick positive coupling
- Vibration resistant
- Audible, tactile and visual indication of full coupling
- Environmental Applications
- High Amperage Applications
- Easily Adaptable
- Better Conductivity where needed
- Allows conductor size change
- Hardware options include plugs, inline receptacle, and panel mount receptacles



**Target Audiences:**  
 Oilfield Equipment  
 Manufacturers, Power  
 Generation OEM's,  
 Power Distribution  
 Panel Suppliers,  
 Traction Motor OEM's

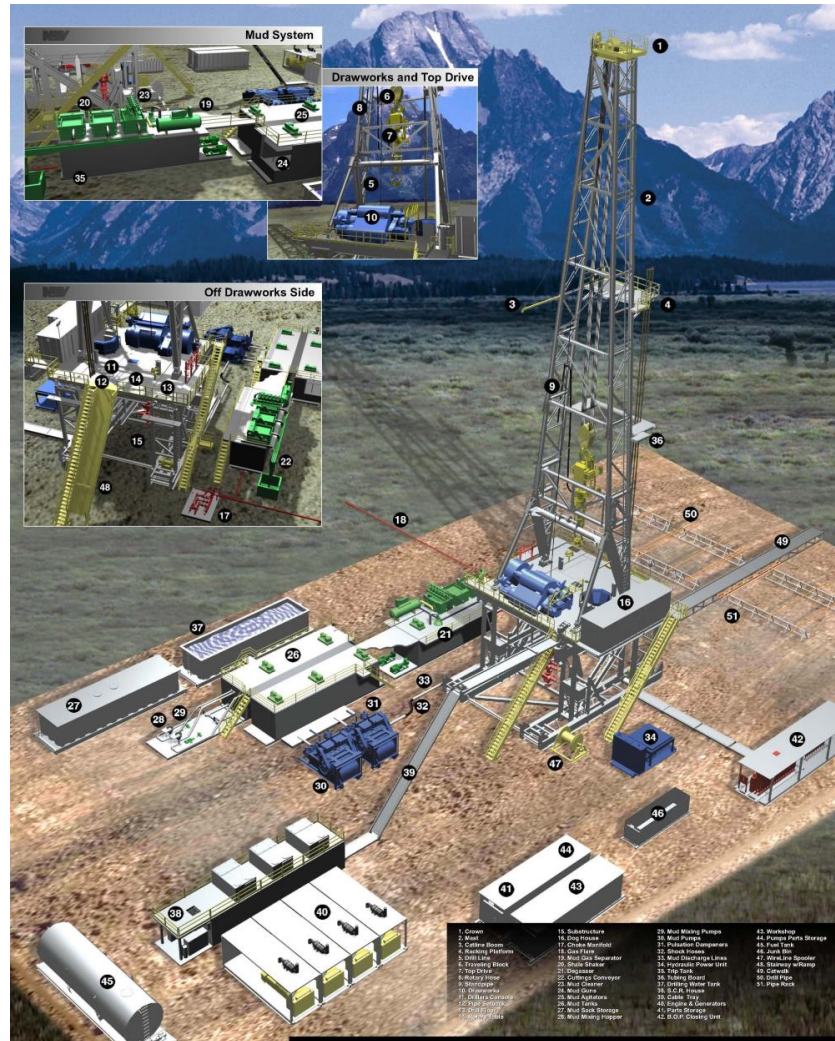

## Specific Applications:

1. VFD Drive Buildings,  
Land Drilling  
Equipment
2. Traction Motors
3. Top Drive Power  
distribution



**Commanding the Global Market**

## RIG-Lok Product DataSheet

IDS-64

**Amphenol®**



**RIG-Lok**

Amphenol, which has been manufacturing connectors for more than 75 years, offers an extensive array of connector lines including rectangular, circular, fiber optic, EMI/EMP filter and a variety of special application connectors.

With the introduction of its patented RADSOK technology, Amphenol Industrial Operations (AIO) revolutionized the connector industry. RADSOK'S twisted grid configuration allows for 50% more current to pass through the same size pin, while providing increased reliability, ampacity and cycle durability as well as lower insertion force, T-rise and voltage drop.

**Features**

- Ruggedized over-molded coupling nut
- Wire gauges 4/0 awg through 777 MCM
- Utilizes patented Radsok Technology
- 1/4 Turn Reverse Bayonet
- Crimp or Busbar Termination
- Silver Plated Contacts
- Finger Proof
- Current: 800Amp
- Voltage: DC 2500V
- Operating Temperature: -40°C to +125°C
- 2000 Mating Cycles
- 300 Day Salt Spray Rating

[www.amphenol-industrial.com](http://www.amphenol-industrial.com)



Example Plug Part Number: V-06G-E-M50-7-N-BL

Example Receptacle Part Number: V-03B-E-N-BL

V = Vortex GT Connector

- |     |      |  |
|-----|------|--|
| 1 = | 06G  | Plug with Crimp Socket Contact                   |
|     | 03C  | Receptacle with Crimp Pin Contact                |
|     | 03B  | Receptacle with 2 Hole Busbar Pin Contact        |
|     | 01C  | Inline Receptacle with Crimp Pin Contact         |
| 2 = | Omit | No Protective Cap                                |
|     | E    | Protective Cap                                   |
| 3 = | Omit | Plug or Receptacle Without Rear Hardware         |
|     | M40  | Metric M40 Cable Adapter With Gland .748-1.102"  |
|     | M50  | Metric M50 Cable Adapter With Gland 1.063-1.378" |
|     | M63  | Metric M50 Cable Adapter With Gland 1.339-1.772" |
| 4 = | Omit | Threaded or 2 Hole Busbar Receptacles            |
|     | 1    | 120 mm sq and 4/0awg crimp wire well             |
|     | 2    | 150 mm sq and 262MCM crimp wire well             |
|     | 3    | 185 mm sq and 313MCM crimp wire well             |
|     | 4    | 200 mm sq and 373MCM crimp wire well             |
|     | 5    | 240 mm sq and 444MCM crimp wire well             |
|     | 6    | 535 MCM crimp wire well                          |
|     | 7    | 646 MCM crimp wire well                          |
|     | 8    | 777 MCM crimp wire well                          |

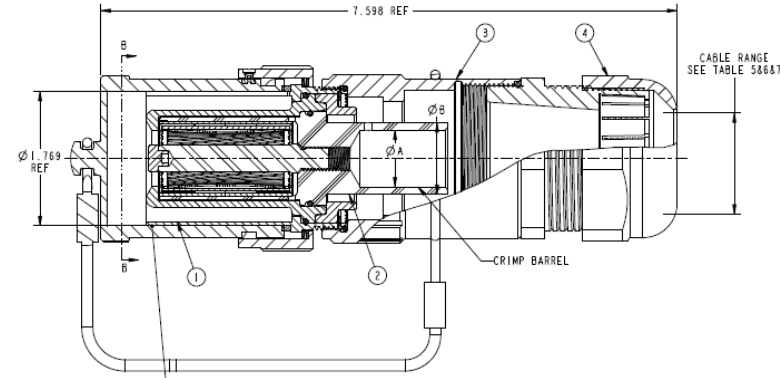
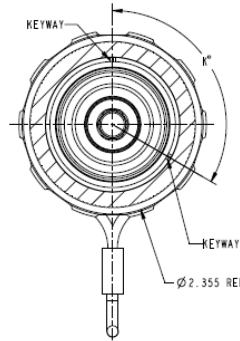

- |     |      |   |
|-----|------|---|
| 5 = | N    | 180° Normal Rotation, Keyed Receptacle Shell and Slotted Plug     |
|     | J    | 360° Rotation, No Keyways   |
|     | W    | 120° Alternate Rotation, Keyed Receptacle Shell and Slotted Plug  |
|     | X    | 90° Alternate Rotation, Keyed Receptacle Shell and Slotted Plug   |
|     | Y    | 210° Alternate Rotation, Keyed Receptacle Shell and Slotted Plug  |
| 6 = | Omit | No Color Coded Powdercoating                                      |
|     | BL   | Blue Powdercoat for DC Voltage                                    |
|     | OR   | Orange Powdercoat for DC Voltage                                  |
|     | Y    | Yellow Powdercoat for DC Voltage                                  |
|     | BR   | Brown Powdercoat for DC Voltage                                   |
|     | R    | Red Powdercoat for AC Voltage                                     |
|     | W    | White Powdercoat for AC Voltage                                   |
|     | BK   | Black Powdercoat for AC Voltage                                   |
|     | G    | Green Powdercoat for AC Voltage                                   |
| 7 = | **** | Modification - Please Consult the factory for additional options. |

