



N

## LATCHING

## TRANSFER

SWITCH

Page  
1 / 2

OPTIONS: INDICATOR

FREQUENCY RANGE  
IMPEDANCE

: 0 - 12.4 GHz

: 50 Ohms

FREQUENCY (GHz)	0 - 1	1 - 2	2 - 3	3 - 8	8 - 12.4
V.S.W.R ≤	1.15	1.20	1.25	1.35	1.50
INSERT. LOSS ≤	0.15 dB	0.20 dB	0.25 dB	0.35 dB	0.50 dB
ISOLATION ≥	85 dB	80 dB	75 dB	70 dB	60 dB
AVER. POWER (*)	700 W	500 W	400 W	250 W	200 W

ACTUATOR  
NOMINAL CURRENT AT 25° C (±10%)  
ACTUATOR VOLTAGE (Vcc)  
TERMINALS  
INDICATOR RATING

: LATCHING

: 125 mA

: 28V (24 to 30V) /NEGATIVE COMMON

```
: solder pins (250 Deg.C max./30 sec)
```

: 1 W / 30 V / 100 mA

CONNECTORS  
LIFE  
SWITCHING TIME (nominal voltage; 25°C)  
CONSTRUCTION  
WEIGHT

: N female per MIL C 39012

```
: 2.500.000 cycles
```

: < 15 ms

```
: splashproof
```

: < 215 g

OPERATING TEMPERATURE RANGE (°C) : -40 , +85  
STORAGE TEMPERATURE RANGE (°C) : -55 , +85

OPERATING TEMPERATURE RANGE (°C) : -40 . +85

STORAGE TEMPERATURE RANGE (°C) : -55 , +85

(\* : average power at 25° C)

# DRAWING

General tolerance: ± 0,5 mm

# R577.143.002

Page  
2/2

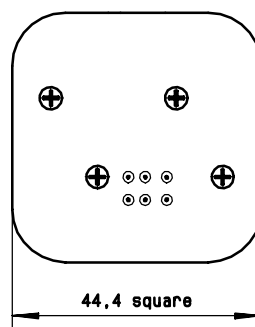
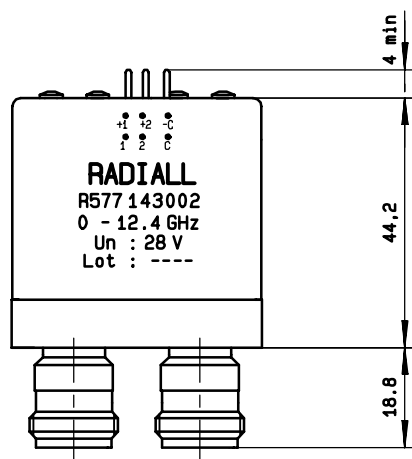
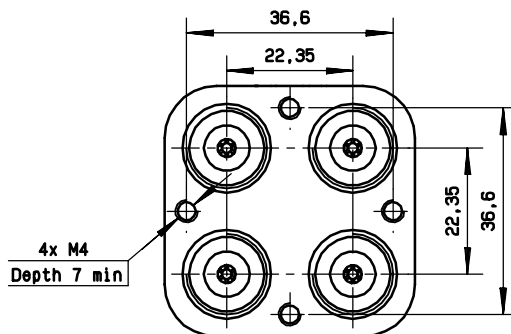
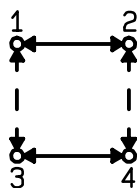

# SCHEMATIC DIAGRAM

Voltage	RF continuity	Indicator
- C + 1	1↔3 2↔4	C . 1
- C + 2	1↔2 3↔4	C . 2

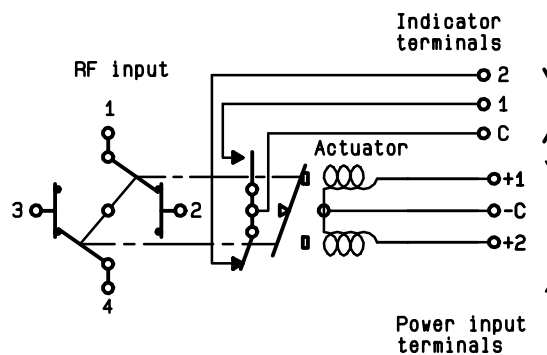

ISSUE 22. jan.08

# Mouser Electronics

Authorized Distributor

Click to View Pricing, Inventory, Delivery & Lifecycle Information:

Radial:

[R577143002](#)