

FIT68-4

Description:

The FIT68-4 toroidal inductor is specifically designed to minimize transients. It stores energy and therefore, conditions the output signal by leveling the current waveform providing a more stable current supply. Generally used in high frequency circuits, its standard design provides an economical solution in differential mode applications or as an output inductor.

Electrical Specifications (@25C):

| Min. Inductance (μH) | | Rated | Max |
|----------------------|---------|---------|----------|
| No Bias | At Bias | DC Amps | DCR (mΩ) |
| 43.30 | 26.63 | 4.8 | 42.4 |

Note: No Bias inductance measured at .25V, 10KHZ.

Dimensions:

| A | B | C | D | E | F | G |
|------|------|------|------|------|------|-----------|
| .875 | .475 | .950 | .300 | .474 | .125 | .028±.003 |

Units: In inches

Weight: .026 lbs.

Technical Notes:

1. Nominal inductance values are typically 10% higher than minimal rating.
2. Biased inductance measured at rated DC amps.
3. Operation at rated current yields approximately 40°C temperature rise over 20°C ambient.

RoHS Compliance: As of manufacturing date February 2005, all standard products meet the requirements of 2002/95/EC, known as the RoHS initiative.

* Upon printing, this document is considered "uncontrolled". Please contact Triad Magnetics' website for the most current version.

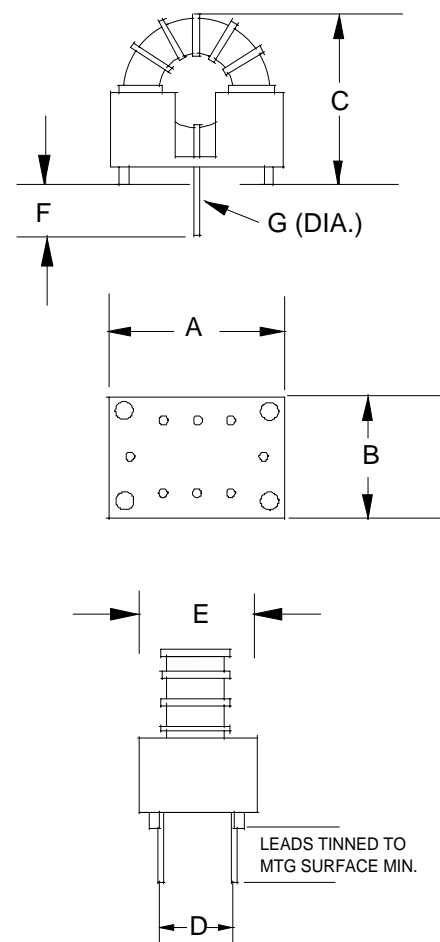

Mouser Electronics

Authorized Distributor

Click to View Pricing, Inventory, Delivery & Lifecycle Information:

[Triad Magnetics:](#)

[FIT68-4](#)