

# M1920

## 19" Fanless Intel® Medical Station



### Features

- Fanless Design
- Applicable for Clinical Station, Nursing and PACS
- Soldered Onboard Intel® Core™ i7-2610UE or Celeron® 827E Processor
- 19 inch LCD with Resistive Touch
- EN60601-1, EN60601-1-2, UL60601-1 Certified
- Streamline Appearance - 59mm in Thickness
- Multi-connectivity (Bluetooth, WLAN and GbE)
- RFID Reader, 5.0 Megapixel Camera, Dual Smartcard Readers, RF Keyboard and Slim DVD-RW
- Optional Alternative of External Battery or PCIe x16 Expansion Box
- Isolated Serial Ports, USB and LAN Ports
- Multi-expansion (3 x RS-232, 4 x USB, 2 x LAN, 1 x Displayport and 1 x SD Card)
- Intel® SSD Compatible

### System

|                            |  |
|----------------------------|--|
| <b>CPU</b>                 | Intel® Core™ i7-2610UE 1.5 GHz processor<br>Intel® Celeron® 827E 1.4 GHz processor       |
| <b>Graphics Controller</b> | Intel® HD Graphics 3000  |
| <b>Memory</b>              | 4GB DDR3 SO-DIMM memory module installed   |
| <b>Chipset</b>             | Intel® QM67 for i7-2610UE<br>Intel® HM65 for 827E  |
| <b>Storage</b>             | 32GB mSATA SSD installed<br>2.5" 320GB SATA HDD (optional)<br>Intel® 40GB SSD (optional) |

### Peripherals and Devices

|                          |  |
|--------------------------|--|
| <b>Camera</b>            | Integrated 5.0 megapixel CMOS camera with auto-focus (optional)              |
| <b>RFID</b>              | 13.56MHz RFID reader with ISO 14443A/14443B/15693 support (optional)         |
| <b>Wi-Fi</b>             | Integrated Intel® Centrino® Advanced-N 6205 802.11 a/b/g/n                   |
| <b>Bluetooth</b>         | Integrated Bluetooth 2.1 + EDR   |
| <b>RF Keyboard</b>       | Integrated RF Keyboard (optional)  |
| <b>DVD-RW</b>            | Integrated Slim DVD-RW (optional)  |
| <b>Docking Bay</b>       | For the alternative of External Battery or PCIe x16 Expansion box (optional) |
| <b>SD Card</b>           | 1 x SD/SDHC slot   |
| <b>Smart Card Reader</b> | Dual Smart Card Reader slots   |

### I/O interface

|                     |   |
|---------------------|---|
| <b>Audio</b>        | 1 x Integrated microphone, 2 x Integrated 3W speakers<br>1 x Mic-in, 1 x Line-out |
| <b>Video output</b> | 1 x displayport   |
| <b>Video input</b>  | 1 x SDI connector (optional)  |
| <b>LAN</b>          | 2 x RJ45 connectors for GbE LAN with 4KV isolation                                |
| <b>Serial Port</b>  | 2 x RS-232 port with 4KV isolation<br>1 x RS-232/422/485 with 4KV isolation       |
| <b>USB Port</b>     | 4 x USB 2.0 ports<br>1 x USB 2.0 port with 4KV isolation (on the top)             |

### Button & Indicator

|               |  |
|---------------|--|
| <b>Button</b> | 1 x Power on/off button<br>1 x Menu button<br>1 x Touch and LCD on/off button<br>1 x Brightness up button<br>1 x Brightness down button<br>1 x Volume up button<br>1 x Volume down button<br>1 x Programmable button |
|---------------|--|

### LCD Display

|                             |                                      |
|-----------------------------|--------------------------------------|
| <b>Size/Type</b>            | 19" TFT Active Matrix Panel          |
| <b>Max. Resolution</b>      | 1280 x 1024 (SXGA) with 16.7M colors |
| <b>Luminance</b>            | 350 cd/m <sup>2</sup> (typ.)         |
| <b>Contrast Ratio</b>       | 1000:1 (typ.)                        |
| <b>View Angle (U/D/R/L)</b> | 80°/80°/85°/85°                      |
| <b>Backlight Type</b>       | LED                                  |

### Touch Screen

|                             |                        |
|-----------------------------|------------------------|
| <b>Type</b>                 | Analog Resistive Touch |
| <b>Light Transparency</b>   | 80% (typ.)             |
| <b>Controller Interface</b> | USB interface          |

### Power Requirement

|                       |  |
|-----------------------|--|
| <b>Adapter Input</b>  | 100 ~ 240 VAC (Full Range)               |
| <b>Adapter Output</b> | DC 18V, 5A, 90W with medical certificate |

### Mechanical & Environmental

|                               |   |
|-------------------------------|---|
| <b>Operating Temp.</b>        | 0 ~ 40°C (32 ~ 104°F)                           |
| <b>Storage Temp.</b>          | -20 ~ 60°C (-4 ~ 140°F)                         |
| <b>Operating Humidity</b>     | 10 ~ 95% @ 40°C (non-condensing)                |
| <b>Dimensions (W x D x H)</b> | 399.4 x 459.5 x 59 mm (15.72" x 18.09" x 2.32") |
| <b>Net Weight</b>             | 7.5 kg (16.53 lb)                               |

|                   |  |
|-------------------|--|
| <b>Regulatory</b> | CE, FCC Class B<br>EN60601-1, EN60601-1-2, UL60601-1 certified |
|-------------------|--|

|                             |   |
|-----------------------------|---|
| <b>IP Rating</b>            | IP-65 (front) and IP-42 in others         |
| <b>Vibration</b>            | 5 ~ 500Hz, 1G random operation (SSD only) |
| <b>Shock</b>                | 10G peak (11m/sec)                        |
| <b>Operational Altitude</b> | below 2000m                               |

### OS Support

Windows 8 Embedded / Windows 8 Professional  
Windows 7 Embedded / Windows 7 Professional  
Windows XP Embedded / Windows XP Professional  
Ubuntu and Fedora Linux compliant

### Ordering Information

|                     |  |
|---------------------|--|
| <b>M1920-2610UE</b> | 19" Fanless Intel® Core™ i7-2610UE Medical Station with WiFi and Bluetooth |
| <b>M1920-827E</b>   | 19" Fanless Intel® Celeron® 827E Medical Station with WiFi and Bluetooth   |

All specifications are subject to change without notice.

# M1920

## 19" Fanless Intel® Medical Station

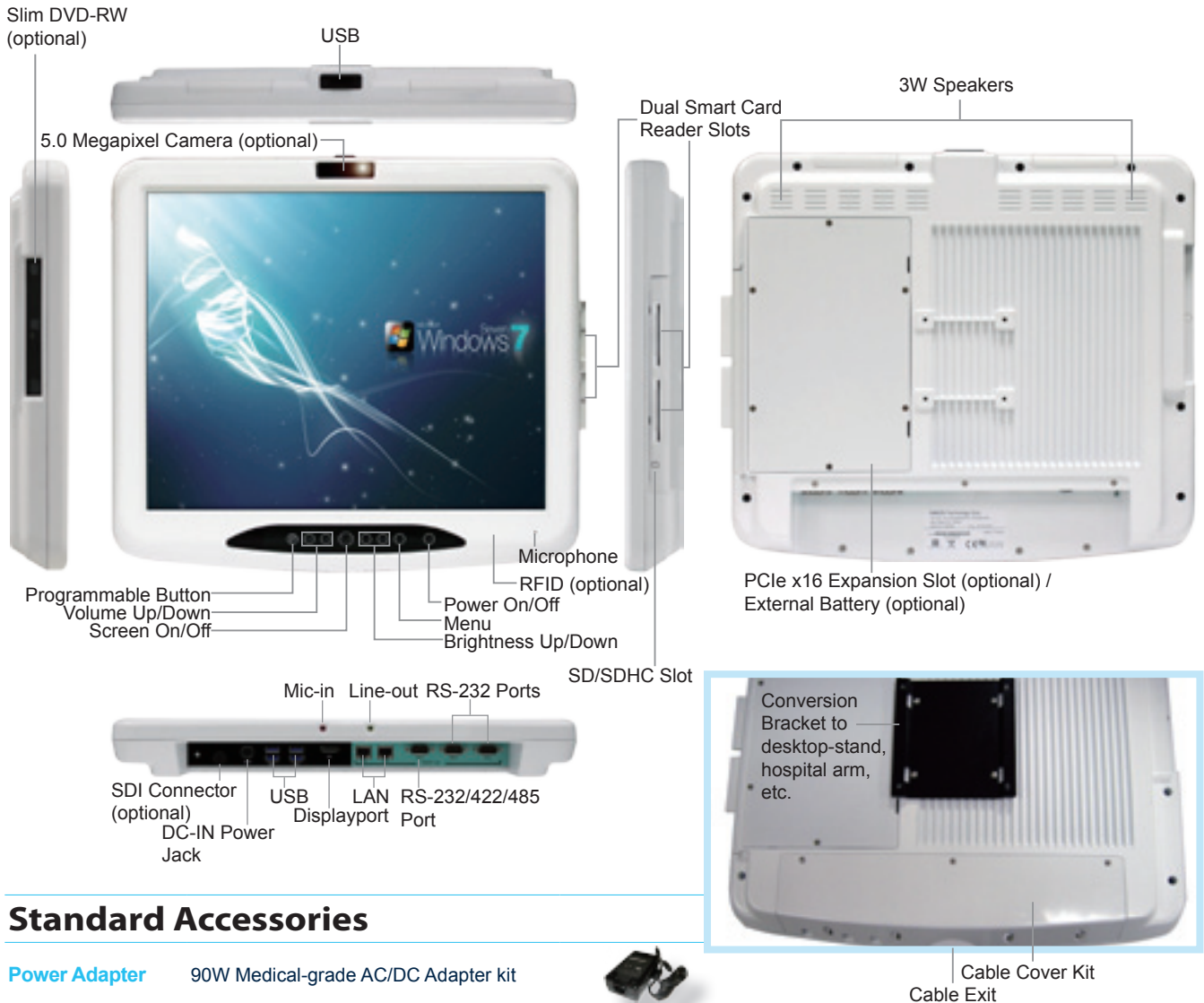

### Standard Accessories

**Power Adapter** 90W Medical-grade AC/DC Adapter kit



### Optional Accessories

**ARM Kits** See pages 28 and 29.

### Optional Configuration (CTOS\* Kit)

**RFKB-1858** RF Keyboard remoter and module



**RFID-1920** RFID module kit



**CAM-1920** 5.0MP CMOS Camera module kit



**DVDRW-1920** Slim DVD-RW Drive module kit



**HDD-1920** 2.5-inch 320GB HDD kit



**SSD-25040** Intel® 2.5" 40GB SATAII SSD kit



**eBAT-1920** 9-cell External Battery kit



**eEXP-1920** PCIe x16 Expansion module kit



\*CTOS means *Configure-to-Order Service*.

All specifications are subject to change without notice.

# Mouser Electronics

Authorized Distributor

Click to View Pricing, Inventory, Delivery & Lifecycle Information:

[ARBOR Technology:](#)

[M1920-2610UE](#)