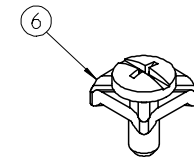
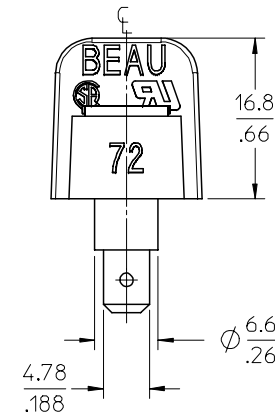
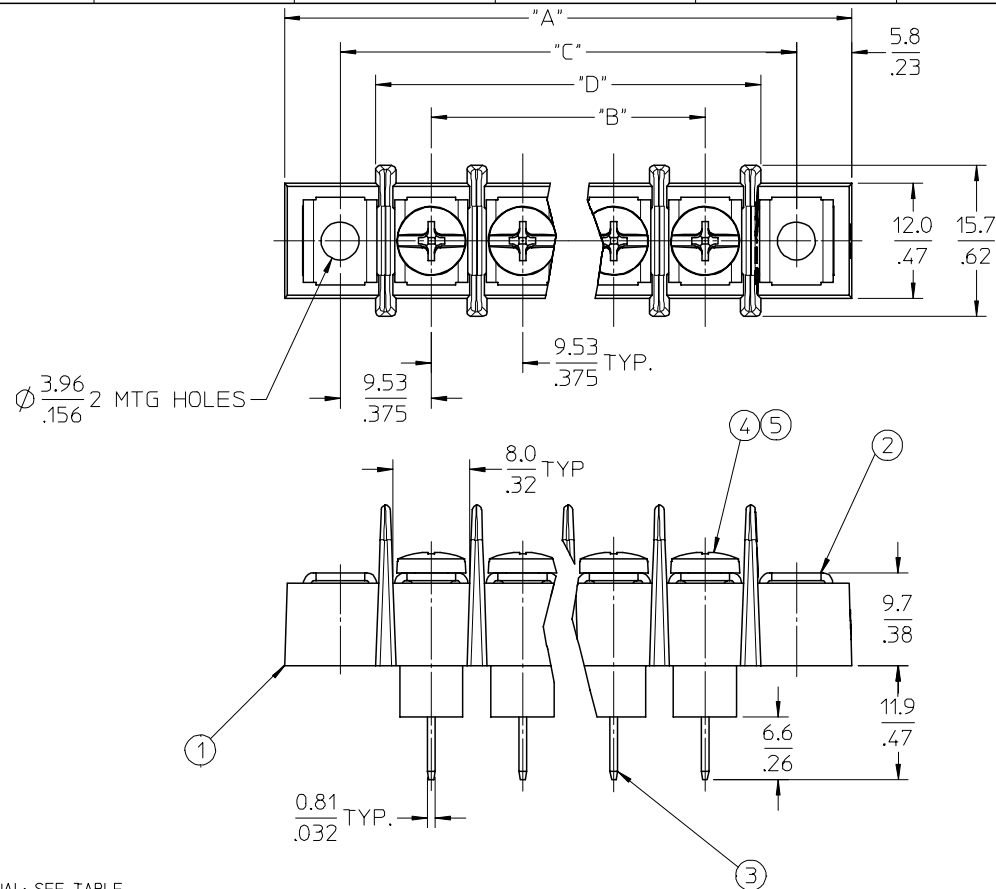

4 CIRCUIT SHOWN

REF. -50 OPT. SCREW
(WHERE APPLICABLE)

NOTES:

1. MATERIAL: SEE TABLE
2. FINISHES: SEE TABLE
3. PRODUCT SPECIFICATION: NOT REQUIRED
4. PACKAGING: NOT REQUIRED
5. MATES WITH: N/A
6. "XX" REFERS TO THE QUANTITY OF CIRCUITS.

6	XX	SCREW&WASHER, #6-32X.250 PAN, PH-SL, -50	STEEL	ZN, CLEAR CHROMATE
5	XX	SCREW, #6-32X.250 BHD, PHIL-SLOT, -49	BRASS	NICKEL PLATE
4	XX	SCREW, #6-32X.250 BHD, PHIL-SLOT (STD)	STEEL	ZN, CLEAR CHROMATE
3	XX	TERMINAL, FAST TAB, STYLE 9, SN/B	BRASS	TIN PLATE
2	2	PLATE, MOUNTING, NI	BRASS	NICKEL PLATE
1	1	INSULATOR, 9.53MM, SR BTS, INSUL. BASE	PBT, 30% GF	BLACK
ITEM	QTY.	DESCRIPTION	MATERIAL	FINISH

RELEASED	EC NO: ETC2006-0262	2006/02/20	2006/02/21
DRWN:CYORK	CHKD:RDEROSS	APPR:RDEROSS	2006/02/16
REV	A	DESCRIPTION	

QUALITY SYMBOLS
▽=0
▽=0

GENERAL TOLERANCES (UNLESS SPECIFIED)		
	mm	INCH
4 PLACES	± ---	±.0002
3 PLACES	± 0.005	±.005
2 PLACES	± 0.13	±.01
1 PLACE	± 0.25	± ---
ANGULAR ± 1 °		
DRAFT WHERE APPLICABLE MUST REMAIN WITHIN DIMENSIONS		

DIMENSION STYLE	MM/IN
DRAWN BY	DATE
C. YORK	2006/02/16
CHECKED BY	DATE
RDEROSS	2006/02/16
APPROVED BY	DATE
RDEROSS	2006/02/16
MATERIAL NO.	
SEE SHEET 2	
SIZE	B

SCALE	2:1
DESIGN UNITS	INCH
THIRD ANGLE PROJECTION	
9.53 [.375] SR BTS ASY, INSUL. FT, W/MTG	
MOLEX INCORPORATED	
DOCUMENT NO.	SD-38721-002
SHEET NO.	1 OF 2
THIS DRAWING CONTAINS INFORMATION THAT IS PROPRIETARY TO MOLEX INCORPORATED AND SHOULD NOT BE USED WITHOUT WRITTEN PERMISSION	

	10	9	8	7	6	5	4	3	2	38721																																																																																																																																																																																																																																																																																																																																																		
F										F																																																																																																																																																																																																																																																																																																																																																		
E										E																																																																																																																																																																																																																																																																																																																																																		
D										D																																																																																																																																																																																																																																																																																																																																																		
C										C																																																																																																																																																																																																																																																																																																																																																		
B										B																																																																																																																																																																																																																																																																																																																																																		
A										A																																																																																																																																																																																																																																																																																																																																																		
<table><tr><td rowspan="10">NUMBER OF CIRCUITS "XX"</td><td rowspan="10">DIM. "A"</td><td rowspan="10">DIM. "B"</td><td rowspan="10">DIM. "C"</td><td rowspan="10">DIM. "D"</td><td rowspan="10">ASSEMBLY MATERIAL NO. (STD)</td><td rowspan="10">ASSEMBLY MATERIAL NO. (OPT -49)</td><td rowspan="10">ASSEMBLY MATERIAL NO. (OPT -50)</td><td colspan="3"></td></tr><tr><td colspan="3"></td></tr><tr><td colspan="3"></td></tr><tr><td colspan="3"></td></tr><tr><td colspan="3"></td></tr><tr><td colspan="3"></td></tr><tr><td colspan="3"></td></tr><tr><td colspan="3"></td></tr><tr><td colspan="3"></td></tr><tr><td colspan="3"></td></tr><tr><td>02</td><td>40.2</td><td>[1.58]</td><td>9.53</td><td>[.375]</td><td>28.58</td><td>[1.125]</td><td>21.1</td><td>[.83]</td><td>387216702</td><td>387217002</td><td>387217302</td></tr><tr><td>03</td><td>49.7</td><td>[1.96]</td><td>19.05</td><td>[.750]</td><td>38.10</td><td>[1.500]</td><td>30.7</td><td>[1.21]</td><td>387216703</td><td>387217003</td><td>387217303</td></tr><tr><td>04</td><td>59.2</td><td>[2.33]</td><td>28.58</td><td>[1.125]</td><td>47.63</td><td>[1.875]</td><td>40.2</td><td>[1.58]</td><td>387216704</td><td>387217004</td><td>387217304</td></tr><tr><td>05</td><td>68.7</td><td>[2.71]</td><td>38.10</td><td>[1.500]</td><td>57.15</td><td>[2.250]</td><td>49.7</td><td>[1.96]</td><td>387216705</td><td>387217005</td><td>387217305</td></tr><tr><td>06</td><td>78.3</td><td>[3.08]</td><td>47.63</td><td>[1.875]</td><td>66.68</td><td>[2.625]</td><td>59.2</td><td>[2.33]</td><td>387216706</td><td>387217006</td><td>387217306</td></tr><tr><td>07</td><td>87.8</td><td>[3.46]</td><td>57.15</td><td>[2.250]</td><td>76.20</td><td>[3.000]</td><td>68.8</td><td>[2.71]</td><td>387216707</td><td>387217007</td><td>387217307</td></tr><tr><td>08</td><td>97.3</td><td>[3.83]</td><td>66.68</td><td>[2.625]</td><td>85.73</td><td>[3.375]</td><td>78.3</td><td>[3.08]</td><td>387216708</td><td>387217008</td><td>387217308</td></tr><tr><td>09</td><td>106.8</td><td>[4.21]</td><td>76.20</td><td>[3.000]</td><td>95.25</td><td>[3.750]</td><td>87.8</td><td>[3.46]</td><td>387216709</td><td>387217009</td><td>387217309</td></tr><tr><td>10</td><td>116.4</td><td>[4.58]</td><td>85.73</td><td>[3.375]</td><td>104.78</td><td>[4.125]</td><td>97.3</td><td>[3.83]</td><td>387216710</td><td>387217010</td><td>387217310</td></tr><tr><td>11</td><td>125.9</td><td>[4.96]</td><td>95.25</td><td>[3.750]</td><td>114.30</td><td>[4.500]</td><td>106.9</td><td>[4.21]</td><td>387216711</td><td>387217011</td><td>387217311</td></tr><tr><td>12</td><td>135.4</td><td>[5.33]</td><td>104.78</td><td>[4.125]</td><td>123.83</td><td>[4.875]</td><td>116.4</td><td>[4.58]</td><td>387216712</td><td>387217012</td><td>387217312</td></tr><tr><td>13</td><td>144.9</td><td>[5.71]</td><td>114.30</td><td>[4.500]</td><td>133.35</td><td>[5.250]</td><td>125.9</td><td>[4.96]</td><td>387216713</td><td>387217013</td><td>387217313</td></tr><tr><td>14</td><td>154.5</td><td>[6.08]</td><td>123.83</td><td>[4.875]</td><td>142.88</td><td>[5.625]</td><td>135.4</td><td>[5.33]</td><td>387216714</td><td>387217014</td><td>387217314</td></tr><tr><td>15</td><td>164.0</td><td>[6.46]</td><td>133.35</td><td>[5.250]</td><td>152.40</td><td>[6.000]</td><td>145.0</td><td>[5.71]</td><td>387216715</td><td>387217015</td><td>387217315</td></tr><tr><td>16</td><td>173.5</td><td>[6.83]</td><td>142.88</td><td>[5.625]</td><td>161.93</td><td>[6.375]</td><td>154.5</td><td>[6.08]</td><td>387216716</td><td>387217016</td><td>387217316</td></tr><tr><td>17</td><td>183.0</td><td>[7.21]</td><td>152.40</td><td>[6.000]</td><td>171.45</td><td>[6.750]</td><td>164.0</td><td>[6.46]</td><td>387216717</td><td>387217017</td><td>387217317</td></tr><tr><td>18</td><td>192.6</td><td>[7.58]</td><td>161.93</td><td>[6.375]</td><td>180.98</td><td>[7.125]</td><td>173.5</td><td>[6.83]</td><td>387216718</td><td>387217018</td><td>387217318</td></tr><tr><td>19</td><td>202.1</td><td>[7.96]</td><td>171.45</td><td>[6.750]</td><td>190.50</td><td>[7.500]</td><td>183.1</td><td>[7.21]</td><td>387216719</td><td>387217019</td><td>387217319</td></tr><tr><td>20</td><td>211.6</td><td>[8.33]</td><td>180.98</td><td>[7.125]</td><td>200.03</td><td>[7.875]</td><td>192.6</td><td>[7.58]</td><td>387216720</td><td>387217020</td><td>387217320</td></tr><tr><td>21</td><td>221.1</td><td>[8.71]</td><td>190.50</td><td>[7.500]</td><td>209.55</td><td>[8.250]</td><td>202.1</td><td>[7.96]</td><td>387216721</td><td>387217021</td><td>387217321</td></tr><tr><td>22</td><td>230.7</td><td>[9.08]</td><td>200.03</td><td>[7.875]</td><td>219.08</td><td>[8.625]</td><td>211.6</td><td>[8.33]</td><td>387216722</td><td>387217022</td><td>387217322</td></tr><tr><td>23</td><td>240.2</td><td>[9.46]</td><td>209.55</td><td>[8.250]</td><td>228.60</td><td>[9.000]</td><td>221.2</td><td>[8.71]</td><td>387216723</td><td>387217023</td><td>387217323</td></tr><tr><td>24</td><td>249.7</td><td>[9.83]</td><td>219.08</td><td>[8.625]</td><td>238.13</td><td>[9.375]</td><td>230.7</td><td>[9.08]</td><td>387216724</td><td>387217024</td><td>387217324</td></tr><tr><td>25</td><td>259.2</td><td>[10.21]</td><td>228.60</td><td>[9.000]</td><td>247.65</td><td>[9.750]</td><td>240.2</td><td>[9.46]</td><td>387216725</td><td>387217025</td><td>387217325</td></tr><tr><td>26</td><td>268.8</td><td>[10.58]</td><td>238.13</td><td>[9.375]</td><td>257.18</td><td>[10.125]</td><td>249.7</td><td>[9.83]</td><td>387216726</td><td>387217026</td><td>387217326</td></tr></table>											NUMBER OF CIRCUITS "XX"	DIM. "A"	DIM. "B"	DIM. "C"	DIM. "D"	ASSEMBLY MATERIAL NO. (STD)	ASSEMBLY MATERIAL NO. (OPT -49)	ASSEMBLY MATERIAL NO. (OPT -50)																															02	40.2	[1.58]	9.53	[.375]	28.58	[1.125]	21.1	[.83]	387216702	387217002	387217302	03	49.7	[1.96]	19.05	[.750]	38.10	[1.500]	30.7	[1.21]	387216703	387217003	387217303	04	59.2	[2.33]	28.58	[1.125]	47.63	[1.875]	40.2	[1.58]	387216704	387217004	387217304	05	68.7	[2.71]	38.10	[1.500]	57.15	[2.250]	49.7	[1.96]	387216705	387217005	387217305	06	78.3	[3.08]	47.63	[1.875]	66.68	[2.625]	59.2	[2.33]	387216706	387217006	387217306	07	87.8	[3.46]	57.15	[2.250]	76.20	[3.000]	68.8	[2.71]	387216707	387217007	387217307	08	97.3	[3.83]	66.68	[2.625]	85.73	[3.375]	78.3	[3.08]	387216708	387217008	387217308	09	106.8	[4.21]	76.20	[3.000]	95.25	[3.750]	87.8	[3.46]	387216709	387217009	387217309	10	116.4	[4.58]	85.73	[3.375]	104.78	[4.125]	97.3	[3.83]	387216710	387217010	387217310	11	125.9	[4.96]	95.25	[3.750]	114.30	[4.500]	106.9	[4.21]	387216711	387217011	387217311	12	135.4	[5.33]	104.78	[4.125]	123.83	[4.875]	116.4	[4.58]	387216712	387217012	387217312	13	144.9	[5.71]	114.30	[4.500]	133.35	[5.250]	125.9	[4.96]	387216713	387217013	387217313	14	154.5	[6.08]	123.83	[4.875]	142.88	[5.625]	135.4	[5.33]	387216714	387217014	387217314	15	164.0	[6.46]	133.35	[5.250]	152.40	[6.000]	145.0	[5.71]	387216715	387217015	387217315	16	173.5	[6.83]	142.88	[5.625]	161.93	[6.375]	154.5	[6.08]	387216716	387217016	387217316	17	183.0	[7.21]	152.40	[6.000]	171.45	[6.750]	164.0	[6.46]	387216717	387217017	387217317	18	192.6	[7.58]	161.93	[6.375]	180.98	[7.125]	173.5	[6.83]	387216718	387217018	387217318	19	202.1	[7.96]	171.45	[6.750]	190.50	[7.500]	183.1	[7.21]	387216719	387217019	387217319	20	211.6	[8.33]	180.98	[7.125]	200.03	[7.875]	192.6	[7.58]	387216720	387217020	387217320	21	221.1	[8.71]	190.50	[7.500]	209.55	[8.250]	202.1	[7.96]	387216721	387217021	387217321	22	230.7	[9.08]	200.03	[7.875]	219.08	[8.625]	211.6	[8.33]	387216722	387217022	387217322	23	240.2	[9.46]	209.55	[8.250]	228.60	[9.000]	221.2	[8.71]	387216723	387217023	387217323	24	249.7	[9.83]	219.08	[8.625]	238.13	[9.375]	230.7	[9.08]	387216724	387217024	387217324	25	259.2	[10.21]	228.60	[9.000]	247.65	[9.750]	240.2	[9.46]	387216725	387217025	387217325	26	268.8	[10.58]	238.13	[9.375]	257.18	[10.125]	249.7	[9.83]	387216726	387217026	387217326
NUMBER OF CIRCUITS "XX"	DIM. "A"	DIM. "B"	DIM. "C"	DIM. "D"	ASSEMBLY MATERIAL NO. (STD)	ASSEMBLY MATERIAL NO. (OPT -49)	ASSEMBLY MATERIAL NO. (OPT -50)																																																																																																																																																																																																																																																																																																																																																					
02	40.2	[1.58]	9.53	[.375]	28.58	[1.125]	21.1	[.83]	387216702	387217002	387217302																																																																																																																																																																																																																																																																																																																																																	
03	49.7	[1.96]	19.05	[.750]	38.10	[1.500]	30.7	[1.21]	387216703	387217003	387217303																																																																																																																																																																																																																																																																																																																																																	
04	59.2	[2.33]	28.58	[1.125]	47.63	[1.875]	40.2	[1.58]	387216704	387217004	387217304																																																																																																																																																																																																																																																																																																																																																	
05	68.7	[2.71]	38.10	[1.500]	57.15	[2.250]	49.7	[1.96]	387216705	387217005	387217305																																																																																																																																																																																																																																																																																																																																																	
06	78.3	[3.08]	47.63	[1.875]	66.68	[2.625]	59.2	[2.33]	387216706	387217006	387217306																																																																																																																																																																																																																																																																																																																																																	
07	87.8	[3.46]	57.15	[2.250]	76.20	[3.000]	68.8	[2.71]	387216707	387217007	387217307																																																																																																																																																																																																																																																																																																																																																	
08	97.3	[3.83]	66.68	[2.625]	85.73	[3.375]	78.3	[3.08]	387216708	387217008	387217308																																																																																																																																																																																																																																																																																																																																																	
09	106.8	[4.21]	76.20	[3.000]	95.25	[3.750]	87.8	[3.46]	387216709	387217009	387217309																																																																																																																																																																																																																																																																																																																																																	
10	116.4	[4.58]	85.73	[3.375]	104.78	[4.125]	97.3	[3.83]	387216710	387217010	387217310																																																																																																																																																																																																																																																																																																																																																	
11	125.9	[4.96]	95.25	[3.750]	114.30	[4.500]	106.9	[4.21]	387216711	387217011	387217311																																																																																																																																																																																																																																																																																																																																																	
12	135.4	[5.33]	104.78	[4.125]	123.83	[4.875]	116.4	[4.58]	387216712	387217012	387217312																																																																																																																																																																																																																																																																																																																																																	
13	144.9	[5.71]	114.30	[4.500]	133.35	[5.250]	125.9	[4.96]	387216713	387217013	387217313																																																																																																																																																																																																																																																																																																																																																	
14	154.5	[6.08]	123.83	[4.875]	142.88	[5.625]	135.4	[5.33]	387216714	387217014	387217314																																																																																																																																																																																																																																																																																																																																																	
15	164.0	[6.46]	133.35	[5.250]	152.40	[6.000]	145.0	[5.71]	387216715	387217015	387217315																																																																																																																																																																																																																																																																																																																																																	
16	173.5	[6.83]	142.88	[5.625]	161.93	[6.375]	154.5	[6.08]	387216716	387217016	387217316																																																																																																																																																																																																																																																																																																																																																	
17	183.0	[7.21]	152.40	[6.000]	171.45	[6.750]	164.0	[6.46]	387216717	387217017	387217317																																																																																																																																																																																																																																																																																																																																																	
18	192.6	[7.58]	161.93	[6.375]	180.98	[7.125]	173.5	[6.83]	387216718	387217018	387217318																																																																																																																																																																																																																																																																																																																																																	
19	202.1	[7.96]	171.45	[6.750]	190.50	[7.500]	183.1	[7.21]	387216719	387217019	387217319																																																																																																																																																																																																																																																																																																																																																	
20	211.6	[8.33]	180.98	[7.125]	200.03	[7.875]	192.6	[7.58]	387216720	387217020	387217320																																																																																																																																																																																																																																																																																																																																																	
21	221.1	[8.71]	190.50	[7.500]	209.55	[8.250]	202.1	[7.96]	387216721	387217021	387217321																																																																																																																																																																																																																																																																																																																																																	
22	230.7	[9.08]	200.03	[7.875]	219.08	[8.625]	211.6	[8.33]	387216722	387217022	387217322																																																																																																																																																																																																																																																																																																																																																	
23	240.2	[9.46]	209.55	[8.250]	228.60	[9.000]	221.2	[8.71]	387216723	387217023	387217323																																																																																																																																																																																																																																																																																																																																																	
24	249.7	[9.83]	219.08	[8.625]	238.13	[9.375]	230.7	[9.08]	387216724	387217024	387217324																																																																																																																																																																																																																																																																																																																																																	
25	259.2	[10.21]	228.60	[9.000]	247.65	[9.750]	240.2	[9.46]	387216725	387217025	387217325																																																																																																																																																																																																																																																																																																																																																	
26	268.8	[10.58]	238.13	[9.375]	257.18	[10.125]	249.7	[9.83]	387216726	387217026	387217326																																																																																																																																																																																																																																																																																																																																																	
<table><tr><td rowspan="10">NOTES:</td><td colspan="10"></td></tr><tr><td colspan="10">1. INCH DIMENSIONS SHOWN IN BRACKETS [XX].</td></tr><tr><td colspan="10"></td></tr><tr><td colspan="10"></td></tr><tr><td colspan="10"></td></tr><tr><td colspan="10"></td></tr><tr><td colspan="10"></td></tr><tr><td colspan="10"></td></tr><tr><td colspan="10"></td></tr><tr><td colspan="10"></td></tr><tr><td rowspan="10">SEE SHEET 1 EC NO: ETC2006-0262 DRWN:CYORK 2006/02/20 CHKD:RDEROSS 2006/02/21 APPR:RDEROSS 2006/02/21</td><td rowspan="10">A</td><td rowspan="10">REV</td><td rowspan="10">QUALITY SYMBOLS ▽=0 ▽=0</td><td colspan="2">GENERAL TOLERANCES (UNLESS SPECIFIED)</td><td colspan="2">DIMENSION STYLE MM/IN</td><td>SCALE 1:1</td><td>DESIGN UNITS INCH</td><td>THIRD ANGLE PROJECTION</td></tr><tr><td>mm</td><td>INCH</td><td>DRAWN BY C. YORK</td><td>DATE 2006/02/16</td><td colspan="3">TITLE 9.53 [.375] SR BTS ASY, INSUL. FT, W/MTG</td></tr><tr><td colspan="2">4 PLACES ± --- ±.0002</td><td colspan="2">CHECKED BY RDEROSS</td><td colspan="2">DATE 2006/02/16</td><td colspan="2" rowspan="2">MOLEX INCORPORATED</td></tr><tr><td colspan="2">3 PLACES ± 0.005 ±.005</td><td colspan="2">APPROVED BY RDEROSS</td><td colspan="2">DATE 2006/02/16</td></tr><tr><td colspan="2">2 PLACES ± 0.13 ±.01</td><td colspan="2">MATERIAL NO. SEE CHART</td><td colspan="2">DOCUMENT NO. SD-38721-002</td><td colspan="2">SHEET NO. 2 OF 2</td></tr><tr><td colspan="2">1 PLACE ± 0.25 ± ---</td><td colspan="2">SIZE B</td><td colspan="2">THIS DRAWING CONTAINS INFORMATION THAT IS PROPRIETARY TO MOLEX INCORPORATED AND SHOULD NOT BE USED WITHOUT WRITTEN PERMISSION</td><td colspan="2"></td></tr><tr><td colspan="2">ANGULAR ± 1 °</td><td colspan="2">DRAFT WHERE APPLICABLE MUST REMAIN WITHIN DIMENSIONS</td><td colspan="2"></td><td colspan="2"></td></tr><tr><td colspan="2"></td><td colspan="2"></td><td colspan="2"></td><td colspan="2"></td></tr><tr><td colspan="2"></td><td colspan="2"></td><td colspan="2"></td><td colspan="2"></td></tr><tr><td colspan="2"></td><td colspan="2"></td><td colspan="2"></td><td colspan="2"></td></tr></table>											NOTES:											1. INCH DIMENSIONS SHOWN IN BRACKETS [XX].																																																																																										SEE SHEET 1 EC NO: ETC2006-0262 DRWN:CYORK 2006/02/20 CHKD:RDEROSS 2006/02/21 APPR:RDEROSS 2006/02/21	A	REV	QUALITY SYMBOLS ▽=0 ▽=0	GENERAL TOLERANCES (UNLESS SPECIFIED)		DIMENSION STYLE MM/IN		SCALE 1:1	DESIGN UNITS INCH	THIRD ANGLE PROJECTION	mm	INCH	DRAWN BY C. YORK	DATE 2006/02/16	TITLE 9.53 [.375] SR BTS ASY, INSUL. FT, W/MTG			4 PLACES ± --- ±.0002		CHECKED BY RDEROSS		DATE 2006/02/16		MOLEX INCORPORATED		3 PLACES ± 0.005 ±.005		APPROVED BY RDEROSS		DATE 2006/02/16		2 PLACES ± 0.13 ±.01		MATERIAL NO. SEE CHART		DOCUMENT NO. SD-38721-002		SHEET NO. 2 OF 2		1 PLACE ± 0.25 ± ---		SIZE B		THIS DRAWING CONTAINS INFORMATION THAT IS PROPRIETARY TO MOLEX INCORPORATED AND SHOULD NOT BE USED WITHOUT WRITTEN PERMISSION				ANGULAR ± 1 °		DRAFT WHERE APPLICABLE MUST REMAIN WITHIN DIMENSIONS																																																																																																																																																																																										
NOTES:																																																																																																																																																																																																																																																																																																																																																												
	1. INCH DIMENSIONS SHOWN IN BRACKETS [XX].																																																																																																																																																																																																																																																																																																																																																											
SEE SHEET 1 EC NO: ETC2006-0262 DRWN:CYORK 2006/02/20 CHKD:RDEROSS 2006/02/21 APPR:RDEROSS 2006/02/21	A	REV	QUALITY SYMBOLS ▽=0 ▽=0	GENERAL TOLERANCES (UNLESS SPECIFIED)		DIMENSION STYLE MM/IN		SCALE 1:1	DESIGN UNITS INCH	THIRD ANGLE PROJECTION																																																																																																																																																																																																																																																																																																																																																		
				mm	INCH	DRAWN BY C. YORK	DATE 2006/02/16	TITLE 9.53 [.375] SR BTS ASY, INSUL. FT, W/MTG																																																																																																																																																																																																																																																																																																																																																				
				4 PLACES ± --- ±.0002		CHECKED BY RDEROSS		DATE 2006/02/16		MOLEX INCORPORATED																																																																																																																																																																																																																																																																																																																																																		
				3 PLACES ± 0.005 ±.005		APPROVED BY RDEROSS		DATE 2006/02/16																																																																																																																																																																																																																																																																																																																																																				
				2 PLACES ± 0.13 ±.01		MATERIAL NO. SEE CHART		DOCUMENT NO. SD-38721-002		SHEET NO. 2 OF 2																																																																																																																																																																																																																																																																																																																																																		
				1 PLACE ± 0.25 ± ---		SIZE B		THIS DRAWING CONTAINS INFORMATION THAT IS PROPRIETARY TO MOLEX INCORPORATED AND SHOULD NOT BE USED WITHOUT WRITTEN PERMISSION																																																																																																																																																																																																																																																																																																																																																				
				ANGULAR ± 1 °		DRAFT WHERE APPLICABLE MUST REMAIN WITHIN DIMENSIONS																																																																																																																																																																																																																																																																																																																																																						
<table><tr><td>ib_frame_B_P_AM_T Rev. D 2005/12/08</td><td>9</td><td>8</td><td>7</td><td>6</td><td>5</td><td>4</td><td>3</td><td>2</td><td>1</td></tr></table>											ib_frame_B_P_AM_T Rev. D 2005/12/08	9	8	7	6	5	4	3	2	1																																																																																																																																																																																																																																																																																																																																								
ib_frame_B_P_AM_T Rev. D 2005/12/08	9	8	7	6	5	4	3	2	1																																																																																																																																																																																																																																																																																																																																																			

Mouser Electronics

Authorized Distributor

Click to View Pricing, Inventory, Delivery & Lifecycle Information:

Molex:

38721-6708