



Mallory Sonalert Products, Inc.

Part #:

MSE28LDD7

Sales Outline Drawing

Revision:

B

Specifications:

Sound Level Category	Loud
Mode of Operation	Ding Dong 4.3 - 3.4 kHz Double Shot
Voltage Rating	20 to 28 VDC
Frequency	4300-3400 Hz Typical
Loudness @ 1 FT	85 to 95 dB(A) Typ.
Current Draw	50mA MAX
Housing Material	Valox (UL94V-0), Color: Black
Storage Temperature	-40° to +80° C
Operating Temperature	-40° to +65° C
Weight (Typical)	4.0g
Options	Please contact factory.

Dimensions: Inches (mm)

ROHS Compliant

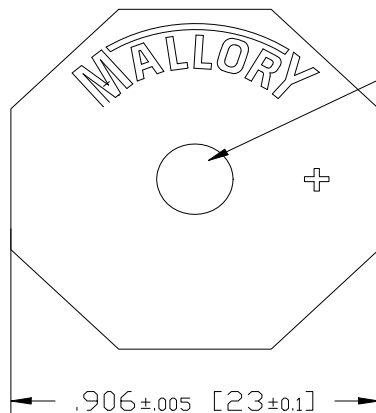

EMISSION HOLE
 $\varnothing .188 \pm .005$ [4.8±0.1]

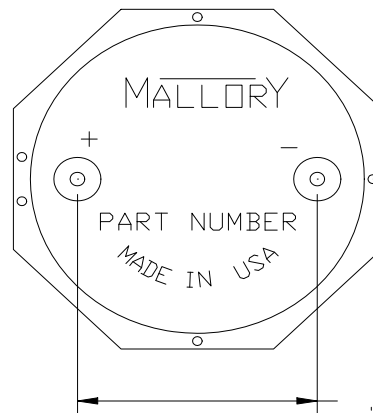

$.590 \pm .012$ [15±0.3]

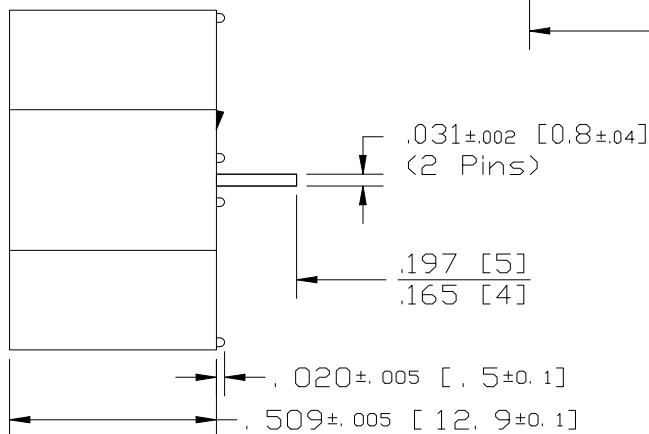

NOTE A:
TERMINALS - .031" DIA. NICKEL/TIN COATED BRASS.

NOTE B:
MOUNTING- INSERT INTO PRINTED CIRCUIT BOARD AND HAND OR MACHINE SOLDER.
UNITS ARE SUITABLE FOR WAVE SOLDERING. RECOMMENDED MAXIMUM TEMPERATURE
AND TIME DURATION FOR WAVE SOLDERING IS +270°C AND 3 SECONDS RESPECTIVELY.

Mouser Electronics

Authorized Distributor

Click to View Pricing, Inventory, Delivery & Lifecycle Information:

[Mallory Sonalert:](#)

[MSE28LDD7](#)