

MEGA®-FLEX Holder for MEGA® Fuses

RoHS



Specifications:

Max. Voltage Rating:	32 VDC
Max. Current Rating:	500A
Operating Temperature Range:	-40°C to +125°C
Wire Size:	70 - 8 mm ²
Recommended Fuse Installation Torque:	12 - 18Nm
Recommended Mounting (using M6 Screw/Washer):	5Nm
Base Material:	UL94V0 Glass-filled PPA
Cover Material:	UL94V0 Elastomer

The MEGA®-FLEX fuse holder is used with the MEGA® style bolt-down fuse, which is available up to 500A. This holder offers a flexible cover, which allows cable entry from virtually any direction, large wire size, and ring terminal stack up. Slots on the base allow holder to be mounted with tie wraps. Dovetail features allow you to interlock multiple MEGA®-FLEX fuse holders together for a high power distribution block. Bus bars are available for multiple holder applications.

Part Number	Description	Material (Studs and hardware)
02981028HXFCB	Base-only (No Hardware)	Zinc-Plated Steel
02981028HXFCC	Cover-only	-
02981028HXFC	Assembly	Zinc-Plated Steel
02981028HXFC-SS	Assembly	Stainless Steel
882-835-2	2-Position bus Bar	Tin-Plated Copper
882-835-3	3-Position bus Bar	Tin-Plated Copper
882-835-4	4-Position bus Bar	Tin-Plated Copper
882-835-5	5-Position bus Bar	Tin-Plated Copper

MEGA®-FLEX Holder for MEGA® Fuses

Dimensions in mm

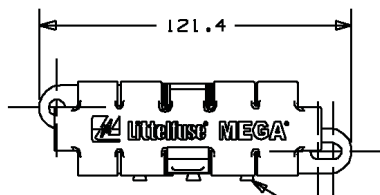

DOVETAIL FEATURES
USED TO INTERLOCK
MULTIPLE HOLDERS

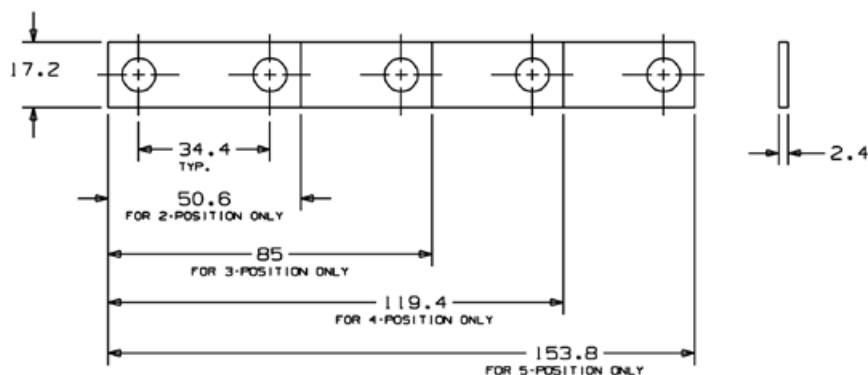
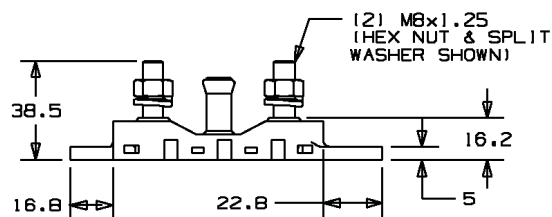
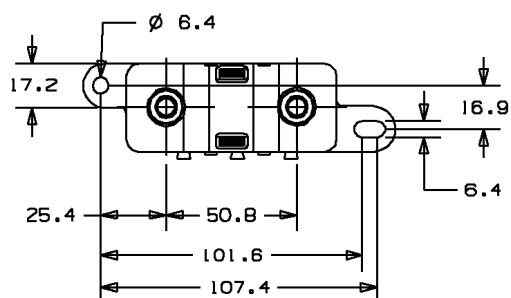
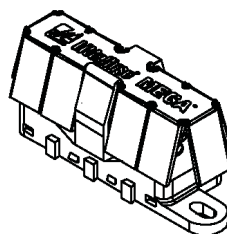
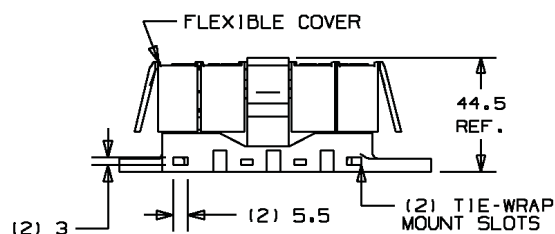
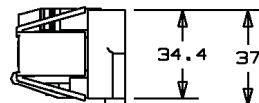

Mouser Electronics

Authorized Distributor

Click to View Pricing, Inventory, Delivery & Lifecycle Information:

[Littelfuse:](#)

[882-835-3](#)