

SECTION A-A
End View of Assembly

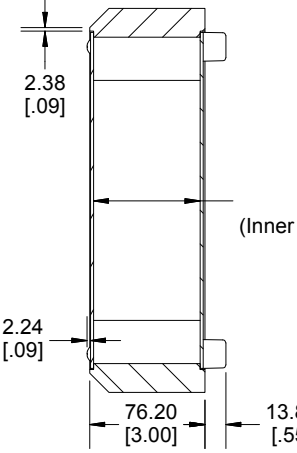

SECTION A-A
Without Optional Bottom Panel

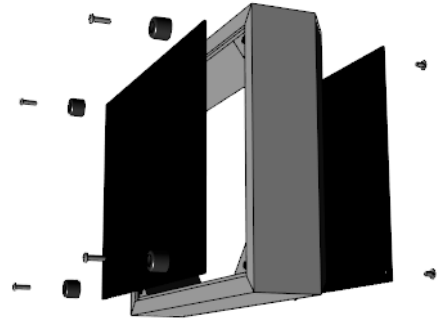
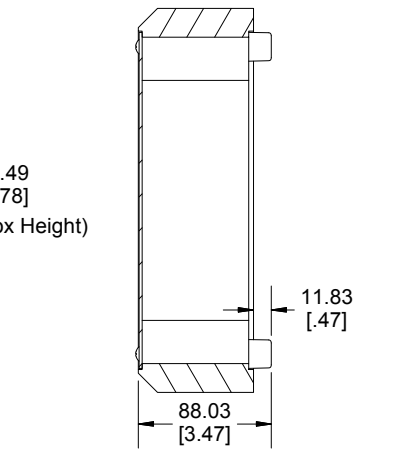

SECTION B-B
Side View of Assembly

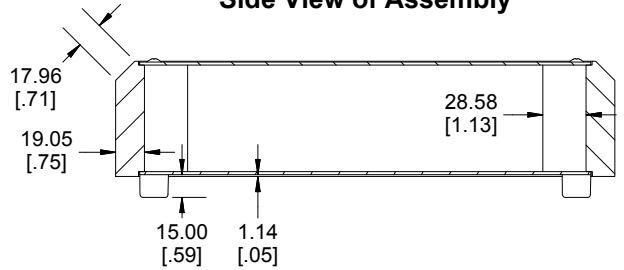

Top View of Frame

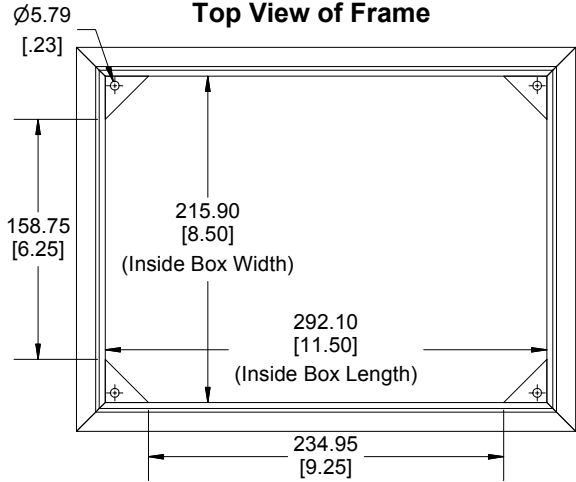

Aluminum Panel
(Top or Bottom)

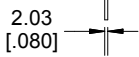
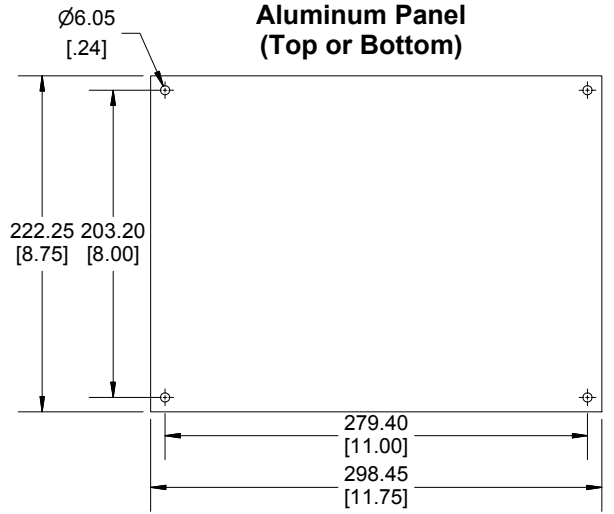

Enclosures can be Factory Modified (Milling, Drilling, Printing etc.)
Contact Factory mjm@hammondmfg.com for quotes
Solid models of this enclosure available in STEP or IGES.

NOTE
Chassis Includes Solid Walnut Frame, one (1) Aluminum Panel, Rubber Feet and Required Hardware
Aluminum Panels are Made of 0.080" Aluminum.

Screws should not be torqued past 4.43 lbf.in (50 cN.m)

| PART NUMBERS | |
|-----------------------------------|--------------|
| 13"x10" Enclosure | |
| Chassis with Natural Finish Panel | HWCHAS1310AL |
| Chassis with Satin Black Panel | HWCHAS1310BK |
| ACCESSORIES | |
| Natural Finish Panel | HW1310ALPL |
| Satin Black Panel | HW1310BKPL |

HAMMOND MANUFACTURING™
HWCHAS1310
www.hammondmfg.com

Dimensions:
mm
[inches]

Mouser Electronics

Authorized Distributor

Click to View Pricing, Inventory, Delivery & Lifecycle Information:

[Hammond:](#)

[HW1310ALPL](#) [HW1310BKPL](#) [HWCHAS1310AL](#) [HWCHAS1310BK](#)