

**Product number FN13323_STELLA-A**

Family	Stella	FWHM	Asymmetric degrees
Type	Pack	Efficiency	92 %
LED	VERO13	cd/Im	0.660
Color	Black	Gerber File	Available
Diameter	90 mm		
Height	22 mm		
Style	Round		
Optic Material	Silicone		
Holder Material	-		
Fastening	["screw"]		
Status	Production ready		

Product number FN14253_STELLA-A

Family	Stella	FWHM	Asymmetric degrees
Type	Pack	Efficiency	92 %
LED	VERO13	cd/Im	0.660
Color	White	Gerber File	Available
Diameter	90 mm		
Height	22 mm		
Style	Round		
Optic Material	Silicone		
Holder Material	-		
Fastening	""		
Status	Production ready		

NOTE: The typical divergence will be changed by different color, chip size and chip position tolerance. The typical total divergence is the full angle measured where the luminous intensity is half of the peak value.



PRODUCT DATASHEET

Stella series

last update 1/12/2016

GENERAL INFORMATION

- Product series especially designed & optimized for VERO13 series of LEDs.
- Special care taken to make light distribution as uniform as possible.

Note! Due to use of high power COB's with this product, special attention to proper thermal design is highly recommended. LEDiL has no liability for direct, indirect or consecutive damages arising from the LEDiL products being used outside of the recommended temperature range.

NOTE: Maximum recommended tightening torque for STELLA-FRAME is 0,4Nm

Front view

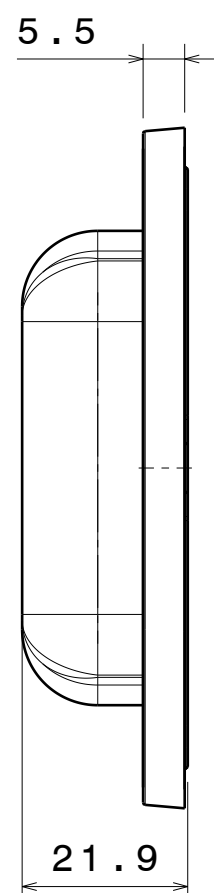
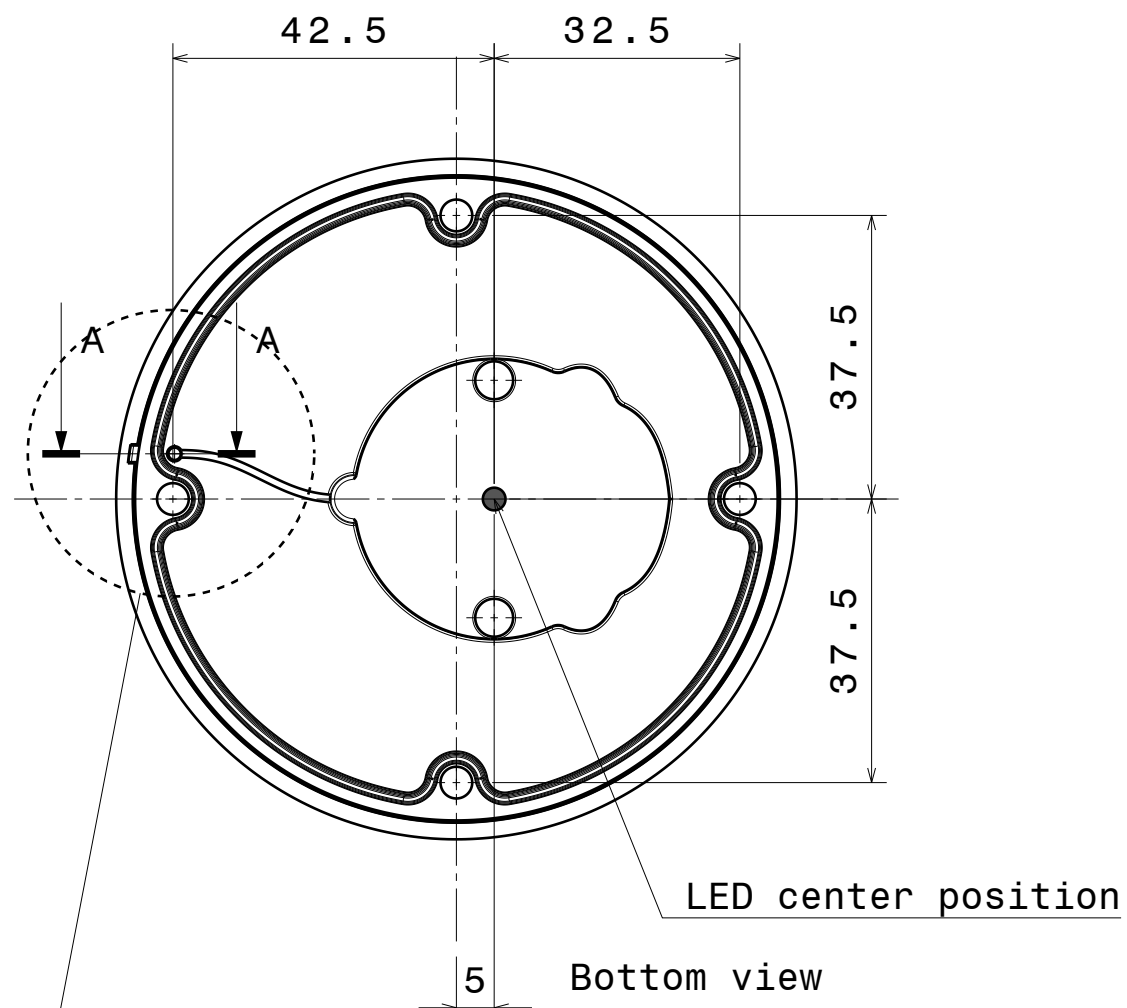

Top view

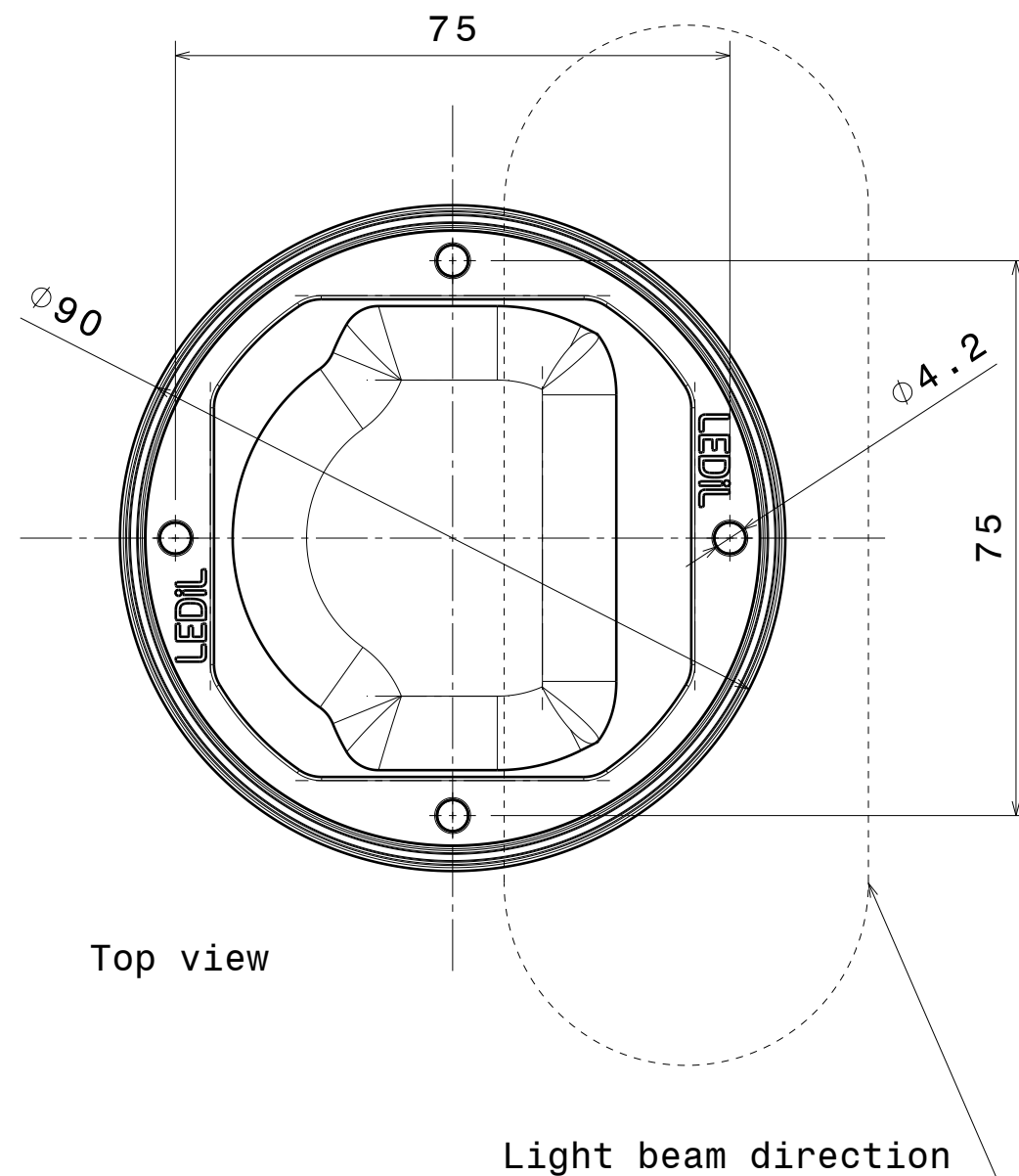

Isometric view



Section view A-A
Scale: 5:1

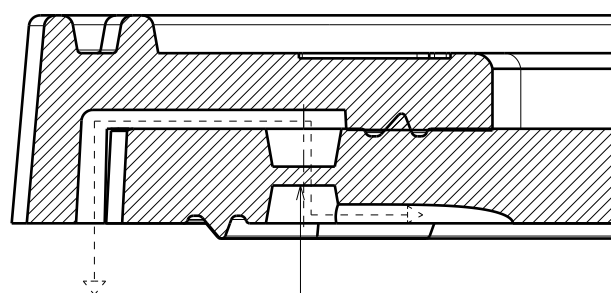

Lens material: Optical grade LSR
Frame material: PA, black

Tolerances if not otherwise shown
According to DIN ISO 2768-1
Linear measures: class V
Please note that due to the elasticity of
products made of silicone actual measured
values may vary, and therefore typical
tolerance values may not be applied.



Ledil Oy
Salorankatu 10
FIN 24240 SALO
Finland

THIRD ANGLE PROJECTION:



This drawing is the property of LEDiL Oy. It may not be reproduced, copied or communicated without a written agreement with LEDiL Oy."

	DRAWING TITLE
--	---------------

STELLA-A datasheet

SIZE

A3

PART NUMBER

FN13323

SCALE

1:1

1 | WEIGHT

(g)

SHEET

1 / 1

Luminaire: LEDiL Oy FN13323_STELLA-A Eff. 92%
Lamps: 1 x VERO13 (BXRC-30E4000F) 819lm@250mA CCT=3000K P=7.5W I=250mA

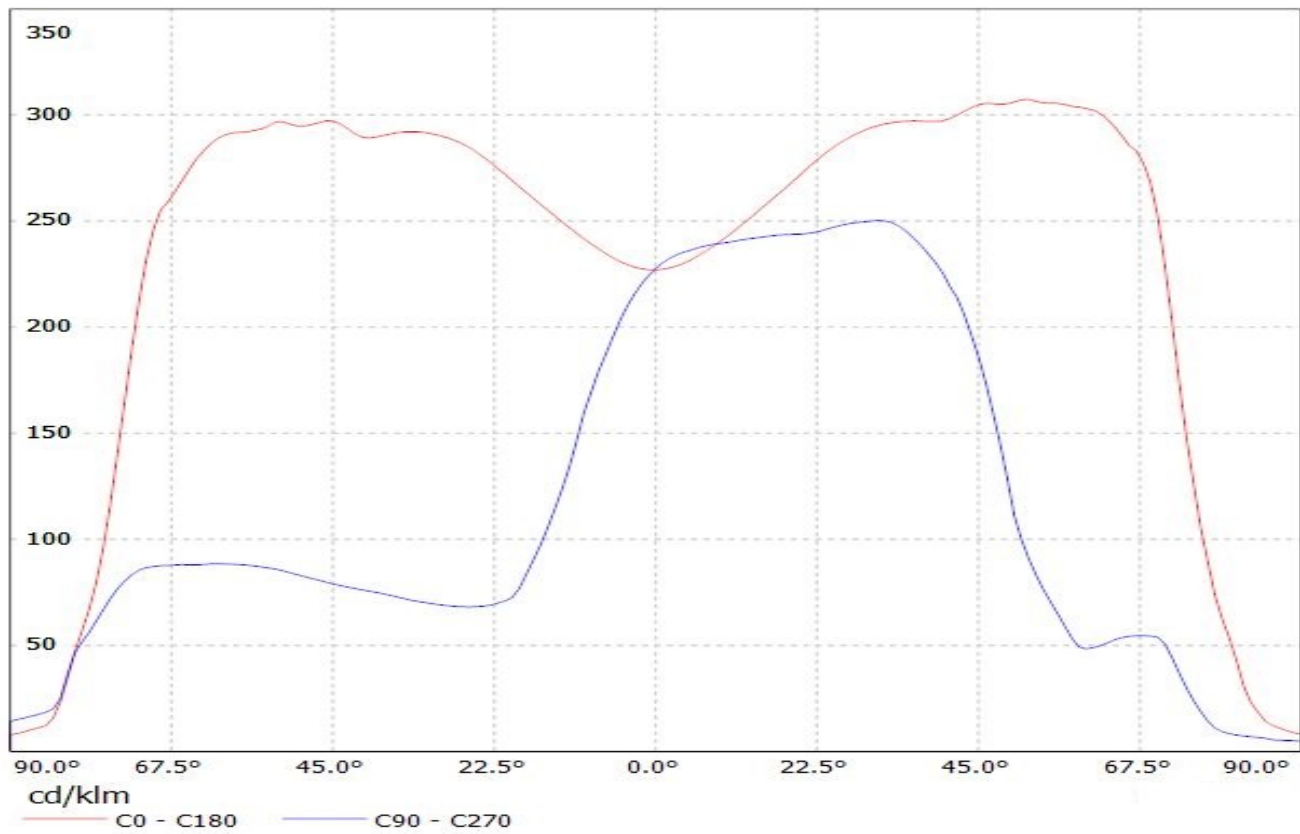

Luminaire: LEDiL Oy FN13323_STELLA-A Eff. 92%

Lamps: 1 x VERO13 (BXRC-30E4000F) 819lm@250mA CCT=3000K P=7.5W I=250mA

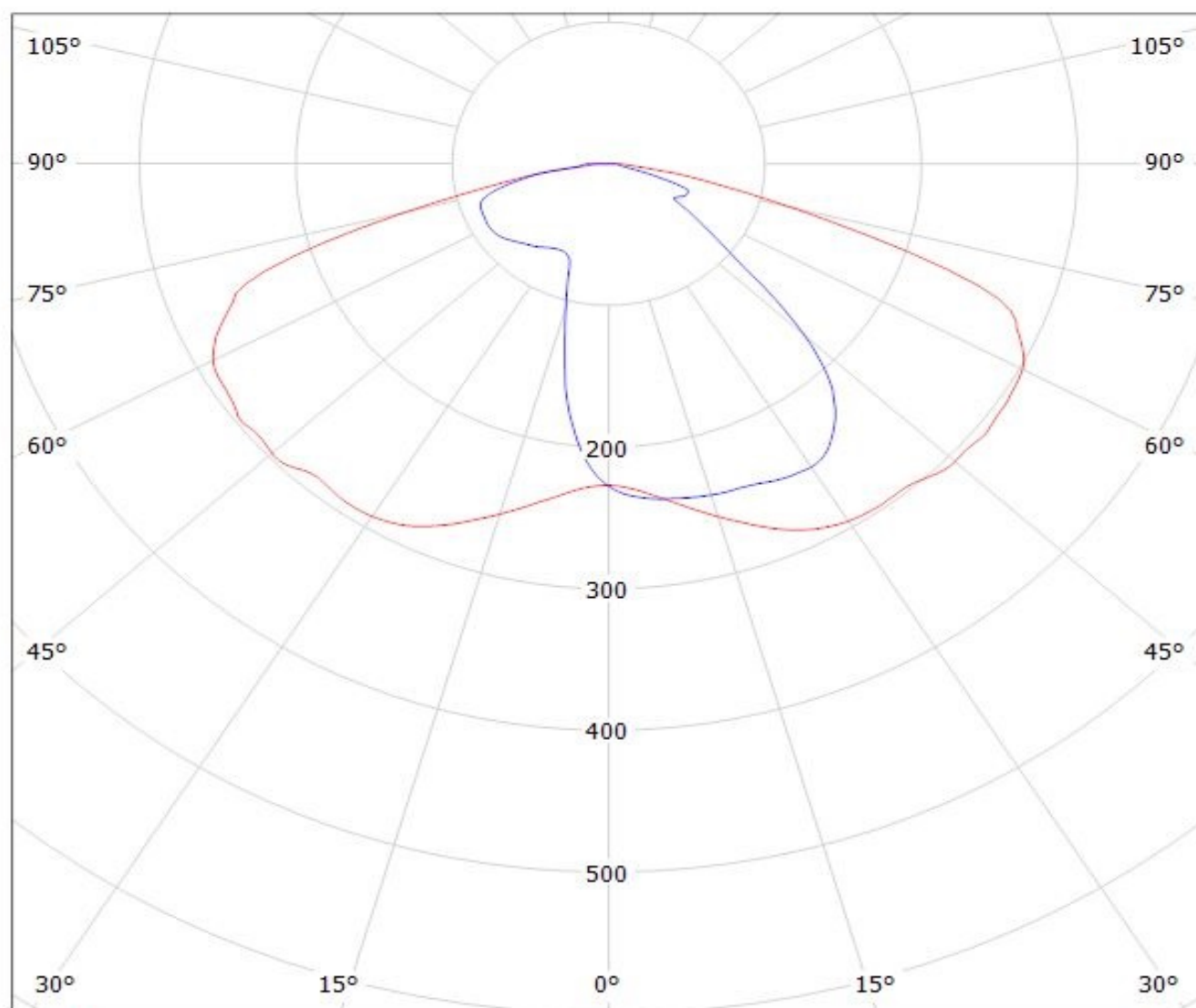

cd/klm

— C0 - C180

— C90 - C270

Mouser Electronics

Authorized Distributor

Click to View Pricing, Inventory, Delivery & Lifecycle Information:

Ledil:

[FN13323_STELLA-A](#)