

Dimensions: mm (in.)

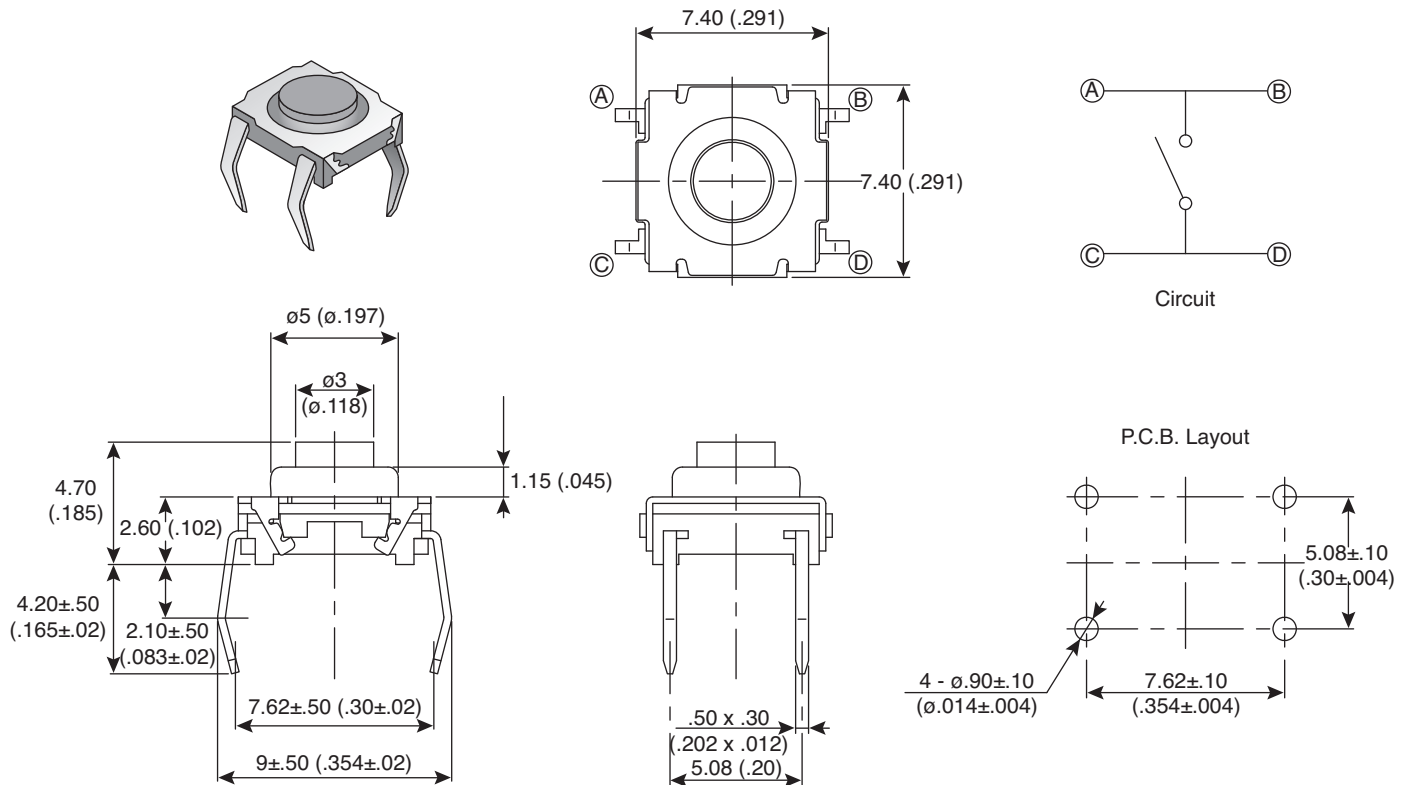

Electrical Specifications:

- Rating: 50mA/50 VDC
- Contact Resistance: 100m Ω max.
- Insulation Resistance: 100 VDC 1,000M Ω min.
- Dielectric Strength: 250 V AC(50Hz or 60Hz) for 1 minute

Mechanical Specifications:

- Operating Temperature: -40° C to +90° C
- Storage Temperature: -40° C to +90° C
- Operating Force: 101-TH71-EV= 130gf, 101-TH72-EV= 300gf
- Operating Force: 130 \pm 50g
- Stroke: .50 \pm .20 mm

Note:

- RoHS Compliant

Tactile Switches

101-TH71-EV, 101-TH72-EV



Mouser Electronics

Authorized Distributor

Click to View Pricing, Inventory, Delivery & Lifecycle Information:

[Mountain Switch:](#)

[101-TH71-EV](#) [101-TH72-EV](#)