

BELDEN Molded Cable Assemblies

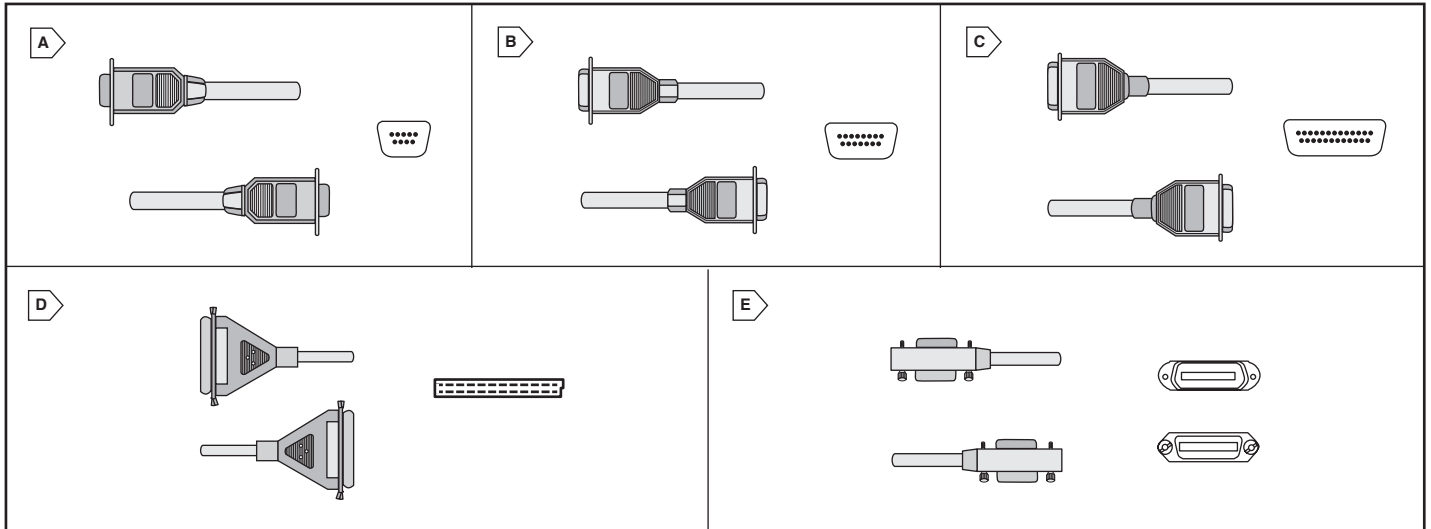

SHIELDED D-SUBMINIATURE CABLE ASSEMBLIES

9-Position, Foil Shield

Designed for RS-449 applications. Molded handles are 100% shielded to assist in FCC compliance and guard against EMI/RFI. RoHS Compliant All connectors tin-plated and male connectors have detents for positive ground connection. Wiring is point-to-point with the shield to connector shell. Jack screw retention on both connectors.

- 300V 80°C, UL AWM Style 2464
- Nominal O.D.: .244 in.

MOUSER STOCK NO.	Belden Part No.	Fig.	Gender	Length: ft (m)	Price Each	
					1	2
566-49905A	49905A	A	Male/Female	5 (1.52)	133.97	120.73
566-49906A	49906A	A	Male/Female	10 (3.05)	143.36	129.20
566-49907A	49907A	A	Male/Female	25 (7.62)	199.39	179.69

15-Position, Foil Plus Braid Shield

Designed for RS-449 applications. Molded handles are 100% shielded to assist in FCC compliance and guard against EMI/RFI. RoHS Compliant All connectors tin-plated and male connectors have detents for positive ground connection. Wiring is point-to-point with the shield to connector shell. Jack screw retention on both connectors.

- 300V 80°C, UL AWM Style 2464
- Nominal O.D.: .300 in.

MOUSER STOCK NO.	Belden Part No.	Fig.	Gender	Length: ft (m)	Price Each	
					1	2
566-49745A	49745A	B	Male/Female	5 (1.52)	187.99	169.43
566-49746A	49746A	B	Male/Female	10 (3.05)	180.49	172.95
566-49747A	49747A	B	Male/Female	25 (7.62)	247.52	223.06

25-Position, Foil Shield

Designed for RS-232 applications. Molded handles are 100% shielded to guard against EMI/RFI where indicated. All connectors are tin-plated and male connectors have detents to allow for a positive shield to ground connection. Wiring is point-to-point with the shield to connector shell. Jack screw retention on both connectors.

- 300V 80°C, UL AWM Style 2464
- Nominal O.D.: .339 in.

MOUSER STOCK NO.	Belden Part No.	Fig.	Gender	Length: ft (m)	Price Each	
					1	2
566-49673A	49673A	C	Male/Female	5 (1.52)	198.04	178.49
566-49674A	49674A	C	Male/Female	10 (3.05)	243.76	219.67
566-49675A	49675A	C	Male/Female	25 (7.62)	300.07	270.43

25-Position, Foil Plus Braid Shield

Designed for RS-232 applications. Molded handles are 100% shielded to guard against EMI/RFI where indicated. All connectors are tin-plated and male connectors have detents to allow for a positive shield to ground connection. Wiring is point-to-point with the shield to connector shell. Jack screw retention on both connectors.

- 300V 80°C, UL AWM Style 2464
- Nominal O.D.: .370 in.

MOUSER STOCK NO.	Belden Part No.	Fig.	Gender	Length: ft (m)	Price Each	
					1	2
566-49615A	49615A	C	Male/Female	5 (1.52)	186.23	166.78
566-49616A	49616A	C	Male/Female	10 (3.05)	240.85	224.37

SHIELDED D-SUBMINIATURE CABLE ASSEMBLIES (CONT.)

37-Position, Foil Shield

Designed for RS-449 applications where assembly is exposed to high noise environment. Molded handles are 100% shielded to assist in FCC compliance and guard against EMI/RFI. All connectors are tin-plated and male connectors have detents to allow for a positive shield to ground connection. Wiring is point-to-point with shield to connector shell and pin#1. Jack screw retention on both connectors.

- 300V 80°C, UL AWM Style 2464
- Nominal O.D.: .480 in.

MOUSER STOCK NO.	Belden Part No.	Fig.	Gender	Length: ft (m)	Price Each	
					1	2
566-49950A	49950A	C	Male/Male	5 (1.52)	292.50	263.61
566-49951A	49951A	C	Male/Male	10 (3.05)	340.20	306.59
566-49955A	49955A	C	Male/Female	5 (1.52)	301.65	271.86
566-49956A	49956A	C	Male/Female	10 (3.05)	356.50	321.29
566-49957A	49957A	C	Male/Female	25 (7.62)	516.28	465.28

SCSI-1 CABLE ASSEMBLIES

Molded handles are 100% shielded to guard against EMI/RFI and assists in FCC compliance. These assemblies have tin-plated connectors and can be used in single-ended or differential configurations. Wiring is per SCSI standard

- 26AWG (7 x 34) Stranded tinned copper conductor
- 30V 80°C, UL AWM Style 2919
- Nominal O.D.: .535 in.

MOUSER STOCK NO.	Belden Part No.	Fig.	Gender	Length: ft (m)	Price Each	
					1	2
566-49802A	49802A	D	Male/Male	16.4 (5)	224.06	214.67

GPIO CABLE ASSEMBLIES

General Purpose Interface Bus Cable Assemblies are used with electronic equipment that is IEEE-488 compatible. Molded connector is male/female design for easy stacking and comes with molded-in metric jack screws.

- 6 pairs 26 AWG (7x34), 10 singles 26AWG (7x34), 1 single 24AWG (7x32)
- 300V 80°C, UL AWM Style 2464
- Nominal O.D.: .350 in.

Unshielded

MOUSER STOCK NO.	Belden Part No.	Fig.	Gender	Length: ft (m)	Price Each	
					1	2
566-49642	49642	E	Male/Female	3.3 (1.01)	339.60	316.34
566-49643	49643	E	Male/Female	6.6 (2.01)	355.68	331.30

Shielded

MOUSER STOCK NO.	Belden Part No.	Fig.	Gender	Length: ft (m)	Price Each	
					1	2
566-49733	49733	E	Male/Female	1.6 (.487)	353.93	318.97
566-49734	49734	E	Male/Female	3.3 (1.01)	363.64	338.74
566-49735	49735	E	Male/Female	6.6 (2.01)	379.25	353.28
566-49736	49736	E	Male/Female	9.8 (2.99)	397.16	369.96