

API DELEVAN SMD Power Inductors

API Delevan

RoHS Compliant This product is RoHS compliant.

5500R SERIES

Specifications:

- Operating Temperature: -55°C to +130°C
- Current Rating @ 85°C Ambient with 45°C Rise

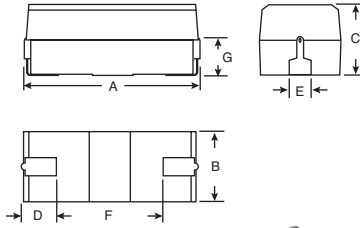

Physical Parameters		
	Inches	Millimeters
A	1.020 to 1.080	25.91 to 27.44
B	0.480 to 0.510	12.20 to 12.96
C	0.510 Max.	12.96 Max.
D	0.240 Min.	6.10 Min.
E	0.120 to 0.160	3.05 to 4.07
F	0.500 (Ref Only)	12.70 (Ref Only)
G	0.250 (Ref Only)	6.35 (Ref Only)

Dimensions "A" and "C" are over terminals.

For quantities of 1000 and up, call for quote.

MOUSER STOCK NO.	API Delevan Part No.	Ind. (μH)	DCR Max.	I _{dc} Max. (A)	Price Each			
					1	10	100	500
807-5500R-392K	5500R-392K	3.9	0.007	11.91	5.86	5.37	4.44	3.50
807-5500R-472K	5500R-472K	4.7	0.008	11.14	5.86	5.37	4.44	3.50
807-5500R-562K	5500R-562K	5.6	0.011	9.50	5.86	5.37	4.44	3.50
807-5500R-682K	5500R-682K	6.8	0.012	9.10	5.86	5.37	4.44	3.50
807-5500R-822K	5500R-822K	8.2	0.013	8.74	5.86	5.37	4.44	3.50
807-5500R-103K	5500R-103K	10	0.016	7.88	5.86	5.37	4.44	3.50
807-5500R-123K	5500R-123K	12	0.018	7.43	5.86	5.37	4.44	3.50
807-5500R-153K	5500R-153K	15	0.020	7.05	5.86	5.37	4.44	3.50
807-5500R-183K	5500R-183K	18	0.022	6.72	5.86	5.37	4.44	3.50
807-5500R-223K	5500R-223K	22	0.024	6.43	5.86	5.37	4.44	3.50
807-5500R-273K	5500R-273K	27	0.025	6.30	5.86	5.37	4.44	3.50
807-5500R-333K	5500R-333K	33	0.028	5.96	5.86	5.37	4.44	3.50
807-5500R-393K	5500R-393K	39	0.031	5.66	5.86	5.37	4.44	3.50
807-5500R-473K	5500R-473K	47	0.034	5.41	5.86	5.37	4.44	3.50
807-5500R-563K	5500R-563K	56	0.043	4.81	5.86	5.37	4.44	3.50
807-5500R-683K	5500R-683K	68	0.060	4.08	5.86	5.37	4.44	3.50
807-5500R-823K	5500R-823K	82	0.066	3.88	5.86	5.37	4.44	3.50
807-5500R-104K	5500R-104K	100	0.084	3.44	5.86	5.37	4.44	3.50
807-5500R-124K	5500R-124K	120	0.113	2.96	5.86	5.37	4.44	3.50
807-5500R-154K	5500R-154K	150	0.129	2.78	5.86	5.37	4.44	3.50
807-5500R-184K	5500R-184K	180	0.150	2.57	5.86	5.37	4.44	3.50
807-5500R-224K	5500R-224K	220	0.162	2.48	5.86	5.37	4.44	3.50
807-5500R-274K	5500R-274K	270	0.226	2.10	5.86	5.37	4.44	3.50
807-5500R-334K	5500R-334K	330	0.257	1.97	5.86	5.37	4.44	3.50
807-5500R-394K	5500R-394K	390	0.288	1.86	5.86	5.37	4.44	3.50
807-5500R-474K	5500R-474K	470	0.393	1.59	5.86	5.37	4.44	3.50
807-5500R-564K	5500R-564K	560	0.504	1.40	5.86	5.37	4.44	3.50
807-5500R-684K	5500R-684K	680	0.570	1.32	5.86	5.37	4.44	3.50
807-5500R-824K	5500R-824K	820	0.643	1.24	5.86	5.37	4.44	3.50
807-5500R-105K	5500R-105K	1000	0.844	1.08	5.86	5.37	4.44	3.50
807-5500R-125K	5500R-125K	1200	0.977	1.01	6.05	5.55	4.58	3.60
807-5500R-155K	5500R-155K	1500	1.18	0.92	6.05	5.55	4.58	3.60
807-5500R-185K	5500R-185K	1800	1.50	0.81	6.05	5.55	4.58	3.60
807-5500R-225K	5500R-225K	2200	1.76	0.75	6.05	5.55	4.58	3.60
807-5500R-275K	5500R-275K	2700	2.13	0.68	6.05	5.55	4.58	3.60
807-5500R-335K	5500R-335K	3300	2.53	0.63	6.05	5.55	4.58	3.60
807-5500R-395K	5500R-395K	3900	2.84	0.59	6.05	5.55	4.58	3.60
807-5500R-475K	5500R-475K	4700	3.79	0.51	6.05	5.55	4.58	3.60
807-5500R-565K	5500R-565K	5600	4.24	0.48	6.05	5.55	4.58	3.60
807-5500R-685K	5500R-685K	6800	5.75	0.42	6.05	5.55	4.58	3.60
807-5500R-825K	5500R-825K	8200	6.44	0.39	6.05	5.55	4.58	3.60
807-5500R-106K	5500R-106K	10000	7.30	0.37	6.05	5.55	4.58	3.60
807-5500R-126K	5500R-126K	12000	9.34	0.33	6.05	5.55	4.58	3.60
807-5500R-156K	5500R-156K	15000	10.70	0.30	6.05	5.55	4.58	3.60
807-5500R-186K	5500R-186K	18000	14.8	0.26	6.05	5.55	4.58	3.60
807-5500R-226K	5500R-226K	22000	18.0	0.23	6.05	5.55	4.58	3.60
807-5500R-276K	5500R-276K	27000	22.7	0.21	6.05	5.55	4.58	3.60
807-5500R-336K	5500R-336K	33000	25.7	0.20	6.05	5.55	4.58	3.60
807-5500R-396K	5500R-396K	39000	29.7	0.18	6.05	5.55	4.58	3.60
807-5500R-476K	5500R-476K	47000	33.7	0.17	6.05	5.55	4.58	3.60
807-5500R-566K	5500R-566K	56000	38.0	0.16	6.05	5.55	4.58	3.60
807-5500R-686K	5500R-686K	68000	52.8	0.14	6.05	5.55	4.58	3.60
807-5500R-826K	5500R-826K	82000	67.3	0.12	6.05	5.55	4.58	3.60
807-5500R-107K	5500R-107K	10000	76.0	0.11	6.05	5.55	4.58	3.60

4922R SERIES

- Operating Temperature: -55°C to +125°C
- Current Rating at 85°C Ambient: 40°C Rise

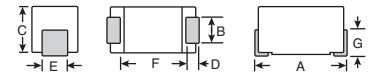
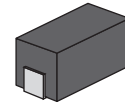

Physical Parameters		
	Inches	Millimeters
A	0.490 to 0.520	12.44 to 13.21
B	0.230 to 0.250	5.84 to 6.35
C	0.210 to 0.230	5.33 to 5.84
D	0.050 Min.	1.27 Min.
E	0.055 to 0.075	1.40 to 1.91
F	0.330 (Ref Only)	8.38 (Ref Only)
G	0.120 (Ref Only)	3.04 (Ref Only)

For quantities of 500 and up, call for quote.

MOUSER STOCK NO.	API Delevan Part No.	Ind. (μH)	DCR Max. (Ω)	I _{dc} Max. (mA)	Price Each			
					1	10	50	100
807-4922R-271L	4922R-271L	0.27	0.0085	6.75	3.72	3.17	2.69	2.08
807-4922R-471L	4922R-471L	0.47	0.010	6.00	3.72	3.17	2.69	2.08
807-4922R-01L	4922R-01L	1.0	0.013	5.50	3.72	3.17	2.69	2.08
807-4922R-03L	4922R-03L	1.5	0.020	4.45	3.72	3.17	2.69	2.08
807-4922R-05L	4922R-05L	2.2	0.029	3.70	3.72	3.17	2.69	2.08
807-4922R-07L	4922R-07L	3.3	0.038	3.23	3.72	3.17	2.69	2.08
807-4922R-09L	4922R-09L	4.7	0.047	2.90	3.72	3.17	2.69	2.08
807-4922R-11L	4922R-11L	6.8	0.058	2.61	3.72	3.17	2.69	2.08
807-4922R-13L	4922R-13L	10	0.071	2.36	3.72	3.17	2.69	2.08
807-4922R-16L	4922R-16L	18	0.119	1.82	3.72	3.17	2.69	2.08
807-4922R-17L	4922R-17L	22	0.152	1.61	3.72	3.17	2.69	2.08
807-4922R-19L	4922R-19L	33	0.222	1.33	3.72	3.17	2.69	2.08
807-4922R-20L	4922R-20L	39	0.315	1.12	3.72	3.17	2.69	2.08
807-4922R-21L	4922R-21L	47	0.362	1.04	3.72	3.17	2.69	2.08
807-4922R-22L	4922R-22L	56	0.397	1.00	3.72	3.17	2.69	2.08
807-4922R-23L	4922R-23L	68	0.418	0.97	3.72	3.17	2.69	2.08
807-4922R-25L	4922R-25L	100	0.672	0.76	3.72	3.17	2.69	2.08
807-4922R-29L	4922R-29L	220	1.58	0.50	3.72	3.17	2.69	2.08
807-4922R-31L	4922R-31L	330	2.51	0.39	3.72	3.17	2.69	2.08
807-4922R-37L	4922R-37L	1000	6.90	0.24	4.88	4.15	3.54	2.74
807-4922R-38L	4922R-38L	1200	10	0.20	4.88	4.15	3.54	2.74
807-4922R-41L	4922R-41L	2200	20	0.141	4.88	4.15	3.54	2.74
807-4922R-42L	4922R-42L	2700	23	0.131	4.88	4.15	3.54	2.74
807-4922R-43L	4922R-43L	3300	25	0.126	4.88	4.15	3.54	2.74
807-4922R-48L	4922R-48L	8200	66	0.077	4.88	4.15	3.54	2.74

P1330R SERIES

- Operating Temperature: -55°C to +125°C
- Current Rating at 90°C Ambient: 35°C Rise
- Tolerance: ±10%

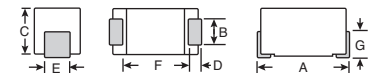
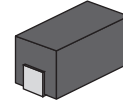

Physical Parameters		
	Inches	Millimeters
A	0.300 to 0.325	7.62 to 8.26
B	0.105 to 0.125	2.67 to 3.18
C	0.125 to 0.145	3.18 to 3.68
D	0.020 Min.	0.508 Min.
E	0.040 to 0.060	1.02 to 1.52
F	0.190 (Ref Only)	4.83 (Ref Only)
G	0.070 (Ref Only)	1.78 (Ref Only)

For quantities of 500 and up, call for quote.

MOUSER STOCK NO.	API Delevan Part No.	Ind. (μH)	Q Min.	Test Freq. (MHz)	I _{dc} Max. (mA)	Price Each			
						1	50	100	350
807-P1330R-152K	P1330R-152K	1.5	0.043	2030	2.72	2.31	1.97	1.70	
807-P1330R-182K	P1330R-182K	1.8	0.048	1950	2.72	2.31	1.97	1.70	
807-P1330R-272K	P1330R-272K	2.7	0.080	1550	2.72	2.31	1.97	1.70	
807-P1330R-332K	P1330R-332K	3.3	0.108	1460	2.72	2.31	1.97	1.70	
807-P1330R-822K	P1330R-822K	8.2	0.180	1020	2.72	2.31	1.97	1.70	
807-P1330R-153K	P1330R-153K	15	0.288	858	2.72	2.31	1.97	1.70	
807-P1330R-473K	P1330R-473K	47	0.792	467	2.72	2.31	1.97	1.70	
807-P1330R-683K	P1330R-683K	68	1.02	384	2.72	2.31	1.97	1.70	
807-P1330R-823K	P1330R-823K	82	1.38	362	2.72	2.31	1.97	1.70	
807-P1330R-154K	P1330R-154K	150	2.04	272	2.84	2.42	2.06	1.77	
807-P1330R-184K	P1330R-184K	180	2.40	261	2.84	2.42	2.06	1.77	
807-P1330R-224K	P1330R-224K	220	2.65	223	2.84	2.42	2.06	1.77	

SMB2.5R SERIES

- Operating Temperature: -40°C to +125°C
- Current Rating at 90°C Ambient: 35°C Rise
- Tolerance: ±10%

