

DISPLAYTECH COG Graphic Displays & RGB Backlights *Displaytech Ltd*

RoHS Compliant This product is RoHS compliant.

Displays

Displaytech

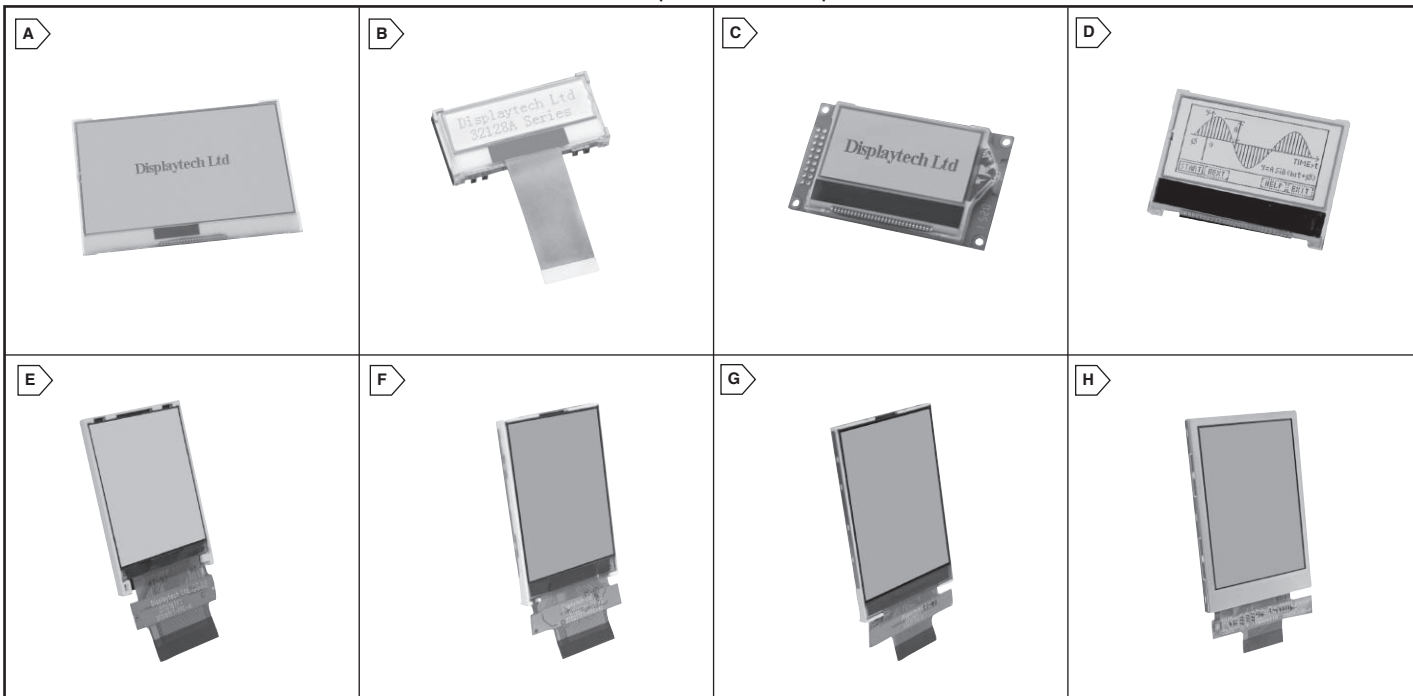

Chip On Glass (COG) Graphic Displays: By attaching the driver directly to the LCD glass it is possible to improve dot density over conventional heat seal or zebra technology. This results in the user's ability to achieve a more compact design saving space, weight, and cost. Displaytech, Ltd. is continuously expanding the range of its standard COG graphic modules, with resolution from 128 x 32 to 240 x 128 dots. These displays are offered with White LED backlight or an industry first RGB Backlight.

DISPLAYTECH COG RGB LED BACKLIGHT

RGB Backlights:

Displaytech Ltd. introduces its new line of RGB backlights, with composite red, green, and blue LED's. The three colors can be connected to be turned on individually or in combination to achieve a variety of backlight colors. For example, users can offer a product with green backlight for good conditions and red for alerts or alarms.

* With FPC Interface

For quantities of 100 and up, call for quote.

MOUSER STOCK NO.	Displaytech Part No.	Fig.	Display Format	Module Size (mm) (W x H x T)	Backlight Color	Duty	Viewing Area (mm) (W x H)	Dot Size (mm) (W x H)	Price Each			
									1	10	25	50
758-S64128KFCBW-RGB	S64128K FC BW-RGB	A	128 x 64	58.2x41.7x5.7	RGB	1/65	50x25	0.33x0.33	18.07	17.14	16.03	15.29
*758-S64128MFCBW-RGB	S64128M FC BW-RGB	A	128 x 64	77.4x52.4x6.5	RGB	1/65	70x40	0.48x0.48	25.26	23.95	22.40	21.37
*758-S128240DFCBW-RGB	S128240D FC BW-RGB	A	240 x 128	98.7x67.7x5.7	RGB	1/128	92x53	0.325x0.325	48.29	45.95	40.18	33.21
758-S32128A-FCBW-RGB	S32128A FC BW-RGB	B	128 x 32	41.3x19.7x5.3	RGB	1/33	36.1x9.95	0.242x0.245	15.15	13.75	11.66	11.12
758-S64128KXWRGB	S64128KX FC BW-RGB	C	128 x 64	58.2x41.7x5.7	RGB	1/65	50x25	0.33x0.33	23.49	21.14	19.22	17.62

DISPLAYTECH COG WHITE LED BACKLIGHT

* With FPC Interface

** Reflective model with pins

For quantities of 100 and up, call for quote.

MOUSER STOCK NO.	Displaytech Part No.	Fig.	Display Format	Module Size (mm) (W x H x T)	Backlight Color	Duty	Viewing Area (mm) (W x H)	Dot Size (mm) (W x H)	Price Each			
									1	10	25	50
758-S64128LFCBW-3	S64128L FC BW-3	A	128 x 64	68.8x49.2x5.7	White	1/65	60.6x33.1	0.4x0.4	18.46	17.50	16.37	15.62
758-S64128MFCBW-3	S64128M FC BW-3	A	128 x 64	77.4x52.4x6.5	White	1/65	70x40	0.48x0.48	21.45	20.34	19.03	18.15
758-S128240DFCBW-3	S128240D FC BW-3	A	240 x 128	98.7x67.7x5.7	White	1/128	92x53	0.325x0.325	43.14	39.14	34.74	28.72
758-S32128A-FCBW-3	S32128A FC BW-3	B	128 x 32	41.3x19.7x5.3	White	1/33	36.1x9.95	0.242x0.245	12.78	11.62	9.94	8.21
758-S64128KFCBW-3	S64128K FC BW-3	D	128 x 64	58.2x41.7x5.7	White	1/65	50x25	0.33x0.33	17.75	15.93	13.97	13.32
758-S64128NW-3LP	S64128N FC BW-3LP	D	128 x 64	58.2x41.7x5.7	White	1/65	50x25	0.33x0.33	18.00	16.20	14.73	13.50
*758-S64128KXW3	S64128KX FC BW-3	C	128 x 64	58.2x41.7x5.7	White	1/65	50x25	0.33x0.33	18.67	16.80	15.27	14.00
*758-S64128MXW-3	S64128MX FC BW-3	C	128 x 64	77.4x52.4x6.5	White	1/65	70x40	0.48x0.48	27.02	24.32	22.11	20.27

DISPLAYTECH TFT DISPLAYS



For quantities of 100 and up, call for quote.

MOUSER STOCK NO.	Displaytech Part No.	Fig.	Module Size Diag. (in.)	Display Format	Display Color	Driver IC	Viewing Area (mm) (W x H)	Module Size (mm) (W x H)	Price Each			
									1	5	10	50
758-SDT018TFT	SDT018TFT	E	1.8	128 x 160	262 K	S6D0151	30.23 x 36.79	34 x 47	13.37	12.75	11.84	11.05
758-SDT022TFT	SDT022TFT	F	2.2	240 x 320	262 K	S6D0139	36.04 x 46.72	40.54 x 56.45	20.90	19.94	18.51	17.28
758-SDT024TFT-TS	SDT024TFT-TS	-	2.4	384 x 160	262K	IL19320	51.36 x 39.12	47 x 34	31.29	29.85	27.71	25.87
758-SDT028TFT-TS	SDT028TFT-TS	G	2.8	240 x 320	262 K	R61505U	47.0 x 60.1	50.0 x 69.2	35.16	33.54	31.14	29.07
758-SDT032TFT-TS	SDT032TFT-TS	H	3.2	240 x 320	262 K	SSD1289	50.6 x 66.8	57.54 x 79.2	42.56	40.60	37.70	35.19
758-SDT033TFT	SDT033TFT	-	3.3	320 x 480	262 K	D51E5TA7601	49.55 x 97.07	84.04 x 55.66	36.23	34.55	32.09	29.95
758-SDT033TFT-TS	SDT033TFT-TS	-	3.3	320 x 480	262 K	D51E5TA7601	49.55 x 97.07	84.04 x 55.66	48.08	45.86	42.59	39.75
758-SDT042TFT	SDT042TFT	-	4.2	432 x 240	262 K	IL19326	49.55 x 97.07	54.8 x 113.28	51.56	49.18	45.67	42.63
758-SDT042TFT-TS	SDT042TFT-TS	-	4.2	432 x 240	262 K	IL19326	49.55 x 97.07	54.8 x 113.28	62.77	59.88	55.60	51.89
758-SDT057TFT	SDT057TFT	-	5.7	640 x 480	16m	HX8678 & HX8250	116.8 x 88.0	127.16 x 98.40	136.68	132.60	126.91	118.45
758-SDT057TFT-TS	SDT057TFT-TS	-	5.7	640 x 480	16m	HX8678 & HX8251	116.8 x 88.1	127.16 x 98.40	155.83	151.18	144.70	135.05
758-SDT070TFT	SDT070TFT	-	7.0	800 x 480	16.7m	HX8678-B & HX8262-A	153.80 x 92.84	165 x 106.40	100.48	97.48	93.30	87.08
758-SDT070TFT-TS	SDT070TFT-TS	-	7.0	800 x 480	16.7m	HX8678-B & HX8262-A	153.80 x 92.84	165 x 106.40	156.48	151.81	145.30	136.61