

VISHAY Opto Components

RoHS Compliant This product is RoHS compliant.

Opto Components

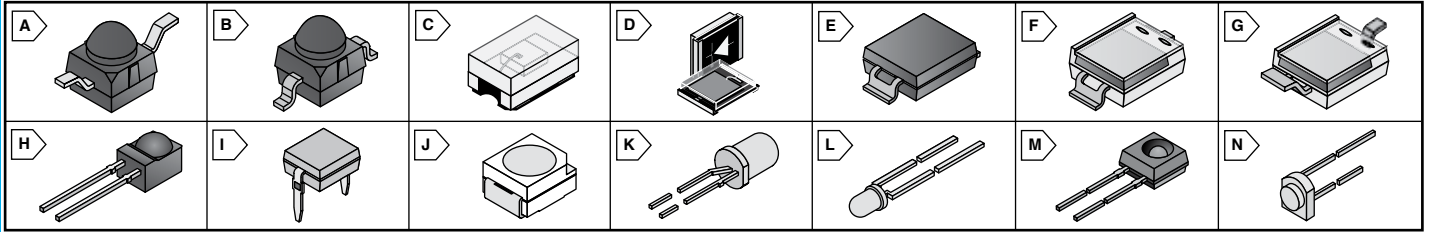

DETECTORS

Vishay has the broadest portfolio of PIN Photodiodes in the market. With lower capacitance, they provide high-speed response, low-noise and low dark current along with excellent sensitivity. They are ideal for high-speed data transfer, light barriers, alarm systems and linear light measurement. In addition to PIN photodiodes, Vishay provides the industry's widest selection of phototransistors. Offered in over 12 packages, Vishay's phototransistors are exceptionally sensitive and simplify circuit design by eliminating the need for a separate amplifier.



RoHS Compliant

Photo PIN Diodes

For quantities of 2000 and up, call for quote.

MOUSER STOCK NO.		Fig.	Angle of Half Intensity (°)	Reverse Light Current				Peak Wavelength (nm)	Reverse Dark Current (typ)(nA)	Rise/Fall Times (ns)	Price Each			
Mfr.	Mfr. Part No.			(Min./Typ.)(uA)	@ Rev. Volt (V)	@Ee (mW/cm²)	@ Wavelength (nm)				Sensitivity (nm)	1	100	500
Surface Mount														
782	VEMD2000X01	A	±15	5/12	5	1	950	940	1	100/100	.50	.40	.33	.29
782	VEMD2020X01	B	±15	5/12	5	1	950	940	1	100/100	.50	.40	.33	.29
782	TEMD7000X01	C	±60	----/3	5	1	950	900	1	100/100	.74	.59	.49	.43
782	TEMD7100X01	C	±60	----/3	5	1	950	950	1	100/100	.74	.59	.49	.43
782	TEMD5020	D	±65	25/35	5	1	950	900	2	100/100	1.37	1.04	.967	.513
782	TEMD5120X01	D	±65	25/35	5	1	950	940	2	100/100	1.37	1.04	.967	.513
782	VBP104FAS	E	±65	25/35	5	1	950	950	2	100/100	.66	.53	.44	.38
782	VBP104S	F	±65	25/35	5	1	950	940	2	100/100	.71	.57	.47	.41
782	VBP104SR	G	±65	25/35	5	1	950	940	2	100/100	.66	.623	.60	.53
782	TEMD5010	D	±65	40/55	5	1	950	900	2	100/100	1.44	1.10	1.01	.54
782	TEMD5110X01	D	±65	45/55	5	1	950	940	2	100/100	1.44	1.10	1.01	.54
782	VBPW34FAS	E	±65	45/55	5	1	950	950	2	100/100	.71	.666	.64	.57
782	VBPW34S	F	±65	45/55	5	1	950	940	2	100/100	.71	.57	.47	.41
782	VBPW34SR	G	±65	45/55	5	1	950	940	2	100/100	.71	.57	.47	.41
782	TEMD5080X01	D	±65	----/60	5	1	950	940	2	40/40	1.31	1.05	.87	.76
Thru-Hole														
782	BPV22NF	H	±60	55/85	5	1	870	940	2	100/100	.90	.60	.512	.415
782	BPW34	I	±65	40/50	5	1	950	900	2	100/100	.98	.66	.558	.453

Photo Transistors

For quantities of 2000 and up, call for quote.

MOUSER STOCK NO.		Fig.	Angle of Half Intensity (°)	Collector Dark Current		Collector Current (mA)	Peak Wavelength Sensitivity (nm)	Collector Emitter Voltage (Max.)(V)	Collector Light Current (Typ.)(mA)	Turn-On/ Turn-Off Times (µS)	Price Each			
Mfr.	Mfr. Part No.			(Min./Typ.)(uA)	@ Rev. Volt (V)						1	100	500	1000
Surface Mount														
782	VEMT2000X01	A	±15	1/100	5	50	860	20	6	----/----	.47	.37	.31	.27
782	VEMT2020X01	B	±15	1/100	5	50	860	20	6	----/----	.47	.37	.31	.27
782	VEMT3700	J	±60	1/200	20	50	850	70	0.5	6/2	.75	.60	.54	.432
782	VEMT3700F	J	±60	1/200	20	50	850	70	0.5	6/2	.58	.46	.38	.33
782	VEMT4700	J	±60	1/200	20	50	850	70	0.5	6/2	.61	.49	.40	.36
Thru-Hole														
782	BPV11F	K	±15	1/50	10	50	930	70	9	6/5	.84	.55	.482	.373
782	BPW85	L	±25	1/200	20	50	850	70	1.5	2.0/2.3	.35	.28	.23	.20
782	BPW85C	L	±25	1/200	20	50	850	70	5	2.0/2.3	.38	.31	.25	.22
782	TEKT5400S	M	±37	1/100	20	100	920	70	4	6/5	.81	.53	.431	.361

EMITTERS

Vishay offers emitters in more wavelengths than any other supplier: 830nm, 850nm, 870nm, 885nm, 940nm and 950nm. Providing fast rise and fall response times, Vishay also has the broadest selection of double hetero infrared emitters. They are the highest-power infrared emitters with the lowest forward voltages on the market and ideal for high-current applications.



RoHS Compliant

Standard

For quantities of 2000 and up, call for quote.

MOUSER STOCK NO.		Fig.	Angle of Half Intensity (°)	Radiant Intensity @ IF		Forward Voltage @ IF		Peak Emission Wavelength (nm)	Rise/Fall Times (ns)	Price Each			
Mfr.	Mfr. Part No.			(min/typ) (mW/sr)	(mA)	(typ/max) (V)	(mA)			1	100	500	1000
Thru-Hole													
78	CQY37N	N	±12	2.5/5.0	50	1.3/1.6	50	950	400/450	.53	.33	.273	.208
782	TSHA4401	L	±20	16/30	100	1.5/1.8	100	875	600/600	.29	.23	.19	.17
782	TSKS5400S	M	±30	2.0/----	50	1.3/1.7	100	950	400/450	.75	.49	.43	.333

High-Power

For quantities of 2000 and up, call for quote.

MOUSER STOCK NO.		Fig.	Angle of Half Intensity (°)	Radiant Intensity @ IF (min/typ) (mW/sr)	Forward Voltage @ IF (typ/max) (V)	Peak Emission Wavelength (nm)	Rise/Fall Times (ns)	Price Each					
Mfr.	Mfr. Part No.							1	100	500	1000		
Surface Mount													
782	VSML3710	J	±60	4/8	100	1.35/1.6	100	940	800/800	.51	.36	.337	.20
Thru-Hole													
782	TSALE6100	K	±10	40/60	100	1.35/1.6	100	940	800/800	.44	.22	.189	.151
782	TSALE6200	K	±17	40/60	100	1.35/1.6	100	940	800/800	.44	.22	.189	.151
782	TSALE7200	K	±17	40/60	100	1.35/1.6	100	940	800/800	.21	.17	.14	.12
782	TSALE6400	K	±25	25/40	100	1.35/1.6	100	940	800/800	.44	.22	.189	.151
782	TSALE7400	K	±25	25/40	100	1.35/1.6	100	940	800/800	.21	.17	.14	.12

High-Speed

For quantities of 2000 and up, call for quote.

MOUSER STOCK NO.		Fig.	Angle of Half Intensity (°)	Radiant Intensity @ IF (min/typ) (mW/sr)	Forward Voltage @ IF (typ/max) (V)	Peak Emission Wavelength (nm)	Rise/Fall Times (ns)	Price Each					
Mfr.	Mfr. Part No.							1	100	500	1000		
Surface Mount													
782	VSMB2000X01	B	±12	20/40	100	1.35/1.6	100	940	15/15	.44	.35	.29	.25
782	VSMB2020X01	A	±12	20/40	100	1.35/1.6	100	940	15/15	.44	.35	.29	.25
782	VSMB1940X01	C	±60	3/6	100	1.35/1.6	100	940	15/15	.53	.42	.35	.30
782	VSMF3710	J	±60	6/10	100	1.4/1.6	100	890	30/30	.56	.44	.40	.248
782	VSMB3940X01	J	±60	7/13	100	1.35/1.6	100	940	15/15	.41	.33	.27	.24
782	VSMG2720	J	±60	8/14	100	1.45/1.6	100	830	15/15	.91	.73	.60	.53
782	VSMF4720	J	±60	10/16	100	1.45/1.6	100	870	15/15	.55	.44	.36	.32
Thru-Hole													
782	TSHG5210	K	±10	140/230	100	1.5/1.8	100	850	20/13	.72	.58	.48	.42
782	TSHG6210	K	±10	140/230	100	1.5/1.8	100	850	20/13	.72	.58	.48	.42
782	TSHG5410	K	±18	45/90	100	1.5/1.8	100	850	20/13	.72	.58	.48	.42
782	TSHG6410	K	±18	45/90	100	1.5/1.8	100	850	20/13	.72	.58	.48	.42
782	TSHG5510	K	±22	16/32	100	1.45/1.7	100	870	15/15	.89	.71	.59	.51
782	VSLB3940	L	±22	32/65	100	1.35/1.6	100	940	15/15	.36	.29	.24	.21
782	TSHF6410	K	±22	45/70	100	1.4/1.6	100	890	30/30	.34	.27	.22	.20
782	TSHF5410	K	±22	45/70	100	1.5/1.8	100	870	15/15	.86	.60	.479	.42
782	TSHG6400	K	±22	45/70	100	1.5/1.8	100	850	20/13	1.06	.74	.587	.513
782	TSHG5510	K	±38	18/32	100	1.45/1.7	100	830	15/15	.99	.79	.65	.57

NEW AT MOUSER Vishay Semiconductors