

VISHAY Opto Components

RoHS Compliant This product is RoHS compliant.

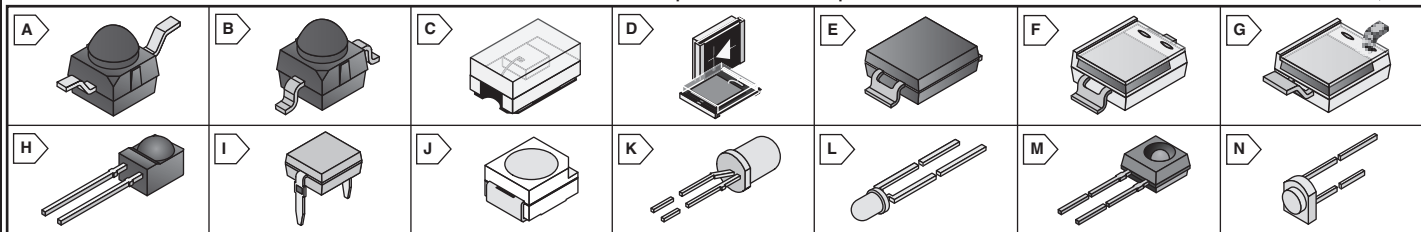

Opto Components



Vishay Semiconductors

DETECTORS

Vishay has the broadest portfolio of PIN Photodiodes in the market. With lower capacitance, they provide high-speed response, low-noise and low dark current along with excellent sensitivity. They are ideal for high-speed data transfer, light barriers, alarm systems and linear light measurement. In addition to PIN photodiodes, Vishay provides the industry's widest selection of phototransistors. Offered in over 12 packages, Vishay's phototransistors are exceptionally sensitive and simplify circuit design by eliminating the need for a separate amplifier.



RoHS Compliant

Photo PIN Diodes

For quantities of 2000 and up, call for quote.

MOUSER STOCK NO.		Fig.	Angle of Half Intensity (°)	Reverse Light Current				Peak Wavelength (nm)	Reverse Dark Current (typ)(nA)	Rise/Fall Times (ns)	Price Each			
Mfr.	Mfr. Part No.			(Min./Typ.)(uA)	@ Rev. Volt (V)	@Ee (mW/cm ²)	@ Wavelength (nm)				1	100	500	1000
Surface Mount														
	782—VEMD2000X01	A	±15	5/12	5	1	950	940	1	100/100	.50	.40	.33	.29
	782—VEMD2020X01	B	±15	5/12	5	1	950	940	1	100/100	.50	.40	.33	.29
	782—TEMD7000X01	C	±60	---/3	5	1	950	900	1	100/100	.74	.59	.49	.43
	782—TEMD7100X01	C	±60	---/3	5	1	950	950	1	100/100	.74	.59	.49	.43
	782—TEMD5020	D	±65	25/35	5	1	950	900	2	100/100	.96	.80	.66	.58
	782—TEMD5120X01	D	±65	25/35	5	1	950	940	2	100/100	1.21	.91	.71	.60
	782—VBP104FAS	E	±65	25/35	5	1	950	950	2	100/100	.66	.53	.44	.38
	782—VBP104S	F	±65	25/35	5	1	950	940	2	100/100	.71	.57	.47	.41
	782—VBP104SR	G	±65	25/35	5	1	950	940	2	100/100	.71	.57	.47	.41
	782—TEMD5010	D	±65	40/55	5	1	950	900	2	100/100	1.01	.84	.70	.61
	782—TEMD5110X01	D	±65	45/55	5	1	950	940	2	100/100	1.27	.94	.74	.64
	782—VBPW34FAS	E	±65	45/55	5	1	950	950	2	100/100	.71	.65	.64	.57
	782—VBPW34S	F	±65	45/55	5	1	950	940	2	100/100	.71	.65	.64	.57
	782—VBPW34SR	G	±65	45/55	5	1	950	940	2	100/100	.71	.65	.64	.57
	782—TEMD5080X01	D	±65	---/60	5	1	950	940	2	40/40	1.31	1.05	.87	.76
Thru-Hole														
	782—BPV22NF	H	±60	55/85	5	1	870	940	2	100/100	.66	.55	.46	.399
	782—BPW34	I	±65	40/50	5	1	950	900	2	100/100	.71	.60	.50	.435

Photo Transistors

For quantities of 2000 and up, call for quote.

MOUSER STOCK NO.		Fig.	Angle of Half Intensity (°)	Collector Dark Current		Collector Current (mA)	Peak Wavelength Sensitivity (nm)	Collector Emitter Voltage (Max.)(V)	Collector Light Current (Typ.)(mA)	Turn-On/ Turn-Off Times (µS)	Price Each			
Mfr.	Mfr. Part No.			(Min./Typ.)(uA)	@ Rev. Volt (V)						1	100	500	1000
Surface Mount														
	782—VEMT2000X01	A	±15	1/100	5	50	860	20	6	---/---	.47	.37	.31	.27
	782—VEMT2020X01	B	±15	1/100	5	50	860	20	6	---/---	.47	.37	.31	.27
	782—VEMT3700	J	±60	1/200	20	50	850	70	0.5	6/2	.54	.43	.36	.31
	782—VEMT3700F	J	±60	1/200	20	50	850	70	0.5	6/2	.58	.46	.38	.33
	782—VEMT4700	J	±60	1/200	20	50	850	70	0.5	6/2	.61	.49	.40	.36
Thru-Hole														
	782—BPV11F	K	±15	1/50	10	50	930	70	9	6/5	.57	.48	.40	.347
	782—BPW85	L	±25	1/200	20	50	850	70	1.5	2.0/2.3	.35	.28	.23	.20
	782—BPW85C	L	±25	1/200	20	50	850	70	5	2.0/2.3	.38	.31	.25	.22
	782—TEKT5400S	M	±37	1/100	20	100	920	70	4	6/5	.55	.46	.38	.336

EMITTERS

Vishay offers emitters in more wavelengths than any other supplier: 830nm, 850nm, 870nm, 885nm, 940nm and 950nm. Providing fast rise and fall response times, Vishay also has the broadest selection of double hetero infrared emitters. They are the highest-power infrared emitters with the lowest forward voltages on the market and ideal for high-current applications.



RoHS Compliant

Standard

For quantities of 2000 and up, call for quote.

MOUSER STOCK NO.		Fig.	Angle of Half Intensity (°)	Radiant Intensity @ IF		Forward Voltage @ IF		Peak Emission Wavelength (nm)	Rise/Fall Times (ns)	Price Each			
Mfr.	Mfr. Part No.			(min/typ) (mW/sr)	(mA)	(typ/max) (V)	(mA)			1	100	500	1000
Thru-Hole													
	78—CQY37N	N	±12	2.5/5.0	50	1.3/1.6	50	950	400/450	.33	.26	.21	.19
	782—TSHA4401	L	±20	16/30	100	1.5/1.8	100	875	600/600	.29	.23	.19	.17
	782—TSKS5400S	M	±30	2.0/---	50	1.3/1.7	100	950	400/450	.52	.37	.308	.275

High-Power

For quantities of 2000 and up, call for quote.

MOUSER STOCK NO.		Fig.	Angle of Half Intensity (°)	Radiant Intensity @ IF (min/typ) (mW/sr)	Forward Voltage @ IF (typ/max) (V)	Peak Emission Wavelength (nm)	Rise/Fall Times (ns)	Price Each					
Mfr.	Mfr. Part No.							1	100	500	1000		
Surface Mount													
	782—VSML3710	J	±60	4/8	100	1.35/1.6	100	940	800/800	.31	.25	.21	.18
Thru-Hole													
	782—TSAL6100	K	±10	40/60	100	1.35/1.6	100	940	800/800	.28	.22	.142	.137
	782—TSAL6200	K	±17	40/60	100	1.35/1.6	100	940	800/800	.28	.22	.142	.137
	782—TSAL7200	K	±17	40/60	100	1.35/1.6	100	940	800/800	.21	.17	.14	.12
	782—TSAL6400	K	±25	25/40	100	1.35/1.6	100	940	800/800	.28	.22	.142	.137
	782—TSAL7400	K	±25	25/40	100	1.35/1.6	100	940	800/800	.21	.17	.14	.12

High-Speed

For quantities of 2000 and up, call for quote.

MOUSER STOCK NO.		Fig.	Angle of Half Intensity (°)	Radiant Intensity @ IF (min/typ) (mW/sr)	Forward Voltage @ IF (typ/max) (V)	Peak Emission Wavelength (nm)	Rise/Fall Times (ns)	Price Each					
Mfr.	Mfr. Part No.							1	100	500	1000		
Surface Mount													
	782—VSMB2000X01	B	±12	20/40	100	1.35/1.6	100	940	15/15	.44	.35	.29	.25
	782—VSMB2020X01	A	±12	20/40	100	1.35/1.6	100	940	15/15	.44	.35	.29	.25
	782—VSMB1940X01	C	±60	3/6	100	1.35/1.6	100	940	15/15	.53	.42	.35	.30
	782—VSMF3710	J	±60	6/10	100	1.4/1.6	100	890	30/30	.40	.32	.26	.23
	782—VSMB3940X01	J	±60	7/13	100	1.35/1.6	100	940	15/15	.41	.33	.27	.24
	782—VSMG2720	J	±60	8/14	100	1.45/1.6	100	830	15/15	.91	.73	.60	.53
	782—VSMF4720	J	±60	10/16	100	1.45/1.6	100	870	15/15	.55	.44	.36	.32
Thru-Hole													
	782—TSHG5210	K	±10	140/230	100	1.5/1.8	100	850	20/13	.72	.58	.48	.42
	782—TSHG6210	K	±10	140/230	100	1.5/1.8	100	850	20/13	.72	.58	.48	.42
	782—TSHG5410	K	±18	45/90	100	1.5/1.8	100	850	20/13	.72	.58	.48	.42
	782—TSHG6410	K	±18	45/90	100	1.5/1.8	100	850	20/13	.72	.58	.48	.42
	782—TSFF5510	K	±22	16/32	100	1.45/1.7	100	870	15/15	.89	.71	.59	.51
	782—VSLB3940	L	±22	32/65	100	1.35/1.6	100	940	15/15	.36	.29	.24	.21
	782—TSHF6410	K	±22	45/70	100	1.4/1.6	100	890	30/30	.34	.27	.22	.20
	782—TSFF5410	K	±22	45/70	100	1.5/1.8	100	870	15/15	.72	.58	.48	.42
	782—TSHG6400	K	±22	45/70	100	1.5/1.8	100	850	20/13	.89	.71	.58	.51
	782—TSHG5510	K	±38	18/32	100	1.45/1.7	100	830	15/15	.99	.79	.65	.57

NEW TECHNOLOGY

NEW TECHNOLOGY

NEW TECHNOLOGY

NEW TECHNOLOGY

NEW TECHNOLOGY

NEW TECHNOLOGY