

# PANASONIC PhotoMos Relays

**Panasonic**

Panasonic Electric Works Corporation of America



This product is RoHS compliant.

Panasonic PhotoMOSTM relays offer high reliability with stable performance. Fast switching speed, low capacitance and small package size ensure that PhotoMOS relays meet the requirements of high performance switching applications, such as ATE, Instrumentation and Medical equipment.

## AQW614 EH SERIES

- 60V type couples high capacity (0.5A) with low ON resistance (1Ω)
- Reinforced insulation 5,000V type
- Controls low-level analog signals
- Low-level off-state leakage current
- High sensitivity, high speed response



RoHS Compliant

For quantities of 250 and up, call for quote.

MOUSER STOCK NO.	Panasonic Part No.	Package Style	Current Rating (mA)	Max. Load Voltage (V)	Contact Arrangement	Price Each			
						1	25	50	100
<b>Through-Hole Type</b>									
769-AQW610EH	AQW610EH	DIP-8	120	350	1 Form A/ 1 Form B	6.07	5.57	4.96	4.20
769-AQW612EH	AQW612EH	DIP-8	500	60	1 Form A/ 1 Form B	8.11	7.29	6.62	5.62
769-AQW614EH	AQW614EH	DIP-8	100	400	1 Form A/ 1 Form B	5.57	4.83	4.59	4.20
<b>SMD Type</b>									
769-AQW614EHA	AQW614EHA	SMD-8	100	400	1 Form A/ 1 Form B	6.07	5.57	4.96	4.20
769-AQW610EHA	AQW610EHA	SMD-8	120	350	1 Form A/ 1 Form B	6.07	5.57	4.96	4.20

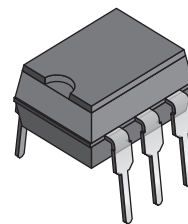

DIP-6

## AQW61 S SERIES

- 2 channels in super miniature design
- Controls low-level analog signals
- Low-level off-state leakage current
- 60V type couples high capacity (0.45A) with low ON resistance (1Ω)



RoHS Compliant

For quantities of 250 and up, call for quote.

MOUSER STOCK NO.	Panasonic Part No.	Package Style	Current Rating (mA)	Max. Load Voltage (V)	Contact Arrangement	Price Each			
						1	25	50	100
769-AQW610S	AQW610S	SMD-8	100	350	1 Form A/ 1 Form B	9.10	8.35	7.42	6.30

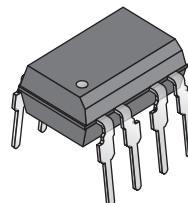

DIP-8

## AQV10 AND AQV20 SERIES

- Controls low-level analog signals
- Controlled with low-level input signals
- Low-level off state leakage current
- Optical coupling for extremely high isolation
- Stable ON resistance
- Low-level thermal electromotive force (Approx. 1μV)



RoHS Compliant

For quantities of 250 and up, call for quote.

MOUSER STOCK NO.	Panasonic Part No.	Package Style	Current Rating (mA)	Max. Load Voltage (V)	Contact Arrangement	Price Each			
						1	25	50	100
<b>Through-Hole Type</b>									
769-AQV101	AQV101	DIP-6	700	40	1 Form A	5.94	5.45	4.85	4.12
769-AQV102	AQV102	DIP-6	600	60	1 Form A	5.94	5.45	4.85	4.12
769-AQV201	AQV201	DIP-6	500	40	1 Form A	6.14	5.45	5.36	4.64
769-AQV202	AQV202	DIP-6	400	250	1 Form A	6.69	6.14	5.45	4.64
<b>SMD Type</b>									
769-AQV102A	AQV102A	SMD-6	600	60	1 Form A	5.94	5.45	4.85	4.12
769-AQV201A	AQV201A	SMD-6	500	40	1 Form A	6.69	6.14	5.45	4.64
769-AQV202A	AQV202A	SMD-6	400	60	1 Form A	6.69	6.14	5.45	4.64

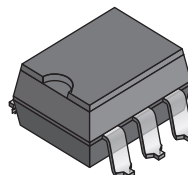

SMD-6

## AQV21 AND AQV214H SERIES

- Controls low-level analog signals
- Controlled with low-level input signals
- Optical coupling for extremely high isolation
- Stable ON resistance
- Low-level thermal electromotive force (Approx. 1μV)



RoHS Compliant

For quantities of 250 and up, call for quote.

MOUSER STOCK NO.	Panasonic Part No.	Package Style	Current Rating (mA)	Max. Load Voltage (V)	Contact Arrangement	Price Each			
						1	25	50	100
<b>Through-Hole Type</b>									
769-AQV212	AQV212	DIP-6	400	60	1 Form A	3.75	3.46	3.32	2.83
769-AQV214	AQV214	DIP-6	120	400	1 Form A	3.85	3.75	3.32	2.83
769-AQV216	AQV216	DIP-6	40	600	1 Form A	4.24	3.89	3.45	2.93
769-AQV214H	AQV214H	DIP-6	120	400	1 Form A	4.36	4.01	3.56	3.03
<b>SMD Type</b>									
769-AQV212A	AQV212A	SMD-6	400	60	1 Form A	4.09	3.75	3.32	2.83
769-AQV214A	AQV214A	SMD-6	120	400	1 Form A	4.09	3.75	3.32	2.83
769-AQV210A	AQV210A	SMD-6	120	350	2 Form A	6.82	6.26	5.56	4.72

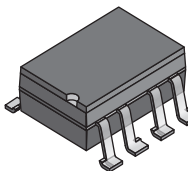

SMD-8

## AQV21 E AND EH SERIES

- Controls low-level analog signals
- Controlled with low-level input signals
- Optical coupling for extremely high isolation
- Stable ON resistance
- Low-level off state leakage current
- Low-level thermal electromotive force (Approx. 1μV)



RoHS Compliant

For quantities of 250 and up, call for quote.

MOUSER STOCK NO.	Panasonic Part No.	Package Style	Current Rating (mA)	Max. Load Voltage (V)	Contact Arrangement	Price Each			
						1	25	50	100
<b>Through-Hole Type</b>									
769-AQV210E	AQV210E	DIP-6	130	350	1 Form A	2.54	2.35	2.08	1.77
769-AQV214E	AQV214E	DIP-6	120	400	1 Form A	2.56	2.35	2.08	1.77
769-AQV210EH	AQV210EH	DIP-6	130	350	1 Form A	2.54	2.17	2.05	1.89
769-AQV214EH	AQV214EH	DIP-6	120	400	1 Form A	2.76	2.54	2.25	1.91
<b>SMD Type</b>									
769-AQV210EA	AQV210EA	SMD-6	130	350	1 Form A	2.58	2.37	2.10	1.79
769-AQV214EA	AQV214EA	SMD-6	120	400	1 Form A	2.58	2.37	2.10	1.79
769-AQV210EHA	AQV210EHA	SMD-6	130	350	1 Form A	2.58	2.34	2.21	1.95
769-AQV214EHA	AQV214EHA	SMD-6	120	400	1 Form A	2.81	2.58	2.30	1.95

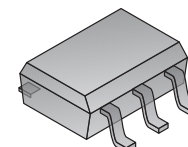

SOP-6

## AQV21 S AND AQV22 NS SERIES

- 1 channel (Form A) in super miniature design
- Controls low-level analog signals
- Low-level off state leakage current



RoHS Compliant

For quantities of 250 and up, call for quote.

MOUSER STOCK NO.	Panasonic Part No.	Package Style	Current Rating (mA)	Max. Load Voltage (V)	Contact Arrangement	Price Each			
						1	25	50	100
<b>AQV21 S Series</b>									
769-AQV210S	AQV210S	SOP-6	120	350	1 Form A	4.31	3.96	3.51	2.98
769-AQV212S	AQV212S	SOP-6	350	60	1 Form A	4.05	3.96	3.51	2.98
769-AQV214S	AQV214S	SOP-6	100	400	1 Form A	4.31	3.96	3.51	2.98
769-AQV215S	AQV215S	SOP-6	900	100	1 Form A	3.96	3.04	2.84	2.72
769-AQV216S	AQV216S	SOP-6	40	600	1 Form A	4.31	3.96	3.51	2.98
<b>AQV22 NS Series</b>									
769-AQV227NS	AQV227NS	SOP-6	50	200	1 Form B	4.99	4.57	4.07	3.45