

VCC LED Assemblies and Mounting Components



RoHS Compliant This product is RoHS compliant.

PRE-WIRED SOLDERLESS LED INTERCONNECTIONS

Material Specifications:

- Panel connector socket and ring: thermoplastic
- Header connector: thermoplastic (UL Listed materials)
- Terminals: phosphor bronze, tin plated
- Wire: 24AWG, 7 strand copper, insulated
- For **Locking Header** use Mouser Stock No.: 538-22-23-2021
- For **Plain Header** use Mouser Stock No.: 538-22-03-2021

Electrical Specifications:

- Terminal: 3A continuous service
- Unique three-finger design mates to round, square, or rectangular leads .017" to .025"

Insert LED into connector. Install lens in panel opening. Press connector and lens together.

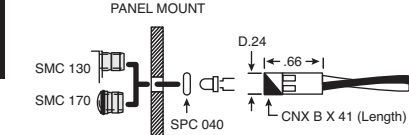
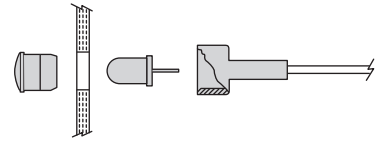

3mm Bi-Lead LED

For quantities of 1000 and up, call for quote.

MOUSER STOCK NO.	Length: in.	Price Each			
		1	10	100	500
.025" Header Post					
593-CNXBE4104	4	1.88	1.69	1.50	1.35
593-CNXBE4108	8	1.88	1.69	1.50	1.35
593-CNXBE4112	12	2.02	1.82	1.61	1.45
593-CNXBE4118	18	2.16	1.94	1.73	1.55
593-CNXBE4124	24	2.30	2.07	1.84	1.65
Stripped Ends					
593-CNXBX4104	4	1.32	1.17	1.06	.96
593-CNXBX4108	8	1.32	1.17	1.06	.96
593-CNXBX4112	12	1.46	1.29	1.18	1.07
593-CNXBX4118	18	1.55	1.39	1.24	1.11
593-CNXBX4124	24	1.69	1.52	1.35	1.22

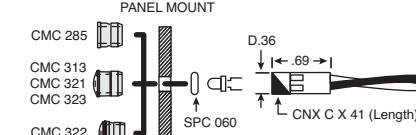

5mm Bi-Lead LED

For quantities of 1000 and up, call for quote.

MOUSER STOCK NO.	Length: in.	Price Each			
		1	10	100	500
.025" Header Post					
593-CNXCE4104	4	1.88	1.69	1.50	1.35
593-CNXCE4108	8	1.88	1.69	1.50	1.35
593-CNXCE4112	12	2.02	1.82	1.61	1.45
593-CNXCE4118	18	2.16	1.94	1.73	1.55
593-CNXCE4124	24	2.30	2.07	1.84	1.65
Stripped Ends					
593-CNXCX4104	4	1.32	1.17	1.06	.96
593-CNXCX4108	8	1.32	1.17	1.06	.96
593-CNXCX4112	12	1.46	1.29	1.18	1.07
593-CNXCX4118	18	1.55	1.39	1.24	1.11
593-CNXCX4124	24	1.69	1.52	1.35	1.22

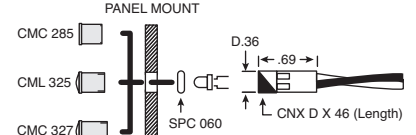

5mm Tri-Lead LED

For quantities of 1000 and up, call for quote.

MOUSER STOCK NO.	Length: in.	Price Each			
		1	10	100	500
.025" Header Post					
593-CNXDF4604	4	2.67	2.41	2.14	1.92
593-CNXDF4608	8	2.67	2.41	2.14	1.92
593-CNXDF4612	12	2.96	2.66	2.36	2.13
593-CNXDF4618	18	3.19	2.87	2.55	2.30
593-CNXDF4624	24	3.38	3.04	2.70	2.43
Stripped Ends					
593-CNXDX4604	4	1.74	1.56	1.39	1.25
593-CNXDX4608	8	1.74	1.56	1.39	1.25
593-CNXDX4612	12	2.02	1.82	1.61	1.45
593-CNXDX4618	18	2.25	2.03	1.80	1.62
593-CNXDX4624	24	2.44	2.20	1.95	1.76

LOW PROFILE PANEL MOUNTS AND LENS FOR PBC MOUNTED LEDS

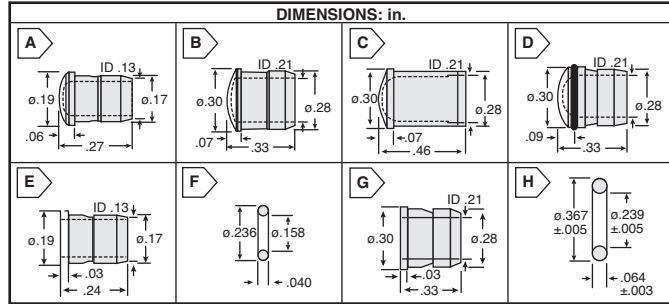

Low Profile Fresnel Lens

For quantities of 1000 and up, call for quote.

MOUSER STOCK NO.	VCC Part No.	Fig.	Lens Color	Price Each			
				1	10	100	500
T1 (3mm), Mounting Hole 0.171"							
593-1700R	SMC170RTP	A	Red	.28	.24	.21	.17
593-1700A	SMC170ATP	A	Amber	.28	.24	.21	.17
593-1700Y	SMC170YTP	A	Yellow	.28	.24	.21	.17
593-1700G	SMC170GTP	A	Green	.28	.24	.21	.17
593-1700B	SMC170BTP	A	Blue	.28	.24	.21	.17
593-1700C	SMC170CTP	A	Clear	.28	.24	.21	.17
T1-3/4 (5mm), Mounting Hole 0.281"							
593-3210R	CMC321RTP	B	Red	.30	.26	.23	.19
593-3210A	CMC321ATP	B	Amber	.30	.26	.23	.19
593-3210Y	CMC321YTP	B	Yellow	.30	.26	.23	.19
593-3210G	CMC321GTP	B	Green	.30	.26	.23	.19
593-3210B	CMC321BTP	B	Blue	.30	.26	.23	.19
593-3210C	CMC321CTP	B	Clear	.30	.26	.23	.19
593-3250C	CML325CTP	C	Clear	.30	.26	.23	.19

Low Profile Diffused Lens

For quantities of 1000 and up, call for quote.

MOUSER STOCK NO.	VCC Part No.	Fig.	Lens Color	Price Each			
				1	10	100	500
T1-3/4 (5mm), Mounting Hole 0.281"							
593-3130RTP	CMC313RTP	D	Red	.30	.26	.23	.19
593-3130ATP	CMC313ATP	D	Amber	.30	.26	.23	.19
593-3130YTP	CMC313YTP	D	Yellow	.30	.26	.23	.19
593-3130GTP	CMC313GTP	D	Green	.30	.26	.23	.19
593-3130BTP	CMC313BTP	D	Blue	.30	.26	.23	.19
593-3130CTP	CMC313CTP	D	Clear	.30	.26	.23	.19
T1-3/4 (5mm), Moisture Seal, Mounting Hole 0.281"							
593-3220R	CMS322RTP	D	Red	.94	.82	.71	.59
593-3220A	CMS322ATP	D	Amber	.94	.82	.71	.59
593-3220Y	CMS322YTP	D	Yellow	.94	.82	.71	.59
593-3220G	CMS322GTP	D	Green	.94	.82	.71	.59
593-3220B	CMS322BTP	D	Blue	.94	.82	.71	.59
593-3220C	CMS322CTP	D	Clear	.94	.82	.71	.59

Low Profile Plain End Lens

For quantities of 1000 and up, call for quote.

T1-3/4 (5mm), Mounting Hole 0.281"							
593-3230C	CMC323CTP	B	Clear	.30	.26	.23	.19
593-3270C	CML327CTP	C	Clear	.30	.26	.23	.19

Mounts and Spacers

For quantities of 1000 and up, call for quote.

MOUSER STOCK NO.	VCC Part No.	Fig.	Description	Price Each			
				1	10	100	500
3mm							
593-SMC130CTP	SMC130CTP	E	T1 Clear	.20	.18	.15	.13
593-SMC130BLK	SMC130BLK	E	T1 Black	.15	.13	.11	.09
593-SPC040	SPC040	F	T1 Spacer	.09	.08	.07	.06
5mm							
593-CMC285CTP	CMC285CTP	G	T1-3/4 Clear	.28	.24	.21	.17
593-CMC285BLK	CMC285BLK	G	T1-3/4 Black	.17	.15	.13	.11
593-SPC060	SPC060	H	T1-3/4 Spacer	.09	.08	.07	.06

SOLDERLESS LED CONNECTORS

1/4W Current limiting resistor built into the natural polypropylene housing. 1/2W Resistor can be built upon request. Terminals are phosphor bronze, tin plated.

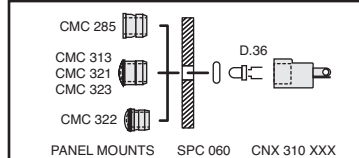
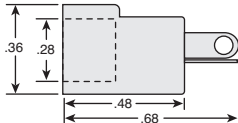

MOUSER STOCK NO.	Resistance Value (Ω)	Price Each			
		1	10	100	500
593-CNX310000	No resistor	.62	.52	.42	.36
593-CNX310033	330	.98	.83	.69	.59
593-CNX310056	560	.98	.83	.69	.59
593-CNX310120	1.2K	.98	.83	.69	.59
593-CNX310220	2.2K	.98	.83	.69	.59

PRESS-FIT MOISTURE SEALED LITEPIPE® ASSEMBLY

Features:

- Exceeds NEMA 4 rating
- 180° viewing angle for LEDs
- Panel Mount independent of circuit board

Installation:

593-RNG268 Must be used. Pass assembly through the panel opening and press retaining ring to secure unit to panel. Slide PCB into position aligning LED with end of the LITEPIPE® unit.

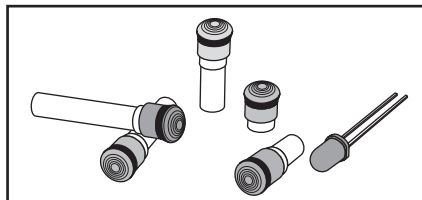

MOUSER STOCK NO.	VCC Part No.	Color	Litepipe Length: in.	Price Each			
				1	10	100	500
593-LMS033RTP	LMS033RTP	Red	0.33	1.31	1.18	1.08	1.03
593-LMS033GTP	LMS033GTP	Green	0.33	1.31	1.18	1.08	1.03
593-LMS033CTP	LMS033CTP	Clear	0.33	1.31	1.18	1.08	1.03
593-LMS053RTP	LMS053RTP	Red	0.53	1.31	1.18	1.08	1.03
593-LMS053GTP	LMS053GTP	Green	0.53	1.31	1.18	1.08	1.03
593-LMS053CTP	LMS053CTP	Clear	0.53	1.31	1.18	1.08	1.03
593-LMS133RTP	LMS133RTP	Red	1.33	1.31	1.18	1.08	1.03
593-LMS133GTP	LMS133GTP	Green	1.33	1.31	1.18	1.08	1.03
593-LMS133CTP	LMS133CTP	Clear	1.33	1.31	1.18	1.08	1.03