

SERIAL ATA (SATA) COMBO RECEPTACLES

Specifications:

- High density serial data transmission at 1.5 to 3.0 Gb/sec.
- Compliant with SATA 1.0a standard
- Signal and power combined device I/O
- 2 differential pairs signal (7 pins)
- 3 different voltage levels of power (15 pins)
- Combined signal/power receptacle for direct device plug-up
- Guide pegs for blind mate
- First-Make-Last-Break for hot plugging capability
- No. of Positions: 22

- Temperature Range: 260°C max for 10 seconds
- Color: Black
- Contact Material: Cu Alloy
- Contact Resistance: 15 mΩ Max
- Current Rating: 1.5 A @ 30°C
- Voltage Rating: 500 VAC
- Durability: 500 Mating Cycles
- Housing Material: Thermoplastic UL94V-0
- Insulation Resistance: 1000 MΩ Min
- RoHS Compliant per FCI documentation



RoHS Compliant

For quantities of 200 and up, call for quote.

MOUSER STOCK NO.	FCI Part No.	Fig.	Termination	Contact Plating	Retention Feature	Price Each			
						1	25	50	100
Vertical Inline Receptacles									
649-10017660-001LF	10017660-001LF	A	Through Hole	12µ" Gold	ForkLock/Harpoon	3.02	2.47	2.34	2.24
649-10029065-001LF	10029065-001LF	A	Surface Mount	12µ" Gold	SMT Pad	2.64	2.27	2.13	2.02
649-10045103-001LF	10045103-001LF	A	Surface Mount	12µ" Gold	Peg for Rivet	4.83	3.83	3.67	3.50
649-10022676-001LF	10022676-001LF	A	Press Fit	12µ" Gold	ForkLock/Harpoon	3.02	2.47	2.34	2.24
649-10043820-001LF	10043820-001LF	A	Cable Solder Tab	30µ" Gold	Back Cover/Overmold	2.33	2.00	1.91	1.74
Right Angle Inline Receptacles									
649-10031569-001LF	10031569-001LF	B	Surface Mount	12µ" Gold	ForkLock	1.50	1.32	1.24	1.17
649-10029364-001LF	10029364-001LF	B	Surface Mount	30µ" Gold	ForkLock/Harpoon	2.31	1.94	1.89	1.71
649-10034814-001LF	10034814-001LF	B	Surface Mount	30µ" Gold	ForkLock/Harpoon	4.95	3.93	3.74	3.59

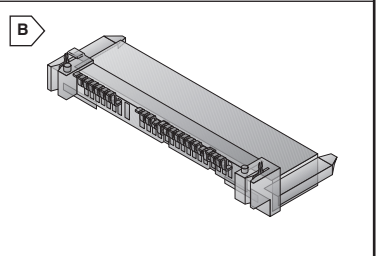
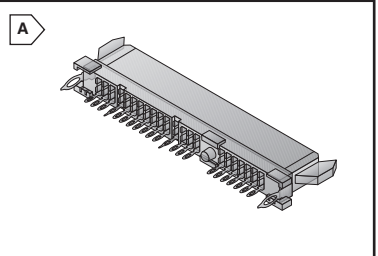

E-SATA CONNECTORS

FCI's eSATA products are aimed at external storage applications that require a single-lane Serial ATA cable connection up to approximately two meters in length. The connectors comply with the Serial ATA Specification issued by the Serial ATA International Organization (SATA-IO).

Features:

- Compliant with eSATA requirements in Serial ATA Specification
- Supports Gen 1 (1.5Gb/s) and Gen 2 (3Gb/s) data rates
- Provide external data backup and protection at up to 3Gb/s data transfer rate

Specifications:

- Housing Material: Glass filled LCP (UL94 V-0), Black
- Current rating: 1.5 A per contact



RoHS Compliant

For quantities of 200 and up, call for quote.

MOUSER STOCK NO.	FCI Part No.	Fig.	No. of Contacts	Contact Plating	Retention Feature	Price Each			
						1	25	50	100
E-SATA+USB									
649-10069848-001RLF	10069848-001RLF	C	11	15µ" Gold	Fork Style Metal Clip	2.37	2.03	1.92	1.81
E-SATA+USB Reverse Type									
649-10086118-001RLF	10086118-001RLF	C	11	15µ" Gold	Fork Style Metal Clip	2.53	2.14	1.92	1.85

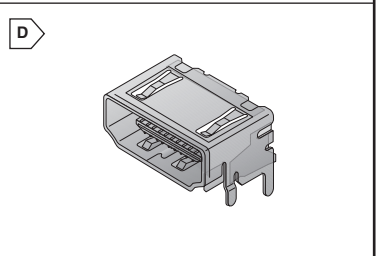
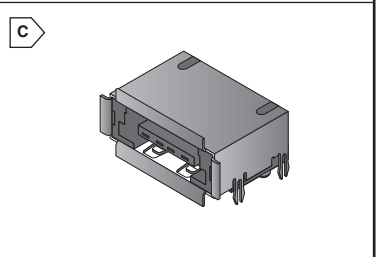

HDMI CONNECTORS

- Type A receptacle meets HDMI spec1.1
- Metal shield for better EMI
- Speed to 5Gbps uncompressed single transmit rate
- Backward compatible with DVI
- Low impedance mismatch
- No. of Positions: 19
- Contact Base Material: Copper alloy
- Contact Resistance: 30Ω max.
- Voltage Rating: 40 VAC max.
- Durability: 10,000 mating cycles

- Housing Material: High-temp resin
- Insulation Resistance: 100 MΩ
- Withstanding Voltage: 500 VAC
- Color: Black
- Operating Temperature: -55°C to +85°C
- Solder Tail Plating: Pure Sn
- Recommended PCB thickness: 1.6mm
- Contact Current Rating: 0.5A min.
- RoHS Compliant per FCI documentation



RoHS Compliant

For quantities of 200 and up, call for quote.

MOUSER STOCK NO.	FCI Part No.	Fig.	Termination	Contact Plating	Mounting Flange	Price Each			
						1	25	50	100
649-10029449-001RLF	10029449-001RLF	D	Surface Mount	30µ" Gold	No	.71	.61	.58	.54
649-10029449-002TLF	10029449-002TLF	E	Surface Mount	30µ" Gold	Yes	.71	.61	.58	.54

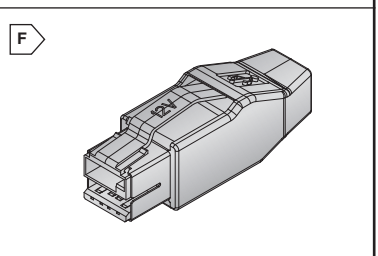
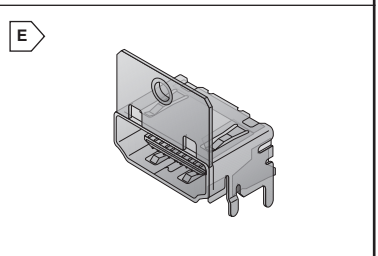

USB CONNECTORS

- USB 2.0 compliant, speed to 480 Mb/sec
- Housing Material: Glass fiber filled thermoplastic, UL94V-0
- RoHS Compliant per FCI documentation



RoHS Compliant

For quantities of 200 and up, call for quote.

MOUSER STOCK NO.	FCI Part No.	Fig.	Termination	USB Style	Housing Color	Price Each			
						1	25	50	100
Straight Plug Kits									
649-74233-101LF	74233-101LF	F	--	Type A Power	Teal	10.23	7.57	7.22	6.96
649-74233-102LF	74233-102LF	F	--	Type A Power	Teal	10.23	7.57	7.22	6.96
Right Angle Receptacles									
649-72309-8034BLF	72309-8034BLF	--	Through Hole	Type A	White	1.00	.93	.87	.82
649-87520-0010BLF	87520-0010BLF	--	Through Hole	Type A	White	.45	.41	.39	.37
649-61729-0010BLF	61729-0010BLF	--	Through Hole	Type B	White	.58	.53	.51	.49
649-61729-0011BLF	61729-0011BLF	--	Through Hole	Type B	White	1.60	.82	.79	.76
649-61729-1010BLF	61729-1010BLF	--	Through Hole	Type B	Black	.72	.64	.61	.58
Flag Type Receptacle									
649-73725-0110BLF	73725-0110BLF	--	Through Hole	Type A	White	.54	.50	.48	.44
Mini-USB Receptacle									
649-10033526N3212MLF	10033526N3212MLF	G	Surface Mount	Type B	Black	1.04	.63	.558	.504

