

# DBM REFLEX Lenses for High Power LEDs



**RoHS Compliant** This product is RoHS compliant.

HI-POWER LEDs

## LENSES FOR OSRAM - GOLDEN DRAGON

### Specifications:

- Secondary optic for the Osram-Golden Dragon LEDs
- Optical grade PMMA lens material allows use of high current and temperature conditions
- Epoxy or Polyurethane adhesive can be used to fasten the lens to PCB
- Note - Not made to handle cyanoacrylate (superglue) adhesive

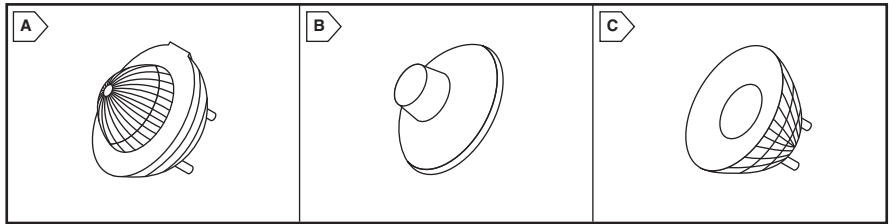

For quantities of 1000 and up, call for quote.

MOUSER STOCK NO.	DBM Reflex Part No.	Fig.	Beam Type	Half Angle Divergence	Curve Type	Diameter	Material	Operating Temperature	Price Each			
									1	50	100	500
735-O-001	O-001	A	Wide	29 deg	Flat	13mm	PMMA HT	-40°C+110°C	2.26	2.03	1.86	1.70
735-O-002	O-002	A	Very Narrow	6 deg	Peak	13mm	PMMA HT	-40°C+110°C	2.26	2.03	1.86	1.70
735-O-002S	O-002s	A	Very Narrow	6 deg	Peak	13mm	PMMA HT	-40°C+110°C	2.26	2.03	1.86	1.70
735-O-003	O-003	A	Medium	16 deg	Peak	13mm	PMMA HT	-40°C+110°C	2.26	2.03	1.86	1.70
735-O-003S	O-003s	A	Medium	18 deg	Flat	13mm	PMMA HT	-40°C+110°C	2.26	2.03	1.86	1.70
735-O-004	O-004	B	Side Emitting	--	--	18mm	PMMA HT	-40°C+110°C	2.26	2.03	1.86	1.70
735-O-005	O-005	C	Very Narrow	6 deg	Peak/Flat	14.5mm	PMMA	-40°C+90°C	2.26	2.03	1.86	1.70
735-O-005S	O-005s	C	Very Narrow	5 deg	Peak/Flat	14.5mm	PMMA	-40°C+90°C	2.26	2.03	1.86	1.70
735-O-006	O-006	C	Medium	15 deg	Peak	14.5mm	PMMA	-40°C+90°C	2.26	2.03	1.86	1.70
735-O-007	O-007	C	Wide	30 deg	Peak	14.5mm	PMMA	-40°C+90°C	2.26	2.03	1.86	1.70

## LENSES FOR CITIZEN - ORION CL - L100

### Specifications:

- Secondary optic for the Citizen CL-L100 LEDs
- Optical grade PMMA lens material allows use of high current and temperature conditions
- Epoxy or Polyurethane adhesive can be used to fasten the lens to PCB
- Note - Not made to handle cyanoacrylate (superglue) adhesive

DIMENSIONS: mm

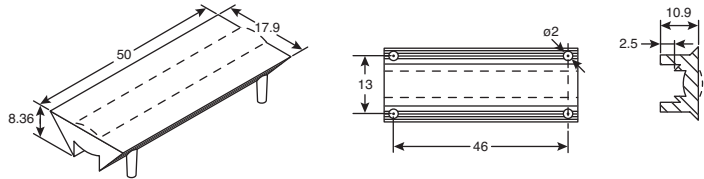

For quantities of 1000 and up, call for quote.

MOUSER STOCK NO.	DBM Reflex Part No.	Beam Type	Half Angle Divergence	Curve Type	Dimensions	Material	Operating Temperature	Price Each			
								1	50	100	500
735-C-001	C-001	Wide	30 deg	Flat	50mm x 17mm	PMMA HT	-40°C+110°C	2.92	2.63	2.41	2.19
735-C-002	C-002	Narrow	6 deg	Peak	50mm x 17mm	PMMA HT	-40°C+110°C	2.92	2.63	2.41	2.19
735-C-003	C-003	Medium	15 deg	Flat	50mm x 17mm	PMMA HT	-40°C+110°C	2.92	2.63	2.41	2.19

## LENSES FOR LUMILED - LUXEON REBEL

### Specifications:

- Secondary optic for the Lumiled-Luxeon LEDs
- Optical grade PMMA lens material allows use of high current and temperature conditions
- Epoxy or Polyurethane adhesive can be used to fasten the lens to PCB
- Note - Not made to handle cyanoacrylate (superglue) adhesive

DIMENSIONS: mm



For quantities of 1000 and up, call for quote.

MOUSER STOCK NO.	DBM Reflex Part No.	Beam Type	Half Angle Divergence	Curve Type	Diameter	Material	Operating Temperature	Price Each			
								1	50	100	500
735-R-001	R-001	Wide	29 deg	Flat	18mm	PMMA HT	-40°C+110°C	2.32	2.09	1.91	1.74
735-R-001S	R-001s	Wide	28 deg	Flat	18mm	PMMA HT	-40°C+110°C	2.32	2.09	1.91	1.74
735-R-002	R-002	Narrow	11 deg	Peak	18mm	PMMA HT 121	-40°C+110°C	2.32	2.09	1.91	1.74
735-R-003	R-003	Very Narrow	5 deg	Peak	18mm	PMMA HT 121	-40°C+110°C	2.32	2.09	1.91	1.74
735-R-003S	R-003s	Very Narrow	7 deg	Peak	18mm	PMMA HT 121	-40°C+110°C	2.32	2.09	1.91	1.74
735-R-004	R-004	Medium	14 deg	Peak	18mm	PMMA HT	-40°C+110°C	2.32	2.09	1.91	1.74
735-R-004S	R-004s	Medium	11 deg	Peak	18mm	PMMA HT	-40°C+110°C	2.32	2.09	1.91	1.74
735-R-005	R-005	Side Emitting	--	--	18mm	PMMA HT	-40°C+110°C	2.32	2.09	1.91	1.74

## LENSES FOR NICHIA - NS6

### Specifications:

- Secondary optic for the Nichia-NS6 LEDs
- Optical grade PMMA lens material allows use of high current and temperature conditions
- Epoxy or Polyurethane adhesive can be used to fasten the lens to PCB
- Note - Not made to handle cyanoacrylate (superglue) adhesive

DIMENSIONS: mm

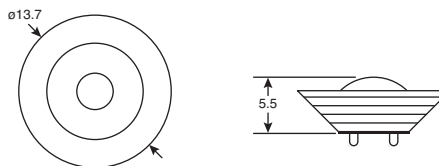

For quantities of 1000 and up, call for quote.

MOUSER STOCK NO.	DBM Reflex Part No.	Beam Type	Half Angle Divergence	Curve Type	Diameter	Material	Operating Temperature	Price Each			
								1	50	100	500
735-N-001	N-001	Wide	28 deg	Flat	13.7mm	PMMA	-40°C+90°C	2.26	2.03	1.86	1.70

DBM REFLEX

NEW SUPPLIER

NEW SUPPLIER

NEW SUPPLIER

NEW SUPPLIER