

# NXP SEMICONDUCTOR Diodes

RoHS Compliant This product is RoHS compliant.



Diodes & Rectifiers

NXP Semiconductor

## SMALL SIGNAL SCHOTTKY DIODES

For quantities of 250 and up, call for quote.

MOUSER STOCK NO.	NXP Part No.	Package	Configuration	V <sub>R</sub> max (V)	I <sub>F</sub> max (mA)	V <sub>F</sub> max (mV)	@ I <sub>F</sub> (mA)	I <sub>R</sub> max (μA)	@ V <sub>R</sub> (V)	Price Each		
										1	25	100
771-BAT754S-T/R	BAT754S	SOT23	Dual Series	30	200	340	10	2	25	.31	.24	.20
771-BAT754C-T/R	BAT754C	SOT23	Dual Common Cathode	30	200	340	10	2	25	.22	.19	.16
771-BAS85-T/R	BAS85	SOD80	Single	30	200	400	10	2	25	.11	.09	.053
771-BAT85-T/R	BAT85	SOD68	Single	30	200	400	10	2	25	.21	.18	.15
771-BAT54-T/R	BAT54	SOT23	Single	30	200	400	10	2	25	.05	.042	.04
771-BAT54H-T/R	BAT54H	SOD123	Single	30	200	400	10	2	25	.21	.18	.12
771-BAT54W-T/R	BAT54W	SOT323	Single	30	200	400	10	2	25	.14	.12	.082
771-1PS76SB10-T/R	1PS76SB10	SOD323	Single	30	200	400	10	2	25	.20	.17	.13
771-BAT54S-T/R	BAT54S	SOT23	Dual Series	30	200	400	10	2	25	.08	.07	.065
771-BAT54SW-T/R	BAT54SW	SOT323	Dual Series	30	200	400	10	2	25	.17	.15	.101
771-BAT54C-T/R	BAT54C	SOT23	Dual Common Cathode	30	200	400	10	2	25	.12	.08	.065
771-BAT54CW-T/R	BAT54CW	SOT323	Dual Common Cathode	30	200	400	10	2	25	.13	.10	.08
771-BAT54A-T/R	BAT54A	SOT23	Dual Common Anode	30	200	400	10	2	25	.12	.08	.065
771-BAT54AW-T/R	BAT54AW	SOT323	Dual Common Anode	30	200	400	10	2	25	.10	.09	.078
771-BAT74-T/R	BAT74	SOT143	Dual Isolated	30	200	400	10	2	25	.25	.20	.15
771-BAT54XY-T/R	BAT54XY	SOT363	Dual-Dual Series	30	200	400	10	2	25	.35	.31	.25
771-PMEG3002AEL-T/R	PMEG3002AEL	SOD882	Single	30	200	300	10	30	10	.24	.20	.171
771-BAS40H-T/R	BAS40H	SOD123	Single	40	120	500	10	1	30	.25	.21	.19
771-BAS40L315	BAS40L315	SOD882	Single	40	120	500	10	1	30	.20	.18	.169
771-BAS40-04-T/R	BAS40-04	SOT23	Dual Series	40	120	500	10	1	30	.08	.06	.05
771-BAS40-04W-T/R	BAS40-04W	SOT323	Dual Series	40	120	500	10	1	30	.31	.25	.213
771-BAT721S-T/R	BAT721S	SOT23	Dual Series	40	200	300	10	15	30	.45	.37	.279
771-BAT721C-T/R	BAT721C	SOT23	Dual Common Cathode	40	200	300	10	15	30	.45	.37	.279
771-BAT721A-T/R	BAT721A	SOT23	Dual Common Anode	40	200	300	10	15	30	.30	.26	.214
771-PMEG4002EL-T/R	PMEG4002EL	SOD882	Single	40	200	360	10	0.5	25	.27	.20	.171
771-BAS86-T/R	BAS86	SOD80	Single	50	200	450	10	5	40	.25	.21	.19
771-BAS70-T/R	BAS70	SOT23	Single	70	70	750	10	0.1	50	.07	.06	.05
771-BAS70-04-T/R	BAS70-04	SOT23	Dual Series	70	70	750	10	0.1	50	.17	.13	.097
771-BAS70-04W-T/R	BAS70-04W	SOT323	Dual Series	70	70	750	10	0.1	50	.31	.24	.20
771-BAS70-05-T/R	BAS70-05	SOT23	Dual Common Cathode	70	70	750	10	0.1	50	.11	.09	.081
771-BAS70-06-T/R	BAS70-06	SOT23	Dual Common Anode	70	70	750	10	0.1	50	.11	.09	.081
771-BAS70-07-T/R	BAS70-07	SOT143	Dual Isolated	70	70	750	10	0.1	50	.27	.21	.177

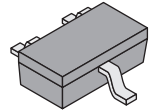

SOT23/SOT323

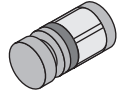

SOD80/SOD87

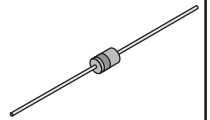

SOD68

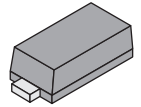

SOD123/SOD523

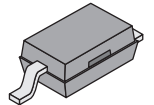

SOD323

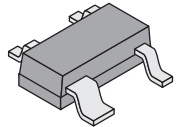

SOT143

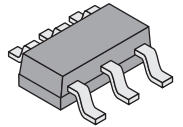

SOT363/SOT457

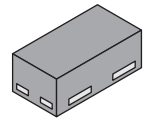

SOD882

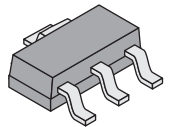

SOT223

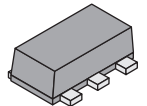

SOT666

## LOW VF SCHOTTKY DIODES

For quantities of 250 and up, call for quote.

MOUSER STOCK NO.	NXP Part No.	Package	Configuration	Features	I <sub>F</sub> max (A)	V <sub>R</sub> max (V)	V <sub>F</sub> max (mV) @ I <sub>F</sub> max	I <sub>R</sub> max (mA) @ V <sub>R</sub> max	Price Each		
									1	25	100
771-PMEG3002AEB-T/R	PMEG3002AEB	SOD523	Single	Low VF/Low IR	0.2	30	480	0.05	.21	.18	.161
771-PMEG3002AEL-T/R	PMEG3002AEL	SOD882	Single	Low VF/Low IR	0.2	30	480	0.05	.24	.20	.171
771-PMEG4002EL-T/R	PMEG4002EL	SOD882	Single	Low VF/Low IR	0.2	40	600	0.01	.27	.20	.171
771-PMEG2005ET215	PMEG2005ET215	SOT23	Single	Low VF/Low IR	0.5	20	390	0.2	.26	.20	.16
771-PMEG2005EH-T/R	PMEG2005EH	SOD123	Single	Low VF/Low IR	0.5	20	390	0.2	.26	.20	.191
771-PMEG2005EJ115	PMEG2005EJ115	SOD323	Single	Low VF/Low IR	0.5	20	390	0.2	.26	.20	.191
771-PMEG3005ET-T/R	PMEG3005ET	SOT23	Single	Low VF/Low IR	0.5	30	430	0.15	.26	.20	.16
771-PMEG3005EH-T/R	PMEG3005EH	SOD123	Single	Low VF/Low IR	0.5	30	430	0.15	.26	.20	.191
771-PMEG3005EJ-T/R	PMEG3005EJ	SOD323	Single	Low VF/Low IR	0.5	30	430	0.15	.26	.20	.191
771-PMEG4005ET-T/R	PMEG4005ET	SOT23	Single	Low VF/Low IR	0.5	40	470	0.1	.26	.20	.16
771-PMEG4005EH-T/R	PMEG4005EH	SOD123	Single	Low VF/Low IR	0.5	40	470	0.1	.26	.20	.191
771-PMEG4005EJ-T/R	PMEG4005EJ	SOD323	Single	Low VF/Low IR	0.5	40	470	0.1	.26	.20	.191
771-PMEG2010AEH-T/R	PMEG2010AEH	SOD123	Single	Very Low VF	1	20	430	0.2	.18	.14	.12
771-PRLL5817-T/R	PRLL5817	SOD87	Single	Very Low VF	1	20	450	1	.31	.27	.24
771-PMEG2010ET-T/R	PMEG2010ET	SOT23	Single	Low VF/Low IR	1	20	500	0.2	.18	.14	.12
771-PMEG2010EH115	PMEG2010EH115	SOD123	Single	Low VF/Low IR	1	20	500	0.2	.18	.14	.12
771-PMEG2010EJ-T/R	PMEG2010EJ	SOD323	Single	Low VF/Low IR	1	20	500	0.2	.18	.14	.12
771-PMEG2010EA-T/R	PMEG2010EA	SOD323	Single	Very Low IR	1	20	550	0.05	.18	.14	.12
771-PMEG2010AEJ-T/R	PMEG2010AEJ	SOD323	Single	Very Low IR	1	20	550	0.05	.18	.14	.12
771-BAT120C115	BAT120C115	SOT223	Dual Common Cathode	Very Low VF	1	25	450	1	.88	.78	.60
771-PMEG3010CEJ-T/R	PMEG3010CEJ	SOD323	Single	Very Low IR	1	30	520	0.05	.18	.14	.12
771-PRLL5818-T/R	PRLL5818	SOD87	Single	Very Low VF	1	30	550	1	.31	.27	.24
771-PMEG3010ET-T/R	PMEG3010ET	SOT23	Single	Low VF/Low IR	1	30	560	0.15	.18	.14	.12
771-PMEG3010EH-T/R	PMEG3010EH	SOD123	Single	Low VF/Low IR	1	30	560	0.15	.18	.14	.12
771-PMEG3010EJ115	PMEG3010EJ115	SOD323	Single	Low VF/Low IR	1	30	560	0.15	.18	.14	.12
771-PRLL5819-T/R	PRLL5819	SOD87	Single	Very Low VF	1	40	600	1	.31	.27	.24
771-PMEG4010ET215	PMEG4010ET215	SOT23	Single	Low VF/Low IR	1	40	640	0.1	.18	.14	.12
771-PMEG4010EH-T/R	PMEG4010EH	SOD123	Single	Low VF/Low IR	1	40	640	0.1	.18	.14	.12
771-PMEG4010EJ-T/R	PMEG4010EJ	SOD323	Single	Low VF/Low IR	1	40	640	0.1	.18	.14	.12
771-PMEG4010CEH-T/R	PMEG4010CEH	SOD123	Single	Very Low IR	1	40	570	0.05	.18	.14	.12
771-PMEG4010CEJ-T/R	PMEG4010CEJ	SOD323	Single	Very Low IR	1	40	570	0.05	.18	.14	.12
771-PMEG6010AED115	PMEG6010AED115	SOT457	Single	Low VF/Low IR	1	60	650	0.35	.18	.14	.12
771-PMEG6010CEH-T/R	PMEG6010CEH	SOD123	Single	Very Low IR	1	60	710	0.1	.18	.14	.12
771-PMEG6010CEJ-T/R	PMEG6010CEJ	SOD323	Single	Very Low IR	1	60	710	0.1	.18	.14	.12
771-PMEG2015EH-T/R	PMEG2015EH	SOD123	Single	Low VF/Low IR	1.5	20	660	0.2	.18	.14	.12
771-PMEG3015EH-T/R	PMEG3015EH	SOD123	Single	Very Low VF	1.5	30	550	1	.18	.14	.12
771-PMEG3015EJ115	PMEG3015EJ115	SOD323	Single	Very Low VF	1.5	30	550	1	.18	.14	.12
771-PMEG1020EH-T/R	PMEG1020EH	SOD123	Single	Very Low VF	2	10	460	3	.18	.14	.12
771-PMEG1020EJ-T/R	PMEG1020EJ	SOD323	Single	Very Low VF	2	10	460	3	.18	.14	.12
771-PMEG1020EV115	PMEG1020EV115	SOT666	Single	Very Low VF	2	10	460	3	.18	.14	.12
771-PMEG2020EH-T/R	PMEG2020EH	SOD123	Single	Very Low VF	2	20	525	0.2	.18	.14	.12
771-PMEG2020AEA-T/R	PMEG2020AEA	SOD323	Single	Very Low VF	2	20	525	0.2	.18	.14	.12
771-PMEG2020EJ-T/R	PMEG2020EJ	SOD323	Single	Very Low VF	2	20	525	0.2	.18	.14	.12
771-PMEG3020EH-T/R	PMEG3020EH	SOD123	Single	Very Low VF	2	30	620	1	.18	.14	.12
771-PMEG3020EJ-T/R	PMEG3020EJ	SOD323	Single	Very Low VF	2	30	620	1	.18	.14	.12
771-PMEG1030EH-T/R	PMEG1030EH	SOD123	Single	Very Low VF	3	10	530	3	.34	.29	.238
771-PMEG1030EJ-T/R	PMEG1030EJ	SOD323	Single	Very Low VF	3	10	530	3	.34	.29	.238

