

BUD Cabinet Racks and Enclosures



VALURACK CABINET RACKS

"Shipped Factory Direct"

- EIA-310 compliant for 19" panel width equipment
- Provisions for additional fully adjustable panel mounting rails
- Top accepts Bud #FN-1282 Exhaust Fan
- Suggested 700# equipment load capacity (higher when used with adjustable panel mounting rails for 4-point equipment mounting)
- Finish: Black Texture
- Sturdy welded-together construction
- One pair of integral full height panel mounting rails with EIA universal spaced mounting holes
- Panel mounting rails are located in the front of the cabinet and are recessed 1.00"
- Large 10.00" square hole in the bottom of the cabinet, along with 1.11" diameter knockouts for cable access
- Bottom of cabinet pierced for use with casters or levelers

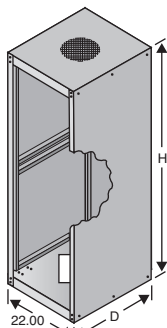

Contact a Mouser Service Representative for other sizes, colors, and for modified versions.

Accessories:

- Uses most standard Bud accessories (all standard accessories when used with adjustable panel mounting rails)

Mounting Rails

MOUSER STOCK NO.	Bud Part No.	Dimensions: in.				Price Each	MOUSER STOCK NO.	Price Each
		H	D	Panel Space	Inside Depth			
563-VR-8924	VR-8924	65.56	26.00	61.25	24.00	512.34	563-PMR-9452	92.20
563-VR-8925	VR-8925	75.31	26.00	70.00	24.00	576.02	563-PMR-9453	100.80
563-VR-8926	VR-8926	78.75	26.00	78.75	24.00	668.60	563-PMR-9454	106.85

SERIES 2000 CABINET RACKS

"Shipped Factory Direct"

Design Features:

- Anodized aluminum extrusion top trim
- All welded 14 gauge steel frame with "U" shaped 16 gauge steel panel mounting rail supports
- Door, 20 gauge steel
- Accommodates 19" wide E.I.A. panels
- Bottom pierced for RC-7758 casters
- 1.109 inch diameter knockout holes in base
- 1200# equipment load capacity
- Sides and top, 18 gauge steel
- Shipped completely assembled
- Add-A-Rack System used to combine two or more enclosures into one integral system

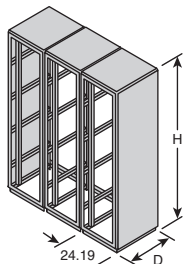

There are two colors available, replace the () in the part number with: **GT** for Gray Textured or **RB** for Royal Blue Textured. Available in other Bud textured finishes at no extra cost.

MOUSER STOCK NO.	Bud Part No.	Dimensions: in.			Price Each
		H	D	Panel Space	
With plain sides and plain rear doors:					
563-E-2000	E-2000	30.25	23.87	21.00	991.90
563-E-2003	E-2003	51.25	23.87	42.00	1197.85
563-E-2004	E-2004	61.75	23.87	52.50	1322.73
563-E-2005	E-2005	70.50	23.87	61.25	1447.30
563-E-2006	E-2006	79.25	23.87	70.00	1518.10
563-E-2007	E-2007	88.00	23.87	78.75	1646.46
563-E-2008	E-2008	30.25	27.37	21.00	1005.38
563-E-2011	E-2011	51.25	27.37	42.00	1261.68
563-E-2012	E-2012	61.75	27.37	52.50	1416.27
563-E-2013	E-2013	70.50	27.37	61.25	1498.20
563-E-2014	E-2014	79.25	27.37	70.00	1551.97
563-E-2015	E-2015	88.00	27.37	78.75	1680.43
563-E30-2000	E30-2000	30.25	32.62	21.00	1079.77
563-E30-2003	E30-2003	51.25	32.62	42.00	1314.76
563-E30-2004	E30-2004	61.75	32.62	52.50	1468.14
563-E30-2005	E30-2005	70.50	32.62	61.25	1563.23
563-E30-2006	E30-2006	79.25	32.62	70.00	1678.92
563-E30-2007	E30-2007	88.00	32.62	78.75	1791.38

SLOPING PANEL CABINETS

Hinged top opens completely for access to components mounted on chassis.

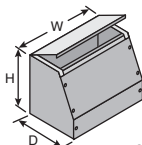

Finish: Metallic Gray

For quantities of 25 and up, call for quote.

MOUSER STOCK NO.	Bud Part No.	Dimensions: in.			Chassis to Fit	Price Each			
		D	W	H		1	2	5	10
563-C-1584	C-1584	7.31	7.06	6.50	AC-402	69.30	52.20	47.47	45.05
563-C-1585	C-1585	7.31	9.06	6.50	AC-405	66.80	50.18	46.39	43.43
563-C-1586	C-1586	7.31	11.06	6.50	AC-1413	78.35	58.78	52.46	50.90
563-C-1587	C-1587	8.00	8.06	8.00	AC-405	75.40	56.74	52.28	49.02
563-C-1588	C-1588	8.00	10.06	8.00	AC-406	83.80	62.96	56.14	54.47
563-C-1892	C-1892	8.50	13.06	8.00	AC-407	93.32	83.97	74.84	72.61
563-C-1893	C-1893	10.50	18.06	10.00	AC-415	137.62	123.87	110.48	107.19
563-C-1894	C-1894	8.00	14.06	8.00	AC-409	85.12	76.59	71.09	66.24
563-C-1896	C-1896	8.18	18.06	9.00	AC-1416	118.42	106.60	95.00	92.18

NEMA SHEET METAL BOXES

14 Gauge Steel with Mounting Brackets

Design Features:

- Made from durable 14 ga. steel. Designed to meet NEMA 1, 2, 4, 4X, 12, 13 and IP65 and UL508-4X ratings. Hinged cover clamps to base with stainless screws and brackets for a watertight seal. Also comes with a 14 gauge steel, powder-coated removable inner panel.

Finish: Gray Powder Coat

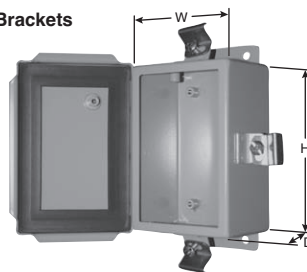

For quantities of 25 and up, call for quote.

MOUSER STOCK NO.	Bud Part No.	Dimensions: in.			Price Each			
		D	W	H	1	5	10	25
563-SN-3700	SN-3700	4.00	6.00	3.00	40.70	34.45	30.60	28.70
563-SN-3701	SN-3701	6.00	8.00	3.50	55.20	41.40	36.80	35.88
563-SN-3702	SN-3702	6.00	6.00	4.00	50.70	38.03	33.76	32.96
563-SN-3703	SN-3703	10.00	12.00	5.00	89.50	67.13	59.71	58.18
563-SN-3704	SN-3704	8.00	10.00	6.00	84.80	63.57	56.49	55.13
563-SN-3705	SN-3705	12.00	12.00	6.00	104.60	78.45	69.77	67.99
563-SN-3706	SN-3706	12.00	14.00	6.00	114.10	85.58	76.03	74.17
563-SN-3707	SN-3707	14.00	16.00	6.00	136.30	102.25	90.87	88.60
563-SN-3708	SN-3708	12.00	14.00	8.00	130.00	97.50	86.63	84.50
563-SN-3709	SN-3709	14.00	16.00	10.00	168.00	126.00	111.96	109.20

PLASTIBOX™

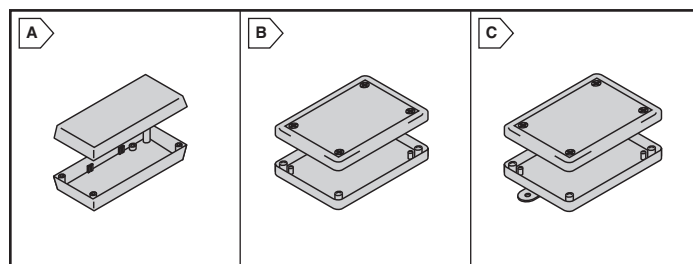

Style F:

- Has squared corners and provisions for mounting horizontal and vertical PCBs
- UL94-HB flammability rating
- Temperature rating: -40°C to +80°C
- Available in Black or Gray

Style H:

- Has rounded corners and edges and provisions for mounting horizontal PCBs
- UL94-5VA flammability rating
- Temperature rating: -20°C to +70°C
- Available with molded-in external wall mounting brackets
- Available in Black (other colors available upon request)

For quantities of 25 and up, call for quote.

MOUSER STOCK NO.	Bud Part No.	Fig.	Color	Style	Outside Dim.: in. H x W x D	Price Each			
						1	5	10	25
563-PS-11521-B	PS-11521-B	A	Black	F	3.62 x 2.25 x 1.01	3.10	2.60	2.47	2.35
563-PS-11521-G	PS-11521-G	A	Gray	F	3.62 x 2.25 x 1.01	3.10	2.59	2.47	2.34
563-PT-11557-B	PT-11557-B	A	Black	F	6.87 x 4.87 x 2.52	7.20	5.99	5.69	5.39
563-PT-11557-G	PT-11557-G	A	Gray	F	6.87 x 4.87 x 2.52	7.20	5.99	5.69	5.39
563-PBS-11532-B	PBS-11532-B	A	Black	F	4.37 x 3.25 x 1.52	5.20	4.35	3.90	3.50
563-PBS-11532-G	PBS-11532-G	A	Gray	F	4.37 x 3.25 x 1.52	5.20	4.35	4.34	4.13
563-PS-11533-B	PS-11533-B	A	Black	F	4.37 x 3.25 x 1.52	4.80	4.00	3.80	3.60
563-PS-11533-G	PS-11533-G	A	Gray	F	4.37 x 3.25 x 1.52	4.80	3.99	3.79	3.60
563-PS-11543-B	PS-11543-B	A	Black	F	5.62 x 3.25 x 1.52	5.50	4.60	4.37	4.15
563-PS-11543-G	PS-11543-G	A	Gray	F	5.62 x 3.25 x 1.52	5.50	4.59	4.37	4.15
563-PS-11553-B	PS-11553-B	A	Black	F	6.87 x 4.87 x 1.52	6.80	5.65	5.37	5.10
563-PS-11553-G	PS-11553-G	A	Gray	F	6.87 x 4.87 x 1.52	6.80	5.65	5.37	5.09
563-PT-11630	PT-11630	B	Black	H	4.00 x 2.00 x 1.12	6.10	5.10	4.85	4.60
563-PT-11642	PT-11642	B	Black	H	4.25 x 2.62 x 1.25	7.20	5.99	5.69	5.39
563-PT-11653	PT-11653	B	Black	H	5.62 x 3.25 x 1.12	7.80	6.49	6.17	5.84
563-PT-11657	PT-11657	B	Black	H	5.62 x 3.25 x 1.38	7.70	6.45	5.79	5.50
563-PT-11664	PT-11664	B	Black	H	6.00 x 4.00 x 1.12	8.50	7.09	6.74	6.40
563-PT-11668	PT-11668	B	Black	H	6.00 x 4.00 x 1.50	8.10	6.74	6.42	6.10
563-PT-11630-MB	PT-11630-MB	C	Black	H	4.00 x 2.00 x 1.12	6.10	5.10	4.85	4.60
563-PT-11642-MB	PT-11642-MB	C	Black	H	4.25 x 2.62 x 1.25	7.20	5.99	5.69	5.39
563-PT-11653-MB	PT-11653-MB	C	Black	H	5.62 x 3.25 x 1.12	7.80	6.49	6.17	5.84
563-PT-11657-MB	PT-11657-MB	C	Black	H	5.62 x 3.25 x 1.38	7.70	6.45	6.09	5.79
563-PT-11664-MB	PT-11664-MB	C	Black	H	6.00 x 4.00 x 1.12	8.50	7.09	6.74	6.40
563-PT-11668-MB	PT-11668-MB	C	Black	H	6.00 x 4.00 x 1.50	8.10	6.74	6.42	6.10

HEAVY GAUGE STEEL POLE MOUNT BRACKETS

Specifications:

- Zinc plated bracket with dichromate sealer
- Stainless Steel band clamps
- Quick Adjust Band clamps allow for reduced installation time
- All mounting hardware supplied with kit
- Allows Bud NEMA boxes to be mounted to round or rectangular poles

For quantities of 25 and up, call for quote.

MOUSER STOCK NO.	Bud Part No.	Color	Price Each			
			1	2	5	10
563-BPM-22260	BPM-22260	No Color	76.50	63.88	60.82	57.76
563-BPM-22261	BPM-22261	No Color	109.00	91.02	86.66	82.30