

BUD Rack and Cabinet Accessories

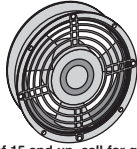

BUD 10" EXHAUST FAN

Fan mounts in the top of ventilated Economizer racks. Supplied with finger guard and all mounting hardware. 36" power cord supplied. UL/CSA rated with 535 CFM air flow.



For quantities of 15 and up, call for quote.

MOUSER STOCK NO.	Bud Part No.	Price Each			
		1	3	5	10
563-FN-1282	FN-1282	134.70	130.20	125.70	120.33

BUD 4.5" EXHAUST FAN

Fan mounts in FT-1170 Fan Tray or can be used individually in other applications. Supplied with one hardware cloth finger guard. UL approved.



For quantities of 15 and up, call for quote.

MOUSER STOCK NO.	Bud Part No.	Price Each			
		1	3	5	10
563-FN-1280	FN-1280	37.50	28.15	26.25	25.13

BUD FAN TRAY ASSEMBLY

Includes:

- 9-position fan tray with preassembled front panel
- 9-outlet daisy chain cord
- 6 foot power cord

Material:

- Fan tray and support angles: 16-gauge steel
- Front panel: 12-gauge steel

Finish:

- Fan tray and front panels: White Texture or Metallic Gray

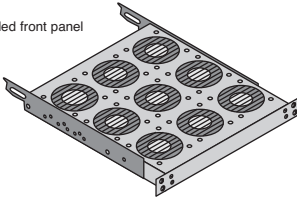

Use with Bud Fans/FN-1280

For quantities of 15 and up, call for quote.

MOUSER STOCK NO.	Bud Part No.	Price Each			
		1	3	5	10
563-FN-1170-WH	FT-1170-WH	176.63	164.85	153.08	145.42
563-FN-1170-MG	FT-1170-MG	176.65	170.75	164.85	157.79

BUD BLOWERS

The lowest silhouette height with the highest CFM output in the industry. Blowers exit air out the back; also, up and out of the top of racks, cabinets or consoles.

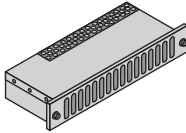

For quantities of 15 and up, call for quote.

MOUSER STOCK NO.	Bud Part No.	Panel Height (In.)	Air CFM	Price Each			
				1	3	5	10
563-B-60	B-60	3.50	160.00	470.66	448.25	426.90	406.58
563-B-62	B-62	5.25	300.00	529.65	512.00	494.35	459.03

BUD TEM-STAT TEMPERATURE CONTROLS

Prevention of shut-downs caused by over-heating of electronic or electrical equipment in enclosures in enclosures with DIN rails.



- Temperature Range: 32°F - 140°F
- Max Tolerance: ±7.2°F
- Service Life: 100,000 cycles

For quantities of 50 and up, call for quote.

MOUSER STOCK NO.	Bud Part No.	Price Each			
		1	5	10	25
563-TS-16	TS-16	30.60	25.55	24.33	23.10

BUD STEM LEVELERS

Nickel Plated Steel. 3/8-16 Thread. 563-RL-7767 furnished with 2 height adjusting nuts. For quantities of 50 and up, call for quote.

MOUSER STOCK NO.	Bud Part No.	Base	Price Each			
			1	5	10	25
563-RL-7766	RL-7766	Rubber	6.70	5.60	5.05	4.50
563-RL-7767	RL-7767	Nylon	4.60	3.80	3.40	3.05
563-RL-7771	RL-7771	Rubber	5.00	4.15	3.75	3.30

BUD EQUIPMENT MOUNTING SCREWS

10-32 x .62" Phillips steel machine screw. For mounting panels

MOUSER STOCK NO.	Bud Part No.	Price Each		
		1	5	10
563-7346	7346	.10	.09	.088

BUD CASTERS

Castors are priced, sold, and packaged as pairs with all necessary mounting hardware included.

Extra-Heavy Duty

For Series 60 and Economizer cabinet racks. Ball-bearing wheels made of hard tread composition. Height: 3.25"

For quantities of 15 and up, call for quote.

MOUSER STOCK NO.	Bud Part No.	Load Rating	Price Per Pair			
			1	3	5	10
563-RC-7758	RC-7758	200 lbs.	32.90	24.65	21.90	21.39



Extra-Heavy Duty

Ball-Bearing, Swivel Type

Wheels hard tread rubber 4" in diameter x 1.25" wide. Available with or without side brake.

Increase overall height of cabinet by approximately 4".

For quantities of 50 and up, call for quote.

With Locking Brake		Load Rating	Price Per Pair			
MOUSER STOCK NO.	Bud Part No.		1	3	5	10
563-RC-7761	RC-7761	240 lbs.	77.50	64.60	58.15	51.70
Without Locking Brake		Load Rating	Price Per Pair			
MOUSER STOCK NO.	Bud Part No.		1	3	5	10
563-RC-7762	RC-7762	240 lbs.	67.00	55.85	50.25	44.70

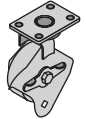

Ball-Bearing, Swivel Type

BUD RUBBER AND PLASTIC FEET

For quantities of 500 and up, call for quote.

MOUSER STOCK NO.	Bud Part No.	Description	Price Each			
			1	5	10	25
563-F-3581	F-3581	.50" sq. x .21" high rubber feet with self-adhesive backing	.40	.36	.33	.32
563-F-3599	F-3599	.81" sq. x .31" high rubber feet with self-adhesive backing	.60	.55	.50	.475
563-F-7264-A	F-7264-A	.75" dia. x .37" high plastic feet with mounting hardware	.60	.55	.50	.475
563-F-7800-A	F-7800-A	.87" dia. x .50" high plastic feet with mounting hardware	.60	.55	.50	.475
563-F-8038	F-8038	.75" dia. x .12" thick self-adhesive rubber pad	.16	.14	.13	.126
563-F-9653	F-9653	Press-fit rubber feet fit into .43" dia. hole.	1.00	.91	.83	.803

BUD HINGED PATCH PANEL BRACKETS

Design Features:

These wall or rack mounted brackets accommodate all popular patch panel sizes and allow ready access to the rear of the panel.

Features:

- Wall or 19" rack mountable.
- Heavy duty 16 gauge steel construction.
- Welded on heavy duty hinge.
- EIA spaced panel mounting holes.
- Three cable access knockouts in back panel.

Finish:

Black Texture (BT)

For quantities of 50 and up, call for quote.

MOUSER STOCK NO.	Bud Part No.	Depth (in.)	Panel Space (in.)	Price Per Pair			
				1	5	10	25
563-HWB-1790	HWB-1790	5.00	3.50	46.00	38.41	34.56	30.71
563-HWB-1792	HWB-1792	5.00	7.00	56.00	46.76	42.11	37.41
563-HWB-2790	HWB-2790	8.00	3.50	32.10	30.50	29.21	27.82

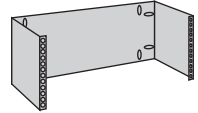

BUD STANDARD PANELS

"Surface Shield" Panels, SFA Series Mill finish .18" thick aluminum alloy. White pressure-sensitive paper on one side protects and provides surface for laying out drilling or punching position

Standard Aluminum Panels, PA Series .12" aluminum alloy Three colors available. Replace the () with: WH for White Texture MG for Metallic Gray BT for Black Texture

For all cabinets, cabinet racks, relay racks, and small enclosures, where applicable. 19" Width

For quantities of 5 and up, call for quote.

Panel Height (in.)	MOUSER STOCK NO.	Bud Part No.	Price Each	MOUSER STOCK NO.	Bud Part No.	Price Each
3.50	563-SFA-1832	SFA-1832	13.90	563-PA-1102-__	PA-1102-__	18.20
5.25	563-SFA-1833	SFA-1833	17.80	563-PA-1103-__	PA-1103-__	25.00
7.00	563-SFA-1834	SFA-1834	22.80	563-PA-1104-__	PA-1104-__	31.10
8.75	563-SFA-1835	SFA-1835	25.00	563-PA-1105-__	PA-1105-__	37.60
10.50	563-SFA-1836	SFA-1836	32.40	563-PA-1106-__	PA-1106-__	47.70
12.25	563-SFA-1837	SFA-1837	37.50	563-PA-1107-__	PA-1107-__	52.30
14.00	563-SFA-1838	SFA-1838	42.40	563-PA-1108-__	PA-1108-__	67.00
15.75	563-SFA-1839	SFA-1839	47.80	563-PA-1109-__	PA-1109-__	74.50
17.50	563-SFA-1840	SFA-1840	52.60	563-PA-1110-__	PA-1110-__	82.94
19.25	563-SFA-1841	SFA-1841	58.40	563-PA-1111-__	PA-1111-__	87.70
21.00	563-SFA-1842	SFA-1842	63.90	563-PA-1112-__	PA-1112-__	91.05

BUD RACKMOUNT POWER OUTLET STRIPS

- Standard 19" EOA rack mountable
- Utilizes 1U (1.75") panel height
- Lighted power switch
- Black steel housing
- UL recognized
- Surge suppressed
- 15 Amp, 125 Volt rating
- 15 foot power cord
- 8 outlets

For quantities of 15 and up, call for quote.

MOUSER STOCK NO.	Bud Part No.	Description	Price Each			
			1	3	5	10
563-POS-194-S	POS-194-S	Rear Outlet Location	53.55	52.15	50.59	50.05
563-POS-195-S	POS-195-S	Front Outlet Location	57.75	53.90	51.59	50.05

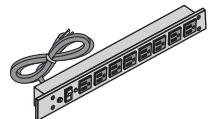

BUD SURGE SUPPRESSED POWER OUTLET STRIPS

Provides protection to data or word processing equipment and other sensitive electrical equipment from sudden spikes or high energy voltage. Prevents equipment damage, lost or distorted data. Maximum surge current is 13000 amps, response time is <5ns. 15 amp thermal type, circuit breaker with reset. 14 gauge, 3 wire, 6 foot power cord, all components UL approved.

For quantities of 15 and up, call for quote.

MOUSER STOCK NO.	Bud Part No.	No. of Outlets	Length (in.)	Price Each			
				1	5	10	25
563-POS-66	POS-66	6	12.25	68.90	64.35	61.57	59.74
563-POS-7-S	POS-7-S	7	48.00	89.75	83.70	80.13	77.74
563-POS-9-S	POS-9-S	9	60.00	97.00	90.50	86.63	84.05
563-POS-11-S	POS-11-S	11	72.00	102.25	95.40	91.32	88.60

