

BUD Sliding Drawers, Shelves and Accessories

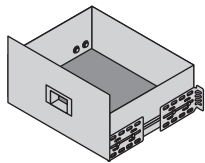

BUD SLIDING DRAWER

Fits cabinets with 19" panel width. Front panel height, 8.75". Supports heavy loads even when fully extended. Requires two pairs of panel mounting rails per cabinet rack.



There are three colors available, replace the () in the part number with: **WH** for White Textured, **BT** for Black Textured, or **MG** for Metallic Gray

For quantities of 15 and up, call for quote.

MOUSER STOCK NO.	Bud Part No.	Inside Dimensions (In.)	Price Each			
			1	3	5	10
563-D-1722-__	D-1722-__	16.56 x 6.31 x 16.18	248.35	248.35	223.51	198.67
563-D-1723-__	D-1723-__	16.56 x 6.31 x 19.18	257.85	257.85	232.09	206.27

BUD SLIDING DESKTOP

Requires only 1.75" panel space. Working area, 12" x 15.75". Supports 50 lbs., plastic laminated surface. Ball-bearing slide mechanism. Locks in open position. Top surface is antique white. Requires two pairs of panel mounting rails per cabinet rack.

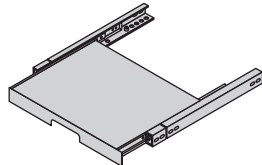

Three panel finishes available, replace the () in the part number with: **WH** for White Textured, **BT** for Black Textured, or **MG** for Metallic Gray

For quantities of 15 and up, call for quote.

MOUSER STOCK NO.	Bud Part No.	Surface Width	Area Depth (In.)	Panel (In.)	Price Each			
					1	3	5	10
563-GO-2361-__	60-2361-__	15.75	15.37	19 x 1.75	160.83	150.10	143.64	139.37

BUD DESK TOP DRAWER

Front panel height, 3.5". Hinged drawer top has plastic laminate bonded to Aluminum. Requires two pairs of panel mounting rails per cabinet rack. Supports 92 lbs.

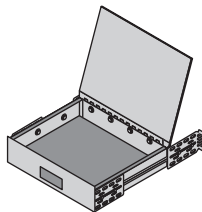

There are three colors available, replace the () in the part number with: **WH** for White Textured, **BT** for Black Textured, or **MG** for Metallic Gray

For quantities of 15 and up, call for quote.

MOUSER STOCK NO.	Bud Part No.	Inside Dimensions (In.)	Price Each			
			1	3	5	10
563-DD-2363-__	DD-2363-__	16.87 x 13.87 x 3	251.80	251.80	235.00	224.92

BUD SLIDING SHELVES

Sliding shelves, available in ventilated and non-ventilated versions, fit 19" wide panel spaces and all cabinet rack depths. Shelves 16-gauge steel and flanged on all four sides for added support. Universal mounting brackets allow flexibility in mounting. Shelves allow sufficient room in rear for cables and power outlet strips. Requires two pairs of panel mounting rails per cabinet rack. Finish: Smooth Black

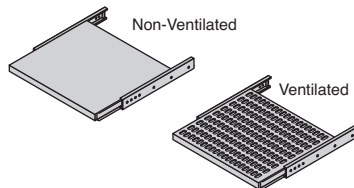

For quantities of 15 and up, call for quote.

MOUSER STOCK NO.	Bud Part No.	Cabinet Racks (In.)		Shelves (In.)			Price Each			
		Panel Width	Max. Clear Inside Depth	Width	Depth	Travel	1	5	10	25
Ventilated										
563-SH-2391	SH-2391	19.00	17.00	17.90	14.25	8.00	102.45	95.70	95.70	91.59
563-SH-2392	SH-2392	19.00	20.50	17.90	17.75	12.00	109.70	102.50	102.50	98.09
563-SH-2393	SH-2393	19.00	24.00	17.90	21.25	15.00	115.25	107.65	107.65	103.05
563-SH-2394	SH-2394	19.00	29.25	17.90	26.50	19.00	124.40	116.20	116.20	111.22
Non-Ventilated										
563-SH-2387	SH-2387	19.00	17.00	17.90	14.25	8.00	100.55	93.95	93.95	89.91
563-SH-2388	SH-2388	19.00	20.50	17.90	17.75	12.00	107.90	100.80	100.80	96.48
563-SH-2389	SH-2389	19.00	24.00	17.90	21.25	15.00	113.40	105.90	105.90	101.37
563-SH-2390	SH-2390	19.00	29.25	17.90	26.50	19.00	122.50	114.45	114.45	109.55

BUD SLIDING KEYBOARD/MOUSE SHELF

Sliding keyboard shelf fits 19" and 23" panel width racks. Mouse pad slides out from underneath the shelf in either the right or left side. Takes up 2-U (3.5") of panel space. Includes all mounting hardware.

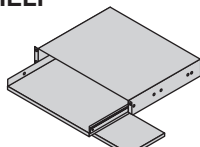

There are two colors available, replace the () in the part number with: **BT** for Black Textured or **MG** for Metallic Gray

For quantities of 15 and up, call for quote.

MOUSER STOCK NO.	Bud Part No.	Panel Width (In.)	Max. Keyboard Width (In.)	Price Each			
				1	3	5	10
563-KS-1785-__	KS-1785-__	19.00	16.50	165.33	148.78	132.28	128.70
563-KS-1787-__	KS-1787-__	23.00	20.50	174.87	163.43	145.28	141.38

BUD SLIDING KEYBOARD SHELF

Sliding shelf fits into any 19" panel width cabinet or rack yet still accepts all standard PC and most custom keyboards up to 23" wide. Ample storage space for keyboards, mouse and manuals. Convenient adjustable mouse and/or notepad panel. Finish: Black

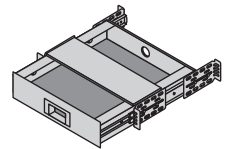

For quantities of 15 and up, call for quote.

MOUSER STOCK NO.	Bud Part No.	Panel Width (In.)	Max. Keyboard Width (In.)	Price Each			
				1	3	5	10
563-KS-1788	KS-1788	19.00	23.00	163.30	152.55	145.99	141.64

BUD SLIDING MECHANISMS

Each of these Zinc Plated, Alloy Steel telescoping and linear motion mechanisms consists of an outer member, inner member, ball retainer and ball bearings. All types offer a smooth, precise telescoping movement with long service life. Requires two pairs of panel mounting rails per cabinet rack.

* Load rating shown in table is "per pair"

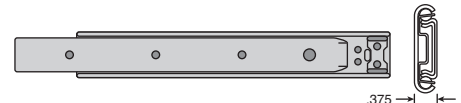

DIMENSIONS: in.

Two-Piece Slide

3/4 extension, front disconnect, positive stop. Max. chassis width 2.00" less than rack panel width, when used with BAS-5106 Slide Mounting Bracket Kit.

For quantities of 50 and up, call for quote.

MOUSER STOCK NO.	Bud Part No.	Slide Length	Travel	*Load Rating (lbs.)	Price per Pair			
					1	5	10	25
563-AS-5000-A	AS-5000-A	12.00"	8.00"	140	25.45	22.90	20.35	19.83
563-AS-5001-A	AS-5001-A	16.00"	12.00"	120	33.50	31.15	26.80	26.07
563-AS-5002-A	AS-5002-A	20.00"	15.00"	92	35.09	31.60	28.09	26.30
563-AS-5004-A	AS-5004-A	26.00"	19.00"	70	38.75	34.90	31.00	30.16

Three-Piece Slide

Full extension, front disconnect, positive stop. Max. chassis width 2.75" less than rack panel width, when used with BAS-5106 Slide Mounting Bracket Kit.

For quantities of 50 and up, call for quote.

MOUSER STOCK NO.	Bud Part No.	Slide Length	Travel	*Load Rating (lbs.)	Price per Pair			
					1	5	10	25
563-AS-5042-A	AS-5042-A	20.00"	20.87"	91.00	76.00	68.40	60.80	59.15

BUD SLIDE MOUNTING BRACKET KIT

Recommended for two-piece slides subject to maximum chassis width as shown above. It is easier to assemble. Allows slides to be mounted to panel mounting surface or accessory flange of panel mounting rails.

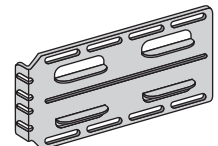

For quantities of 50 and up, call for quote.

MOUSER STOCK NO.	Bud Part No.	Price Each			
		1	5	10	25
563-BAS-5106	BAS-5106	25.56	23.01	20.46	19.18

BUD STANDARD PANEL MOUNTING RAILS

- 12 Gauge Steel
- Sold in pairs
- Finish: Black
- Rail Mounting Hardware included (Equipment Mounting Screws sold separately: Mouser No. 563-7346)

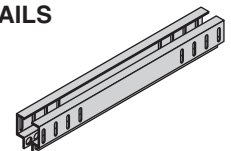

For quantities of 50 and up, call for quote.

MOUSER STOCK NO.	Bud Part No.	Fits Cabinet Rack with Panel Space	Price Per Pair			
			1	5	10	25
563-PMR-9448	PMR-9448	21.00"	60.30	54.25	48.25	46.93
563-PMR-2331	PMR-2331	24.50"	51.20	47.80	45.76	44.40
563-PMR-9449	PMR-9449	31.50"	68.65	61.80	54.90	53.43
563-PMR-9450	PMR-9450	42.00"	74.40	66.95	59.50	57.92
563-PMR-9451	PMR-9451	52.50"	82.45	74.20	65.95	64.16
563-PMR-9452	PMR-9452	61.25"	92.20	83.00	73.75	71.76
563-PMR-9453	PMR-9453	71.00"	100.80	90.70	80.65	78.46
563-PMR-9454	PMR-9454	78.75"	106.85	96.15	85.50	83.20

BUD L-SHAPED PANEL MOUNTING RAILS

- Installation of most servers
- Fits in all Bud cabinets
- E.I.A spaced holes use cage nuts (ordered separately) for secure equipment mounting
- Will accept all 19" E.I.A. rack mountable equipment
- Cage nuts: #12-24 (Mouser No. 563-307) or M6 (Mouser No. 563-581-DLH)
- 4 rails per pkg.

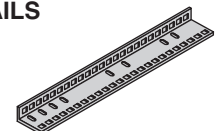

For quantities of 50 and up, call for quote.

MOUSER STOCK NO.	Bud Part No.	Fits Cabinet Rack with Panel Space	Price Per Package			
			1	5	10	25
563-PMR9483	PMR-9483	70"	169.35	135.50	131.89	125.29
563-PMR-9484	PMR-9484	78.75"	179.30	143.45	139.62	132.63