

QUALTEK Thermal Circuit Breakers

Qualtek ELECTRONICS CORPORATION

Primary Power Components Div.

RoHS Compliant This product is RoHS compliant.

QLB SERIES THERMAL CIRCUIT BREAKERS

Single Pole Push to Reset

Applications:

Cost effective for use in consumer products, home appliances, telecom, medical, toys, motors, power supplies, marine, power strips and transportation.

Specifications:

Certifications & Ratings:

- UL, cUL, TUV, CCC, CE 3A-40A @ 125/250VAC 32VDC

- Max Interrupting Capacity: 1,000 Amps
- Operating Temperature: -10°C to +60°C
- Bushing Type: Metal M11 x 1.0 thread or Plastic Snap-In
- Terminal Type: .250 quick connect tabs
- Reset Button: Black with white marked amp rating
- Mounting Method: Front Panel & Snap-In



For quantities of 250 and up, call for quote.

MOUSER STOCK NO.	Qualtek Part No.	Fig.	Current (A)	Price Each		
				1	50	100
Mounting Method - Snap-In with Plastic Bushing						
562-QLB03300DNN3BA	QLB-033-00DNN-3BA	A1	3	2.10	1.83	1.68
562-QLB05300DNN3BA	QLB-053-00DNN-3BA	A1	5	2.10	1.83	1.68
562-QLB07300DNN3BA	QLB-073-00DNN-3BA	A1	7	2.10	1.83	1.68
562-QLB10300DNN3BA	QLB-103-00DNN-3BA	A1	10	1.70	1.48	1.36
562-QLB15300DNN3BA	QLB-153-00DNN-3BA	A1	15	1.60	1.39	1.28
562-QLB20300DNN3BA	QLB-203-00DNN-3BA	A1	20	1.85	1.61	1.48
562-QLB25300DNN3BA	QLB-253-00DNN-3BA	A1	25	2.10	1.83	1.68
562-QLB30300DNN3BA	QLB-303-00DNN-3BA	A1	30	2.35	2.04	1.88
Mounting Method - Front Panel with Metal Bushing						
562-QLB03311B3N3BA	QLB-033-11B3N-3BA	A2	3	2.15	1.87	1.72
562-QLB05311B3N3BA	QLB-053-11B3N-3BA	A2	5	2.15	1.87	1.72
562-QLB07311B3N3BA	QLB-073-11B3N-3BA	A2	7	2.15	1.87	1.72
562-QLB10311B3N3BA	QLB-103-11B3N-3BA	A2	10	1.75	1.53	1.40
562-QLB15311B3N3BA	QLB-153-11B3N-3BA	A2	15	1.65	1.44	1.32
562-QLB20311B3N3BA	QLB-203-11B3N-3BA	A2	20	1.95	1.71	1.56
562-QLB25311B3N3BA	QLB-253-11B3N-3BA	A2	25	2.15	1.87	1.72
562-QLB30311B3N3BA	QLB-303-11B3N-3BA	A2	30	2.40	2.09	1.92

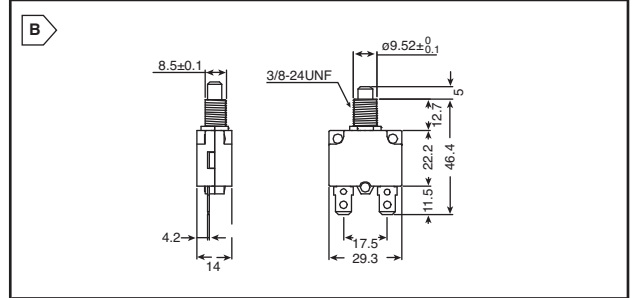
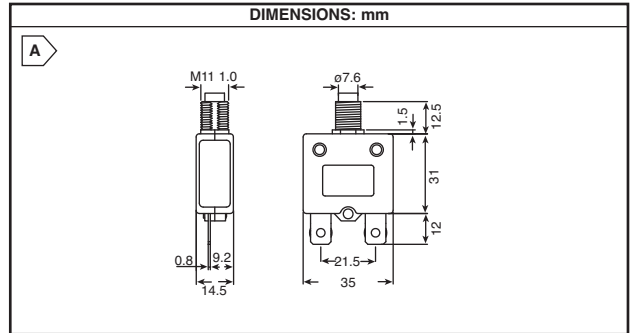

BUSHING ARRANGEMENT

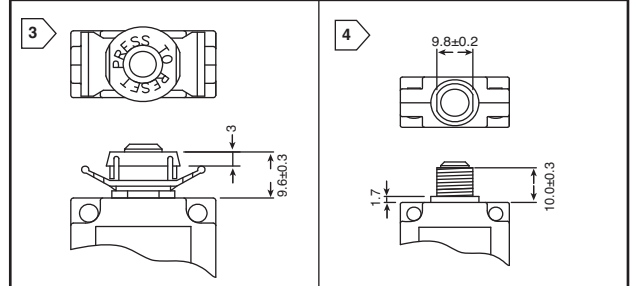
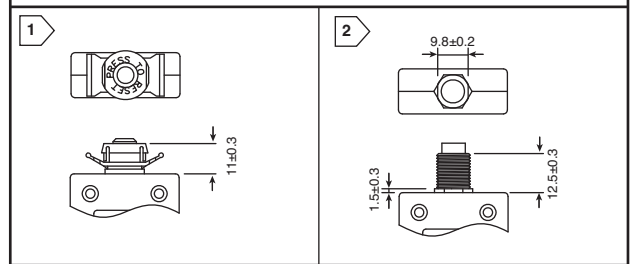

PANEL HOLE TYPE (MOUNTING METHOD)

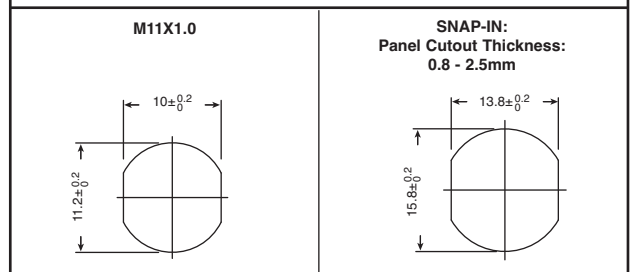

MOUNTING CAP TYPE: PLASTIC

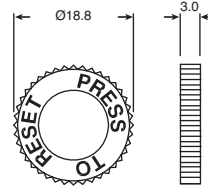

TERMINAL TYPE: STRAIGHT

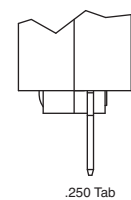

QMB SERIES THERMAL CIRCUIT BREAKERS

Single Pole Push to Reset

Applications:

Cost effective for use in consumer products, home appliances, telecom, medical, toys, motors, power supplies, marine, power strips and transportation.

Specifications:

Certifications & Ratings:

- UL, cUL, VDE, CCC, CE 3A-16A @ 125/250VAC 32VDC
- UL, cUL, TUV, CCC, CE 20A @ 125/250VAC 32VDC

- Max Interrupting Capacity: 1,000 Amps
- Operating Temperature: -10°C to +60°C
- Bushing Type: Plastic M11 x 1.0 thread or Snap-In
- Terminal Type: .250 quick connect tabs
- Reset Button: Black with white marked amp rating
- Mounting Method: Front Panel & Snap-In



For quantities of 250 and up, call for quote.

MOUSER STOCK NO.	Qualtek Part No.	Fig.	Current (A)	Price Each		
				1	50	100
Mounting Method - Snap-In with Plastic Bushing						
562-QMB03200ENN3BA	QMB-032-00ENN-3BA	B3	3	2.10	1.83	1.68
562-QMB05200ENN3BA	QMB-052-00ENN-3BA	B3	5	2.10	1.83	1.68
562-QMB07200ENN3BA	QMB-072-00ENN-3BA	B3	7	1.60	1.39	1.28
562-QMB10200ENN3BA	QMB-102-00ENN-3BA	B3	10	1.30	1.13	1.04
562-QMB12200ENN3BA	QMB-122-00ENN-3BA	B3	12	1.80	1.57	1.44
562-QMB15200ENN3BA	QMB-152-00ENN-3BA	B3	15	1.34	1.17	1.08
562-QMB20300ENN3BA	QMB-203-00ENN-3BA	B3	20	1.85	1.61	1.48
Mounting Method - Front Panel with Plastic Bushing						
562-QMB03211C3N3BA	QMB-032-11C3N-3BA	B4	3	2.25	1.96	1.80
562-QMB05211C3N3BA	QMB-052-11C3N-3BA	B4	5	2.25	1.96	1.80
562-QMB07211C3N3BA	QMB-072-11C3N-3BA	B4	7	1.70	1.48	1.36
562-QMB10211C3N3BA	QMB-102-11C3N-3BA	B4	10	1.40	1.22	1.12
562-QMB12211C3N3BA	QMB-122-11C3N-3BA	B4	12	1.83	1.59	1.46
562-QMB15211C3N3BA	QMB-152-11C3N-3BA	B4	15	1.43	1.24	1.14
*562-QMB20311C3N3BA	QMB-203-11C3N-3BA	B4	20	1.95	1.71	1.56