

ALPHA Rotary Switches



This product is RoHS compliant.



DIMENSIONS: mm

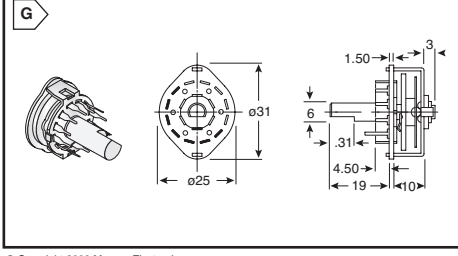
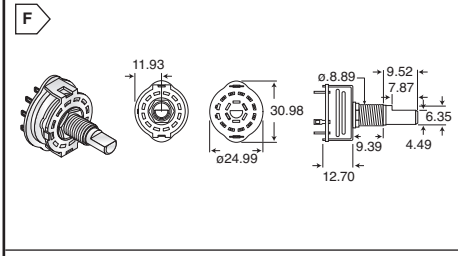
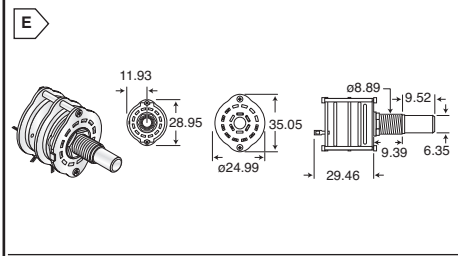
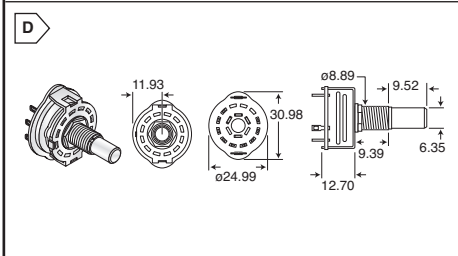
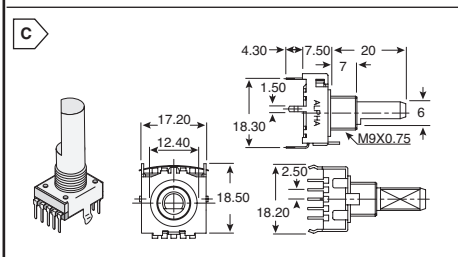
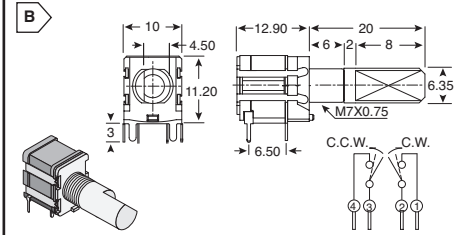
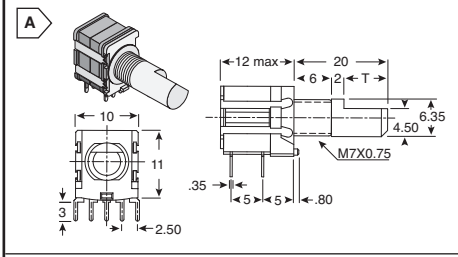

SR10010F SERIES

- Rating: 0.1A/16VDC
- Contact Resistance: 50mΩ max.
- Insulation Resistance: 100VDC-100MΩ min.
- Dielectric Strength: 100VAC for 1 minute
- Operating Life: 10000 cycles
- Shaft Type: 6.35mm D
- Timing: Non-shorting
- Terminals: PC mount

RoHS Compliant

For quantities of 2000 and up, call for quote.

MOUSER STOCK NO.	Alpha Part No.	Fig.	Poles	Positions	Shaft Length	Price Each				
						1	50	100	500	1000
105-SR10010F-16NS	SR10010F-0106-20F0B-C7-N	A	1	6	20mm	5.86	5.33	4.84	4.40	4.00
105-SR10010F-22NS	SR10010F-0202-20F0B-C7-N	A	2	2	20mm	5.86	5.33	4.84	4.40	4.00
105-SR10010F-23NS	SR10010F-0203-20F0B-C7-N	A	2	3	20mm	5.86	5.33	4.84	4.40	4.00
105-SR10010F-24NS	SR10010F-0204-20F0B-C7-N	A	2	4	20mm	5.86	5.33	4.84	4.40	4.00
105-SR10010F-25NS	SR10010F-0205-20F0B-C7-N	A	2	5	20mm	5.86	5.33	4.84	4.40	4.00

SR10030F SERIES

- Rating: 0.1A/16VDC
- Contact Resistance (initial performance/after lifetime): 50mΩ max./ 150mΩ max.
- Shaft Type: 6.35mm D
- Terminal: PC mount
- Rotational Torque: 153 ± 71gf.cm
- Mechanical Life: 30000 cycles
- Electrical Life: 10000 cycles
- Pulse Switch Operation: C.W.: 1 & 2 on during change over C.C.W.: 3 & 4 on during change over

RoHS Compliant

For quantities of 2000 and up, call for quote.

MOUSER STOCK NO.	Alpha Part No.	Fig.	Shaft Length	Price Each				
				1	50	100	500	1000
105-SR10030F-PS	SR10030F-20F0B-C7	B	20mm	6.40	5.82	5.29	4.81	4.37

SR1712F SERIES

- Rating: 0.3A/16VDC
- Contact Resistance: 50mΩ max.
- Insulation Resistance: 100VDC-100MΩ min.
- Dielectric Strength: 100VAC for 1 minute
- Operating Life: 10000 cycles
- Shaft Type: 6mm D
- Timing: Non-shorting
- Terminals: PC mount

RoHS Compliant

For quantities of 2000 and up, call for quote.

MOUSER STOCK NO.	Alpha Part No.	Fig.	Poles	Positions	Shaft Length	Price Each				
						1	50	100	500	1000
105-SR1712F-16NS	SR1712F-0106-20F0A-N9-9	C	1	6	20mm	4.54	3.78	3.44	3.13	2.88
105-SR1712F-18NS	SR1712F-0108-20F0A-N9-9	C	1	8	20mm	4.54	3.78	3.44	3.13	2.88
105-SR1712F-22NS	SR1712F-0202-20F0A-N9-9	C	2	2	20mm	4.54	3.78	3.44	3.13	2.88
105-SR1712F-23NS	SR1712F-0203-20F0A-N9-9	C	2	3	20mm	4.54	3.78	3.44	3.13	2.88
105-SR1712F-24NS	SR1712F-0204-20F0A-N9-9	C	2	4	20mm	4.54	3.78	3.44	3.13	2.88

SR2511F, SR2512F, AND SR2921F SERIES

- Rating: 0.3A/125VAC
- Contact Resistance: 50mΩ max.
- Insulation Resistance: 500VDC-100MΩ min.
- Dielectric Strength: 500VAC for 1 minute
- Rotational Torque: 1.0 ± 0.5Kg/cm

RoHS Compliant

For quantities of 2000 and up, call for quote.

MOUSER STOCK NO.	Alpha Part No.	Fig.	Poles	Positions	Shaft Length	Price Each				
						1	50	100	500	1000
Non-Shorting Round Shaft with Solder Terminals										
105-SR2511F-25NS	SR2511F-0205-19R0B-E9-N-W	D	2	5	19mm	2.77	2.32	2.11	1.92	1.76
105-SR2511F-26RN	SR2511F-0206-19R0B-E9-N-W	D	2	6	19mm	2.77	2.32	2.11	1.92	1.76
105-SR2511F-34NS	SR2511F-0304-19R0B-E9-N-W	D	3	4	19mm	2.77	2.32	2.11	1.92	1.76
105-SR2511F-43RN	SR2511F-0403-19R0B-E9-N-W	D	4	3	19mm	2.77	2.32	2.11	1.92	1.76
105-SR2511F-62RN	SR2511F-0602-19R0B-E9-N-W	D	6	2	19mm	2.77	2.32	2.11	1.92	1.76
105-SR2511F-12RN	SR2511F-0112-19R0B-E9-N-W	D	1	12	19mm	2.77	2.32	2.11	1.92	1.76
Non-Shorting Round Shaft with PCB Pins										
105-SR2512F-18NS	SR2512F-0108-19R0B-E9-N-W	D	1	8	19mm	2.77	2.32	2.11	1.92	1.76
105-SR2512F-25NS	SR2512F-0205-19R0B-E9-N-W	D	2	5	19mm	2.77	2.32	2.11	1.92	1.76
105-SR2512F-26NS	SR2512F-0206-19R0B-E9-N-W	D	2	6	19mm	2.77	2.32	2.11	1.92	1.76
105-SR2512F-34NS	SR2512F-0304-19R0B-E9-N-W	D	3	4	19mm	2.77	2.32	2.11	1.92	1.76
105-SR2512F-43NS	SR2512F-0403-19R0B-E9-N-W	D	4	3	19mm	2.77	2.32	2.11	1.92	1.76
105-SR2512F-62NS	SR2512F-0602-19R0B-E9-N-W	D	6	2	19mm	2.77	2.32	2.11	1.92	1.76
105-SR2512F-110NS	SR2512F-0110-19R0B-E9-N-W	D	1	10	19mm	2.77	2.32	2.11	1.92	1.76
105-SR2512F-112NS	SR2512F-0112-19R0B-E9-N-W	D	1	12	19mm	2.77	2.32	2.11	1.92	1.76
Shorting Round Shaft with Solder Terminals										
105-SR2511F-17S	SR2511F-0107-19R0B-E9-S-W	D	1	7	19mm	2.77	2.32	2.11	1.92	1.76
105-SR2511F-19S	SR2511F-0109-19R0B-E9-S-W	D	1	9	19mm	2.77	2.32	2.11	1.92	1.76
105-SR2511F-25S	SR2511F-0205-19R0B-E9-S-W	D	2	5	19mm	2.77	2.32	2.11	1.92	1.76
105-SR2511F-26S	SR2511F-0206-19R0B-E9-S-W	D	2	6	19mm	2.77	2.32	2.11	1.92	1.76
105-SR2511F-33S	SR2511F-0303-19R0B-E9-S-W	D	3	3	19mm	2.77	2.32	2.11	1.92	1.76
105-SR2511F-34S	SR2511F-0304-19R0B-E9-S-W	D	3	4	19mm	2.77	2.32	2.11	1.92	1.76
105-SR2511F-42S	SR2511F-0402-19R0B-E9-S-W	D	4	2	19mm	2.77	2.32	2.11	1.92	1.76
105-SR2511F-43S	SR2511F-0403-19R0B-E9-S-W	D	4	3	19mm	2.77	2.32	2.11	1.92	1.76
105-SR2511F-62S	SR2511F-0602-19R0B-E9-S-W	D	6	2	19mm	2.77	2.32	2.11	1.92	1.76
105-SR2511F-12S	SR2511F-0112-19R0B-E9-S-W	D	1	12	19mm	2.77	2.32	2.11	1.92	1.76
Shorting Round Shaft with Solder Terminals; 2 Decks										
105-SR2921F-17S	SR2921F-0107-19R0B-E9-S-W	E	1	7	19mm	4.40	3.67	3.34	3.04	2.80
105-SR2921F-12S	SR2921F-0112-19R0B-E9-S-W	E	1	12	19mm	4.40	3.67	3.34	3.04	2.80
105-SR2921F-25S	SR2921F-0205-19R0B-E9-S-W	E	2	5	19mm	4.40	3.67	3.34	3.04	2.80
105-SR2921F-26S	SR2921F-0206-19R0B-E9-S-W	E	2	6	19mm	4.40	3.67	3.34	3.04	2.80
105-SR2921F-34S	SR2921F-0304-19R0B-E9-S-W	E	3	4	19mm	4.40	3.67	3.34	3.04	2.80
Non-Shorting D-Shaft with Solder Terminals										
105-SR2511F-25FN	SR2511F-0205-19F0B-E9-N-W	F	2	5	19mm	2.77	2.32	2.11	1.92	1.76
105-SR2511F-26FN	SR2511F-0206-19F0B-E9-N-W	F	2	6	19mm	2.77	2.32	2.11	1.92	1.76
105-SR2511F-34FN	SR2511F-0304-19F0B-E9-N-W	F	3	4	19mm	2.77	2.32	2.11	1.92	1.76
105-SR2511F-43FN	SR2511F-0403-19F0B-E9-N-W	F	4	3	19mm	2.77	2.32	2.11	1.92	1.76
105-SR2511F-62FN	SR2511F-0602-19F0B-E9-N-W	F	6	2	19mm	2.77	2.32	2.11	1.92	1.76
105-SR2511F-12FN	SR2511F-0112-19F0B-E9-N-W	F	1	12	19mm	2.77	2.32	2.11	1.92	1.76

SR2513F SERIES

- Rating: 0.3A/125VAC
- Contact Resistance: 50mΩ max.
- Insulation Resistance: 500VDC-100MΩ min.
- Dielectric Strength: 500VAC for 1 minute
- Rotational Torque: 1.0 ± 0.5Kg/cm
- Shaft Type: 6mm D
- Timing: Non-shorting
- Terminals: PC mount

RoHS Compliant

For quantities of 2000 and up, call for quote.

MOUSER STOCK NO.	Alpha Part No.	Fig.	Poles	Positions	Shaft Length	Price Each				
						1	50	100	500	1000
105-SR2513F-110NS	SR2513F-0110-19F0A-T-N	G	1	10	19mm	1.61	1.34	1.22	1.11	1.02
105-SR2513F-112NS	SR2513F-0112-19F0A-T-N	G	1	12	19mm	1.61	1.34	1.22	1.11	1.02
105-SR2513F-24NS	SR2513F-0204-19F0A-T-N	G	2	4	19mm	1.61	1.34	1.22	1.11	1.02
105-SR2513F-25NS	SR2513F-0205-19F0A-T-N	G	2	5	19mm	1.61	1.34	1.22	1.11	1.02
105-SR2513F-26NS	SR2513F-0206-19F0A-T-N	G	2	6	19mm	1.61	1.34	1.22	1.11	1.02
105-SR2513F-34NS	SR2513F-0304-19F0A-T-N	G	3	4	19mm	1.61	1.34	1.22	1.11	1.02
105-SR2513F-43NS	SR2513F-0403-19F0A-T-N	G	4	3	19mm	1.61	1.34	1.22	1.11	1.02
105-SR2513F-62NS	SR2513F-0602-19F0A-T-N	G	6	2	19mm	1.61	1.34	1.22	1.11	1.02

