

# MILL-MAX DIP IC Sockets



Plating		
Code	Shell	Inner Contact
13	10µ" Gold	30µ" Gold
43	200µ" Tin (Matte Finish)	30µ" Gold
44	200µ" Tin (Matte Finish)	200µ" Tin (Matte Finish)

Plating		
Code	Shell	Inner Contact
93	200µ" Tin/Lead	30µ" Gold
99	200µ" Tin/Lead	100µ" Tin/Lead

## STANDARD LOW PROFILE IC SOCKETS WITH SCREW MACHINED SLEEVES

Features open frame design which leaves space beneath the IC for improved heat dissipation and easier PCB cleaning and inspection. 4 finger inner contact is stamped beryllium copper, press fitted into a precision, machined, brass receptacle sleeve.

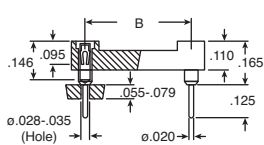
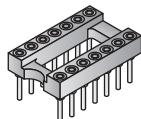

DIMENSIONS: in.

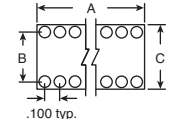

### Tin Sleeve, Tin Contact

For quantities of 1,000 and up, call for quote.

MOUSER STOCK NO.	Mill-Max Part No.	No. of Cont.	Dimensions: in.			Price Each			
			A	B	C	1	10	100	500
<b>RoHS Compliant</b>									
575-144308	110-44-308-41-001000	8	.4	.3	.4	.53	.44	.35	.31
575-1104314	110-44-314-41-001000	14	.7	.3	.4	.79	.74	.55	.49
575-1104316	110-44-316-41-001000	16	.8	.3	.4	1.06	.96	.85	.74
575-1104318	110-44-318-41-001000	18	.9	.3	.4	1.00	.96	.72	.62
575-1104320	110-44-320-41-001000	20	1.0	.3	.4	1.11	1.06	.79	.68
575-1104324	110-44-324-41-001000	24	1.2	.3	.4	1.34	1.26	.94	.83
575-1104328	110-44-328-41-001000	28	1.4	.3	.4	1.55	1.48	1.09	.96
575-1104624	110-44-624-41-001000	24	1.2	.6	.7	1.34	1.26	.94	.83
575-1104628	110-44-628-41-001000	28	1.4	.6	.7	1.66	1.57	1.16	1.01
575-1144632	110-44-632-41-001000	32	1.6	.6	.7	1.77	1.69	1.25	1.09
575-1104640	110-44-640-41-001000	40	2.0	.6	.7	2.22	2.11	1.56	1.37
<b>Non-RoHS Compliant</b>									
575-199308	110-99-308-41-001000	8	.4	.3	.4	.42	.41	.29	.26
575-199314	110-99-314-41-001000	14	.7	.3	.4	.74	.69	.52	.45
575-199316	110-99-316-41-001000	16	.8	.3	.4	.83	.80	.59	.51
575-199318	110-99-318-41-001000	18	.9	.3	.4	.93	.90	.66	.58
575-199320	110-99-320-41-001000	20	1.0	.3	.4	1.05	.98	.74	.64
575-199324	110-99-324-41-001000	24	1.2	.3	.4	1.25	1.18	.87	.77
575-199328	110-99-328-41-001000	28	1.4	.3	.4	1.45	1.39	1.02	.90
575-199624	110-99-624-41-001000	24	1.2	.6	.7	1.25	1.18	.87	.77
575-199628	110-99-628-41-001000	28	1.4	.6	.7	1.45	1.39	1.02	.90
575-199632	110-99-632-41-001000	32	1.6	.6	.7	1.66	1.59	1.17	1.02
575-199640	110-99-640-41-001000	40	2.0	.6	.7	2.08	1.98	1.46	1.28

### Tin Sleeve, Gold Contact

For quantities of 1,000 and up, call for quote.

MOUSER STOCK NO.	Mill-Max Part No.	No. of Cont.	Dimensions: in.			Price Each			
			A	B	C	1	10	100	500
<b>RoHS Compliant</b>									
575-11043308	110-43-308-41-001000	8	.4	.3	.4	.59	.45	.36	.31
575-143314	110-43-314-41-001000	14	.7	.3	.4	1.00	.97	.72	.63
575-11043161	110-43-316-41-001000	16	.8	.3	.4	1.14	1.10	.81	.72
575-11043318	110-43-318-41-001000	18	.9	.3	.4	1.30	1.22	.91	.80
575-11043320	110-43-320-41-001000	20	1.0	.3	.4	1.44	1.36	1.02	.89
575-11043324	110-43-324-41-001000	24	1.2	.3	.4	1.73	1.64	1.21	1.07
575-11043328	110-43-328-41-001000	28	1.4	.3	.4	2.01	1.91	1.42	1.25
575-11043422	110-43-422-41-001000	22	1.1	.4	.5	1.57	1.50	1.17	.97
575-11043624	110-43-624-41-001000	24	1.2	.6	.7	1.73	1.64	1.21	1.07
575-11043628	110-43-628-41-001000	28	1.4	.6	.7	2.01	1.91	1.42	1.25
575-11043632	110-43-632-41-001000	32	1.6	.6	.7	2.30	2.19	1.62	1.43
575-11043640	110-43-640-41-001000	40	2.0	.6	.7	2.86	2.73	2.02	1.76
575-11043648	110-43-648-41-001000	48	2.4	.6	.7	3.45	3.28	2.44	2.12
575-11043964	110-43-964-41-001000	64	3.2	.9	1.0	4.59	4.37	3.26	2.83
<b>Non-RoHS Compliant</b>									
575-193308	110-93-308-41-001000	8	.4	.3	.4	.58	.55	.42	.36
575-193314	110-93-314-41-001000	14	.7	.3	.4	.98	.93	.70	.60
575-193316	110-93-316-41-001000	16	.8	.3	.4	1.11	1.06	.79	.68
575-193318	110-93-318-41-001000	18	.9	.3	.4	1.26	1.20	.88	.78
575-193320	110-93-320-41-001000	20	1.0	.3	.4	1.40	1.32	1.00	.86
575-193324	110-93-324-41-001000	24	1.2	.3	.4	1.69	1.60	1.18	1.04
575-193328	110-93-328-41-001000	28	1.4	.3	.4	1.96	1.87	1.38	1.21
575-193422	110-93-422-41-001000	22	1.1	.4	.5	1.53	1.47	1.09	.94
575-193624	110-93-624-41-001000	24	1.2	.6	.7	1.69	1.60	1.18	1.04
575-193628	110-93-628-41-001000	28	1.4	.6	.7	1.96	1.87	1.38	1.21
575-193632	110-93-632-41-001000	32	1.6	.6	.7	2.31	2.19	1.62	1.43
575-193640	110-93-640-41-001000	40	2.0	.6	.7	2.80	2.65	1.98	1.72
575-193648	110-93-648-41-001000	48	2.4	.6	.7	3.36	3.20	2.38	2.07
575-193964	110-93-964-41-001000	64	3.2	.9	1.0	4.47	4.27	3.17	2.75

### Gold Sleeve, Gold Contact

For quantities of 1,000 and up, call for quote.

MOUSER STOCK NO.	Mill-Max Part No.	No. of Cont.	Dimensions: in.			Price Each			
			A	B	C	1	10	100	500
<b>RoHS Compliant</b>									
575-113308	110-13-308-41-001000	8	.4	.3	.4	.78	.74	.55	.48
575-113314	110-13-314-41-001000	14	.7	.3	.4	1.37	1.31	.96	.84
575-113316	110-13-316-41-001000	16	.8	.3	.4	1.56	1.49	1.10	.96
575-113318	110-13-318-41-001000	18	.9	.3	.4	1.76	1.67	1.25	1.06
575-113320	110-13-320-41-001000	20	1.0	.3	.4	1.96	1.86	1.38	1.20
575-113324	110-13-324-41-001000	24	1.2	.3	.4	2.34	2.22	1.66	1.44
575-113328	110-13-328-41-001000	28	1.4	.3	.4	2.74	2.60	1.93	1.68
575-113624	110-13-624-41-001000	24	1.2	.6	.7	2.34	2.22	1.66	1.44
575-113628	110-13-628-41-001000	28	1.4	.6	.7	2.74	2.60	1.93	1.68
575-113632	110-13-632-41-001000	32	1.6	.6	.7	3.12	2.98	2.21	1.93
575-113640	110-13-640-41-001000	40	2.0	.6	.7	3.90	3.72	2.76	2.40

## ULTRA LOW PROFILE IC SOCKETS WITH SCREW MACHINED SLEEVES

Socket height is .095" above the printed circuit board. It has all the features of the standard low profile series including open frame design, for maximum heat dissipation and easier cleaning. 4 finger stamped beryllium copper inner contact, press fitted into a precision machined brass receptacle sleeve.

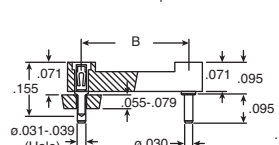
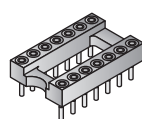

DIMENSIONS: in.

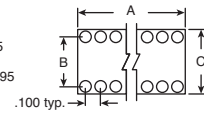

### Tin Sleeve, Tin Contact

For quantities of 1,000 and up, call for quote.

MOUSER STOCK NO.	Mill-Max Part No.	No. of Cont.	Dimensions: in.			Price Each			
			A	B	C	1	10	100	500
<b>RoHS Compliant</b>									
575-343308	115-43-308-41-003000	8	.4	.3	.4	1.03	.99	.73	.63
575-115433143	115-43-314-41-003000	14	.7	.3	.4	1.68	1.60	1.18	1.04
575-115433163	115-43-316-41-003000	16	.8	.3	.4	1.89	1.82	1.35	1.17
575-115433183	115-43-318-41-003000	18	.9	.3	.4	2.13	2.04	1.51	1.31
575-115433203	115-43-320-41-003000	20	1.0	.3	.4	2.27	2.17	1.61	1.40
575-115433243	115-43-324-41-003000	24	1.2	.3	.4	2.71	2.58	1.92	1.67
575-11532803	115-43-328-41-003000	28	1.4	.3	.4	3.15	3.00	2.22	1.93
575-115436243	115-43-624-41-003000	24	1.2	.6	.7	2.71	2.58	1.92	1.67
575-115436283	115-43-628-41-003000	28	1.4	.6	.7	3.15	3.00	2.22	1.93
575-115436323	115-43-632-41-003000	32	1.6	.6	.7	3.57	3.42	2.53	2.20
575-115436403	115-43-640-41-003000	40	2.0	.6	.7	4.44	4.24	3.15	2.74
<b>Non-RoHS Compliant</b>									
575-393308	115-93-308-41-003000	8	.4	.3	.4	.90	.86	.64	.56
575-393314	115-93-314-41-003000	14	.7	.3	.4	1.52	1.44	1.08	.94
575-393316	115-93-316-41-003000	16	.8	.3	.4	1.73	1.65	1.22	1.06
575-393318	115-93-318-41-003000	18	.9	.3	.4	1.95	1.86	1.39	1.19
575-393320	115-93-320-41-003000	20	1.0	.3	.4	2.09	2.00	1.48	1.29
575-393324	115-93-324-41-003000	24	1.2	.3	.4	2.62	2.49	1.85	1.61
575-393328	115-93-328-41-003000	28	1.4	.3	.4	2.92	2.80	2.07	1.81
575-393422	115-93-422-41-003000	22	1.1	.4	.5	2.41	2.28	1.70	1.48
575-393424	115-93-424-41-003000	24	1.2	.4	.5	2.60	2.49	1.85	1.61
575-393624	115-93-624-41-003000	24	1.2	.6	.7	2.50	2.39	1.78	1.55
575-393628	115-93-628-41-003000	28	1.4	.6	.7	2.92	2.80	2.07	1.81
575-393632	115-93-632-41-003000	32	1.6	.6	.7	3.44	3.28	2.43	2.12
575-393640	115-93-640-41-003000	40	2.0	.6	.7	4.19	3.99	2.96	2.58

## 3-LEVEL WIRE WRAP IC SOCKETS WITH SCREW MACHINED SLEEVES

Socket has .510" terminal lengths for 3 level, solderless wire wrapping. Terminals are locked into the insulator body to withstand the torques of wrapping tool. Open frame design for easier PCB cleaning and maximum heat dissipation. Features a 4 finger inner contact of beryllium copper, press fit into a precision machined brass receptacle sleeve.

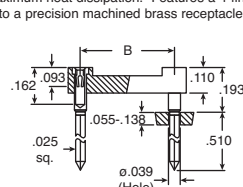
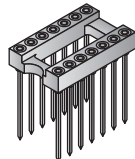

DIMENSIONS: in.

### Tin Sleeve, Gold Contact

For quantities of 1,000 and up, call for quote.

MOUSER STOCK NO.	Mill-Max Part No.	No. of Cont.	Dimensions: in.			Price Each			
			A	B	C	1	10	100	500
<b>RoHS Compliant</b>									
575-12343308	123-43-308-41-001000	8	.4	.3	.4				