

KYCON Mini-DIN Connectors

RoHS Compliant This product is RoHS compliant.



RIGHT ANGLE PCB RECEPTACLES

- Fully Shielded for good conductivity, grounding, and EMI/RFI protection
- Mates with standard and snap and lock plugs
- Body Material: PBT Thermoplastic, UL94V-0 rated
- Contact Material: Phosphor Bronze, Gold plated
- RoHS Compliance per Kycon Documentation
- Shield Material: Brass, Tin Plated
- Solder Tails: Tin Plated Over Nickel
- Operating Temperature: -25°C to +85°C

KMDG Series * Meets PC99 specifications † Pan = Pantone For quantities of 1000 and up, call for quote.

MOUSER STOCK NO.	Kycon Part No.	Fig.	No. of Pos.	Color	Price Each			
					1	25	100	500
806-KMDGX-3S-BS	KMDGX-3S-BS	A	3	Black	.73	.65	.58	.53
806-KMDGX-4S-BS	KMDGX-4S-BS	A	4	Black	1.01	.98	.72	.58
* 806-KMDGX-4S-BS-99	KMDGX-4S-BS-99	A	4	† Pan 123C Yellow	1.23	1.19	.87	.70
806-KMDGX-5S-BS	KMDGX-5S-BS	A	5	Black	1.18	1.14	.83	.67
806-KMDGX-6S-BS	KMDGX-6S-BS	A	6	Black	1.25	1.22	.90	.66
* 806-KMDGX-6S-BS2715C	KMDGX-6S-BS2715C	A	6	† Pan 2715C Purple	1.13	1.10	.81	.64
* 806-KMDGX-6S-BS3395C	KMDGX-6S-BS3395C	A	6	† Pan 3395C Green	1.04	.99	.88	.70
806-KMDGX-7S-BS	KMDGX-7S-BS	A	7	Black	1.28	1.25	.92	.73
806-KMDGX-8S-BS	KMDGX-8S-BS	A	8	Black	1.24	1.21	.89	.70
806-KMDGX-9S-BS	KMDGX-9S-BS	A	9	Black	1.28	1.25	.92	.73
806-KMDGX-10S-BS	KMDGX-10S-BS	A	10	Black	2.36	2.30	1.68	1.35
With GEO S-Video Port								
806-KMDGX-GEO-7SBS	KMDGX-GEO-7S-BS	A	7	Black	1.04	.92	.83	.75

RIGHT ANGLE FERRITE FILTERED PCB RECEPTACLES

- Fully Shielded for good conductivity, grounding, and EMI/RFI protection
- Mates with standard and snap and lock plugs
- Body Material: PBT Thermoplastic, UL94V-0 rated
- Contact Material: Phosphor Bronze, Gold plated
- RoHS Compliance per Kycon Documentation
- Shield Material: Brass, Tin Plated
- Solder Tails: Tin Plated Over Nickel
- Operating Temperature: -25°C to +85°C

KFMDG Series For quantities of 1000 and up, call for quote.

MOUSER STOCK NO.	Kycon Part No.	Fig.	No. of Pos.	Color	Price Each			
					1	25	100	500
806-KFMDGX-4S-BS	KFMDGX-4S-BS	A	4	Black	1.76	1.55	1.39	1.26
806-KFMDGX-5S-BS	KFMDGX-5S-BS	A	5	Black	1.99	1.89	1.69	1.52
806-KFMDGX-6S-BS	KFMDGX-6S-BS	A	6	Black	2.42	2.23	1.63	1.38
806-KFMDGX-8S-BS	KFMDGX-8S-BS	A	8	Black	2.46	2.27	1.66	1.40

RIGHT ANGLE STACKED PCB RECEPTACLES

- Fully Shielded for good conductivity, grounding, and EMI/RFI protection
- Mates with standard and snap and lock plugs
- Body Material: PBT Thermoplastic, UL94V-0 rated
- Contact Material: Phosphor Bronze, Gold plated
- RoHS Compliance per Kycon Documentation
- Shield Material: Brass, Tin Plated
- Solder Tails: Tin Plated Over Nickel
- Operating Temperature: -25°C to +85°C

KMDG Series * Meets PC99 Specifications † Pan = Pantone For quantities of 1000 and up, call for quote.

MOUSER STOCK NO.	Kycon Part No.	Fig.	No. of Pos.	Color	Price Each			
					1	25	100	500
806-KMDGX-4S/4S-S4N	KMDGX-4S/4S-S4N	B	4 over 4	Black	1.99	1.92	1.40	1.12
806-KMDGX-6S/6S-S4N	KMDGX-6S/6S-S4N	B	6 over 6	Black	1.94	1.89	1.39	1.11
* 806-KMDGX-6SGP-S4N	KMDGX-6SG/P-S4N	B	6 over 6	† Pan 3395C Green over Pan 2715C Purple	2.57	2.51	1.68	1.22
806-KMDGX-6SGPS4N1	KMDGX-6SG/P-S4N1	B	6 over 6	Green/Purple	2.70	2.63	1.93	1.54
806-KMDGX-8S/8S-S4N	KMDGX-8S/8S-S4N	B	8 over 8	Black	3.89	2.85	2.04	1.82

RIGHT ANGLE ROUNDED LOW PROFILE PCB RECEPTACLES

- Contacts: Phosphor Bronze Gold Flash on contacts Tin on termination
- Body: PBT Thermoplastic, UL94V-0 rated
- Shield: SPCC, Tin plated
- Operating Temperature: -25°C to +85°C
- RoHS Compliance per Kycon Documentation

KMDR Series For quantities of 1000 and up, call for quote.

MOUSER STOCK NO.	Kycon Part No.	Fig.	No. of Positions	Color	Price Each			
					1	25	100	500
806-KMDRX-4S-BS	KMDRX-4S-BS	C	4	Black	1.79	1.73	1.26	1.03
806-KMDRX-6S-BS	KMDRX-6S-BS	C	6	Black	1.90	1.83	1.34	1.08

CABLE MOUNT PLUGS

- Insert Material: PBT Thermoplastic, UL94V-0 rated
- Shell Material: PVC, UL94V-0 rated
- Contact Material: Brass, Silver plated
- Shield Material: Nickel plated Iron sheet
- Durability: 1500 Cycles
- Operating Temperature: -25°C to +80°C
- RoHS Compliance per Kycon Documentation

KMDA and KMDLA Series For quantities of 1000 and up, call for quote.

MOUSER STOCK NO.	Kycon Part No.	Fig.	No. of Pos.	Color	Price Each			
					1	25	100	500
806-KMDAX-3P	KMDAX-3P	D	3	Black	1.09	.97	.87	.79
806-KMDAX-4P	KMDAX-4P	D	4	Black	1.39	1.23	1.10	.93
806-KMDAX-5P	KMDAX-5P	D	5	Black	1.36	1.20	1.08	.98
806-KMDAX-6P	KMDAX-6P	D	6	Black	1.89	1.75	1.28	1.09
806-KMDAX-7P	KMDAX-7P	D	7	Black	1.92	1.84	1.35	1.14
806-KMDAX-8P	KMDAX-8P	D	8	Black	2.01	1.92	1.40	1.19
* 806-KMDAX-9P	KMDAX-9P	D	9	Black	2.67	2.29	1.78	1.60
Snap and Lock								
806-KMDLAX-3P	KMDLAX-3P	E	3	Black	2.74	2.40	2.13	1.92
806-KMDLAX-4P	KMDLAX-4P	E	4	Black	2.89	2.53	2.24	2.02
806-KMDLAX-5P	KMDLAX-5P	E	5	Black	3.03	2.65	2.36	2.12
806-KMDLAX-6P	KMDLAX-6P	E	6	Black	2.70	2.36	2.10	1.89
806-KMDLAX-7P	KMDLAX-7P	E	7	Black	3.32	2.90	2.58	2.32
806-KMDLAX-8P	KMDLAX-8P	E	8	Black	2.94	2.58	2.29	2.06

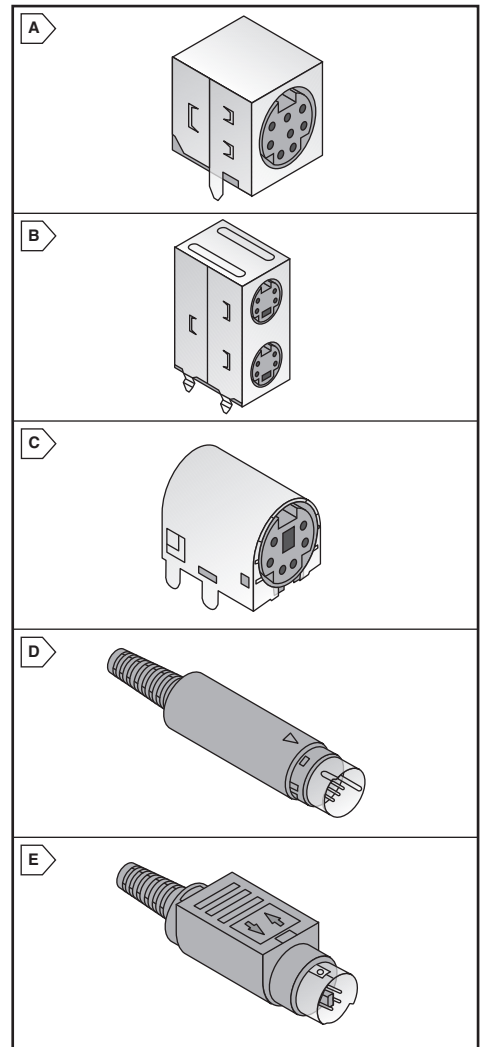
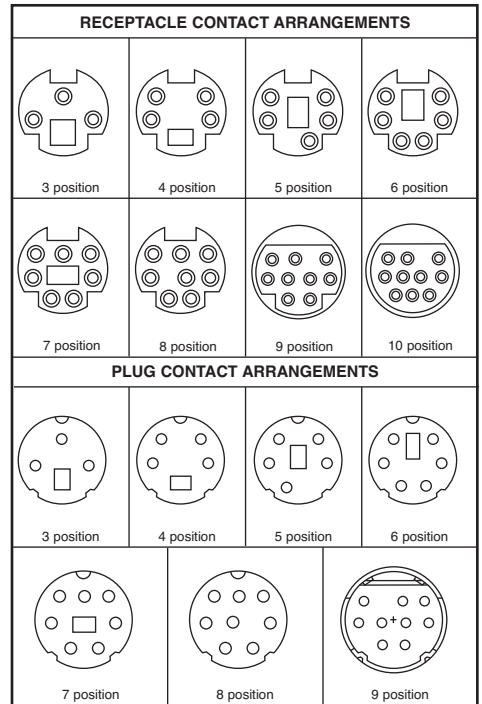

Circular Connectors Kycon