

NXP SEMICONDUCTOR Diodes

RoHS Compliant This product is RoHS compliant.



SMALL SIGNAL SCHOTTKY DIODES

For quantities of 250 and up, call for quote.

MOUSER STOCK NO.	NXP Part No.	Package	Configuration	V _R max (V)	I _F max (mA)	V _F max (mV)	@ I _F (mA)	I _R max (μA)	@ V _R (V)	Price Each		
										1	25	100
771-BAT754S-T/R	BAT754S	SOT23	Dual Series	30	200	340	10	2	25	.31	.24	.20
771-BAT754C-T/R	BAT754C	SOT23	Dual Common Cathode	30	200	340	10	2	25	.18	.15	.128
771-BAS85-T/R	BAS85	SOD80	Single	30	200	400	10	2	25	.11	.09	.053
771-BAT85-T/R	BAT85	SOD68	Single	30	200	400	10	2	25	.21	.18	.15
771-BAT54-T/R	BAT54	SOT23	Single	30	200	400	10	2	25	.05	.04	.038
771-BAT54H-T/R	BAT54H	SOD123	Single	30	200	400	10	2	25	.21	.18	.12
771-BAT54W-T/R	BAT54W	SOT323	Single	30	200	400	10	2	25	.14	.12	.082
771-1PS76SB10-T/R	1PS76SB10	SOD323	Single	30	200	400	10	2	25	.20	.17	.13
771-BAT54S-T/R	BAT54S	SOT23	Dual Series	30	200	400	10	2	25	.08	.07	.065
771-BAT54SW-T/R	BAT54SW	SOT323	Dual Series	30	200	400	10	2	25	.17	.15	.101
771-BAT54C-T/R	BAT54C	SOT23	Dual Common Cathode	30	200	400	10	2	25	.12	.08	.065
771-BAT54CW-T/R	BAT54CW	SOT323	Dual Common Cathode	30	200	400	10	2	25	.13	.10	.08
771-BAT54A-T/R	BAT54A	SOT23	Dual Common Anode	30	200	400	10	2	25	.12	.08	.065
771-BAT54AW-T/R	BAT54AW	SOT323	Dual Common Anode	30	200	400	10	2	25	.10	.09	.078
771-BAT74-T/R	BAT74	SOT143	Dual Isolated	30	200	400	10	2	25	.25	.20	.15
771-BAT54XY-T/R	BAT54XY	SOT363	Dual-Dual Series	30	200	400	10	2	25	.35	.31	.25
771-PMEG3002AEL-T/R	PMEG3002AEL	SOD882	Single	30	200	300	10	30	10	.24	.20	.171
771-BAS40H-T/R	BAS40H	SOD123	Single	40	120	500	10	1	30	.25	.21	.19
771-BAS40L315	BAS40L315	SOD882	Single	40	120	500	10	1	30	.20	.18	.169
771-BAS40-04-T/R	BAS40-04	SOT23	Dual Series	40	120	500	10	1	30	.08	.06	.05
771-BAS40-04W-T/R	BAS40-04W	SOT323	Dual Series	40	120	500	10	1	30	.31	.25	.213
771-BAT721S-T/R	BAT721S	SOT23	Dual Series	40	200	300	10	15	30	.35	.31	.25
771-BAT721C-T/R	BAT721C	SOT23	Dual Common Cathode	40	200	300	10	15	30	.36	.32	.27
771-BAT721A-T/R	BAT721A	SOT23	Dual Common Anode	40	200	300	10	15	30	.30	.26	.214
771-PMEG4002EL-T/R	PMEG4002EL	SOD882	Single	40	200	360	10	0.5	25	.27	.20	.171
771-BAS86-T/R	BAS86	SOD80	Single	50	200	450	10	5	40	.25	.21	.19
771-BAS70-T/R	BAS70	SOT23	Single	70	70	750	10	0.1	50	.07	.06	.05
771-BAS70-04-T/R	BAS70-04	SOT23	Dual Series	70	70	750	10	0.1	50	.17	.13	.097
771-BAS70-04W-T/R	BAS70-04W	SOT323	Dual Series	70	70	750	10	0.1	50	.10	.08	.07
771-BAS70-05-T/R	BAS70-05	SOT23	Dual Common Cathode	70	70	750	10	0.1	50	.11	.09	.081
771-BAS70-06-T/R	BAS70-06	SOT23	Dual Common Anode	70	70	750	10	0.1	50	.11	.09	.081
771-BAS70-07-T/R	BAS70-07	SOT143	Dual Isolated	70	70	750	10	0.1	50	.27	.21	.177

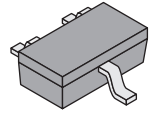

SOT23/SOT323

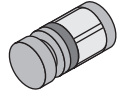

SOD80/SOD87

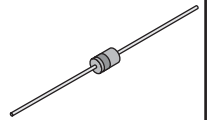

SOD68

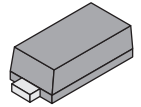

SOD123/SOD523

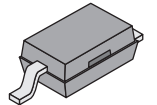

SOD323

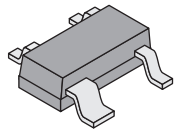

SOT143

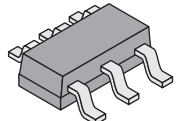

SOT363/SOT457

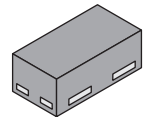

SOD882

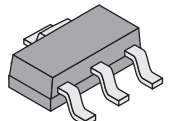

SOT223

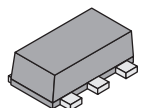

SOT666

LOW VF SCHOTTKY DIODES

For quantities of 250 and up, call for quote.

MOUSER STOCK NO.	NXP Part No.	Package	Configuration	Features	I _F max (A)	V _R max (V)	V _F max (mV) @ I _F max	I _R max (mA) @ V _R max	Price Each		
									1	25	100
771-PMEG3002AEB-T/R	PMEG3002AEB	SOD523	Single	Low VF/Low IR	0.2	30	480	0.05	.21	.18	.161
771-PMEG3002AEL-T/R	PMEG3002AEL	SOD882	Single	Low VF/Low IR	0.2	30	480	0.05	.24	.20	.171
771-PMEG4002EL-T/R	PMEG4002EL	SOD882	Single	Low VF/Low IR	0.2	40	600	0.01	.27	.20	.171
771-PMEG2005ET215	PMEG2005ET215	SOT23	Single	Low VF/Low IR	0.5	20	390	0.2	.26	.20	.16
771-PMEG2005EH-T/R	PMEG2005EH	SOD123	Single	Low VF/Low IR	0.5	20	390	0.2	.26	.20	.191
771-PMEG2005EJ115	PMEG2005EJ115	SOD323	Single	Low VF/Low IR	0.5	20	390	0.2	.26	.20	.191
771-PMEG3005ET-T/R	PMEG3005ET	SOT23	Single	Low VF/Low IR	0.5	30	430	0.15	.26	.20	.16
771-PMEG3005EH-T/R	PMEG3005EH	SOD123	Single	Low VF/Low IR	0.5	30	430	0.15	.26	.20	.191
771-PMEG3005EJ-T/R	PMEG3005EJ	SOD323	Single	Low VF/Low IR	0.5	30	430	0.15	.26	.20	.191
771-PMEG4005ET-T/R	PMEG4005ET	SOT23	Single	Low VF/Low IR	0.5	40	470	0.1	.26	.20	.16
771-PMEG4005EH-T/R	PMEG4005EH	SOD123	Single	Low VF/Low IR	0.5	40	470	0.1	.26	.20	.191
771-PMEG4005EJ-T/R	PMEG4005EJ	SOD323	Single	Low VF/Low IR	0.5	40	470	0.1	.26	.20	.191
771-PMEG2010AEH-T/R	PMEG2010AEH	SOD123	Single	Very Low VF	1	20	430	0.2	.18	.14	.12
771-PRLL5817-T/R	PRLL5817	SOD87	Single	Very Low VF	1	20	450	1	.31	.27	.24
771-PMEG2010ET-T/R	PMEG2010ET	SOT23	Single	Low VF/Low IR	1	20	500	0.2	.18	.14	.12
771-PMEG2010EH115	PMEG2010EH115	SOD123	Single	Low VF/Low IR	1	20	500	0.2	.18	.14	.12
771-PMEG2010EJ-T/R	PMEG2010EJ	SOD323	Single	Low VF/Low IR	1	20	500	0.2	.18	.14	.12
771-PMEG2010EA-T/R	PMEG2010EA	SOD323	Single	Very Low IR	1	20	550	0.05	.18	.14	.12
771-PMEG2010AEJ-T/R	PMEG2010AEJ	SOD323	Single	Very Low IR	1	20	550	0.05	.18	.14	.12
771-BAT120C115	BAT120C115	SOT223	Dual Common Cathode	Very Low VF	1	25	450	1	.75	.67	.51
771-PMEG3010CEJ-T/R	PMEG3010CEJ	SOD323	Single	Very Low IR	1	30	520	0.05	.18	.14	.12
771-PRLL5818-T/R	PRLL5818	SOD87	Single	Very Low VF	1	30	550	1	.31	.27	.24
771-PMEG3010ET-T/R	PMEG3010ET	SOT23	Single	Low VF/Low IR	1	30	560	0.15	.18	.14	.12
771-PMEG3010EH-T/R	PMEG3010EH	SOD123	Single	Low VF/Low IR	1	30	560	0.15	.18	.14	.12
771-PMEG3010EJ115	PMEG3010EJ115	SOD323	Single	Low VF/Low IR	1	30	560	0.15	.18	.14	.12
771-PRLL5819-T/R	PRLL5819	SOD87	Single	Very Low VF	1	40	600	1	.31	.27	.24
771-PMEG4010ET215	PMEG4010ET215	SOT23	Single	Low VF/Low IR	1	40	640	0.1	.18	.14	.12
771-PMEG4010EH-T/R	PMEG4010EH	SOD123	Single	Low VF/Low IR	1	40	640	0.1	.18	.14	.12
771-PMEG4010EJ-T/R	PMEG4010EJ	SOD323	Single	Low VF/Low IR	1	40	640	0.1	.18	.14	.12
771-PMEG4010CEH-T/R	PMEG4010CEH	SOD123	Single	Very Low IR	1	40	570	0.05	.18	.14	.12
771-PMEG4010CEJ-T/R	PMEG4010CEJ	SOD323	Single	Very Low IR	1	40	570	0.05	.18	.14	.12
771-PMEG6010AED115	PMEG6010AED115	SOT457	Single	Low VF/Low IR	1	60	650	0.35	.18	.14	.12
771-PMEG6010CEH-T/R	PMEG6010CEH	SOD123	Single	Very Low IR	1	60	710	0.1	.18	.14	.12
771-PMEG6010CEJ-T/R	PMEG6010CEJ	SOD323	Single	Very Low IR	1	60	710	0.1	.18	.14	.12
771-PMEG2015EH-T/R	PMEG2015EH	SOD123	Single	Low VF/Low IR	1.5	20	660	0.2	.18	.14	.12
771-PMEG3015EH-T/R	PMEG3015EH	SOD123	Single	Very Low VF	1.5	30	550	1	.18	.14	.12
771-PMEG3015EJ115	PMEG3015EJ115	SOD323	Single	Very Low VF	1.5	30	550	1	.18	.14	.12
771-PMEG1020EH-T/R	PMEG1020EH	SOD123	Single	Very Low VF	2	10	460	3	.18	.14	.12
771-PMEG1020EJ-T/R	PMEG1020EJ	SOD323	Single	Very Low VF	2	10	460	3	.18	.14	.12
771-PMEG1020EV115	PMEG1020EV115	SOT666	Single	Very Low VF	2	10	460	3	.18	.14	.12
771-PMEG2020EH-T/R	PMEG2020EH	SOD123	Single	Very Low VF	2	20	525	0.2	.18	.14	.12
771-PMEG2020AEA-T/R	PMEG2020AEA	SOD323	Single	Very Low VF	2	20	525	0.2	.18	.14	.12
771-PMEG2020EJ-T/R	PMEG2020EJ	SOD323	Single	Very Low VF	2	20	525	0.2	.18	.14	.12
771-PMEG3020EH-T/R	PMEG3020EH	SOD123	Single	Very Low VF	2	30	620	1	.18	.14	.12
771-PMEG3020EJ-T/R	PMEG3020EJ	SOD323	Single	Very Low VF	2	30	620	1	.18	.14	.12
771-PMEG1030EH-T/R	PMEG1030EH	SOD123	Single	Very Low VF	3	10	530	3	.34	.29	.238
771-PMEG1030EJ-T/R	PMEG1030EJ	SOD323	Single	Very Low VF	3	10	530	3	.34	.29	.238