

IXYS Diodes and Power Devices



SCHOTTKY DIODES

- Vrrm: 8V to 200V. Ifav:6A to 200A
- Extremely low switching losses
- Low voltage peaks for reduced protection circuits
- Very low VF, Low IRM-values, Low noise switching
- High reliability circuit operation

This product is RoHS compliant.

For quantities greater than listed, call for quote.

MOUSER STOCK NO.	IXYS Part No.	Package Style	VRRM (V)	IFAVM d=0.5 Total (A)	Configuration	Price Each			
						1	10	20	50
747-DSSK70-0015B	DSSK70-0015B	TO-247AD	15	70	Common Cathode	4.93	3.94	3.12	2.96
747-DSS16-0045A	DSS16-0045A	TO-220AC	45	16	Single	2.01	1.68	1.51	1.34
747-DSS25-0045A	DSS25-0045A	TO-220AC	45	25	Single	2.31	1.93	1.74	1.54
747-DSSK80-0045B	DSSK80-0045B	TO-247AD	45	80	Common Cathode	5.78	4.62	4.25	3.47
747-DSS2X121-0045B	DSS2X121-0045B	SOT-227B	45	2x120	Dual	32.13	25.70	23.56	19.27
747-DSS2X41-01A	DSS2X41-01A	SOT-227B	100	2x40	Dual	26.88	21.50	19.71	16.12
747-DSS2X61-01A	DSS2X61-01A	SOT-227B	100	2x60	Dual	28.23	23.35	21.02	18.68
747-DSS2X160-01A	DSS2X160-01A	SOT-227B	100	2x160	Dual	32.45	25.96	22.41	19.48
747-DSSK60-015A	DSSK60-015A	TO-247AD	150	60	Common Cathode	6.38	5.10	4.39	3.82

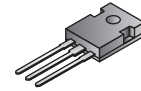

TO-247AD

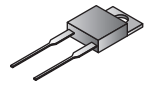

TO-220AC

FAST RECOVERY (FRED) DIODES

- Blocking voltages: 200V to 1200V
- trr : < 40ns
- Variety of packages, including isolated types available.
- Ifav: 6A - 165A
- Single, Dual or Common Cathode configurations available

For quantities greater than listed, call for quote.

MOUSER STOCK NO.	IXYS Part No.	Package Style	VRRM (V)	IFAVM d=0.5 Total (A)	Configuration	Price Each			
						1	10	20	50
747-DSEI2X121-02A	DSEI2X121-02A	SOT-227B	200	2x123	Dual	33.00	26.40	24.20	19.79
747-DSEI8-06A	DSEI8-06A	TO-220AC	600	8	Single	1.10	.88	.75	.66
747-DSEI12-06A	DSEI12-06A	TO-220AC	600	14	Single	1.60	1.28	1.12	.96
747-DSS17-06CR	DSS17-06CR	ISOPLUS-247	600	17	Single	15.78	13.15	11.83	10.52
747-DSEP29-06B	DSEP29-06B	TO-220AC	600	30	Single	3.57	2.98	2.68	2.38
747-DSEP30-06A	DSEP30-06A	TO-247AC	600	30	Single	4.13	3.30	3.12	2.72
747-DSEI30-06A	DSEI30-06A	TO-247AD	600	37	Single	4.26	3.55	3.19	2.84
747-DSEI60-06A	DSEI60-06A	TO-247AD	600	60	Single	5.65	4.52	4.14	3.39
747-DSEK60-06A	DSEK60-06A	TO-247AD	600	60	Common Cathode	5.73	4.58	4.20	3.43
747-MEK95-06DA	MEK95-06DA	TO-240AA	600	95	Common Cathode	49.35	41.12	37.01	32.90
747-DSEP2X61-06A	DSEP2X61-06A	SOT-227B	600	120	Dual	35.00	28.00	25.66	21.00
747-DSEI12-10A	DSEI12-10A	TO-220AC	1000	12	Single	1.65	1.32	1.21	.99
747-DSEI30-10A	DSEI30-10A	TO-247AD	1000	30	Single	3.65	2.92	2.60	2.19
747-DSEI60-10A	DSEI60-10A	TO-247AD	1000	60	Single	5.83	4.66	4.37	3.49
747-DSEI2X31-10B	DSEI2X31-10B	SOT-227B	1000	2x30	Dual	25.25	20.20	17.50	15.16
747-DSEI12-12A	DSEI12-12A	TO-220AC	1200	11	Single	1.68	1.34	1.22	1.01
747-DSEP12-12A	DSEP12-12A	TO-220AC	1200	15	Single	1.72	1.55	1.39	1.17
747-DSEI20-12A	DSEI20-12A	TO-220AC	1200	17	Single	2.70	2.16	1.98	1.63
747-DSEI30-12A	DSEI30-12A	TO-247AD	1200	26	Single	3.73	2.98	2.45	2.23
747-DSEP30-12A	DSEP30-12A	TO-247AC	1200	30	Single	4.50	3.60	3.12	2.70
747-DSEI60-12A	DSEI60-12A	TO-247AD	1200	52	Single	5.93	4.74	4.12	3.55
747-DSEP60-12A	DSEP60-12A	TO-247AC	1200	60	Single	6.66	6.02	5.24	4.74
747-DSI60-18A	DSI60-18A	TO-247AD	1800	63	--	21.78	19.70	16.40	13.79
747-DH2X60-18A	DH2X60-18A	SOT-227B	1800	2x60	Dual	47.34	39.98	35.77	31.56

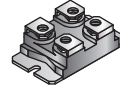

SOT-227B

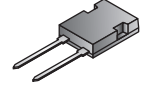

ISOPLUS-247

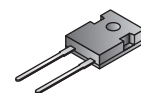

TO-247AC

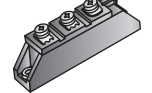

TO-240AA

RECTIFIER DIODES

- Vrrm: 800 to 1600V. If(av): 2.3A to 110A
- Planar glassivated chips
- Single, Phase leg, common cathode or dual diode
- DS: Standard DSA-Avalanche rated
- Ideal for 50/60 Hz rectification



For quantities greater than listed, call for quote.

MOUSER STOCK NO.	IXYS Part No.	Package Style	VRRM (V)	IF (A)	Configuration	Price Each			
						1	10	20	50
747-DSI35-12A	DSI35-12A	DO-203AB	1200	49	Single	8.58	7.15	6.44	5.72
747-DSP25-12A	DSP25-12A	TO-247AD	1200	56	Phase Leg	4.25	3.40	3.12	2.55
747-DSI60-14A	DSI60-14A	TO-247AD	1400	63	-	7.30	-	-	-
747-DSA2-16A	DSA2-16A	Axial	1600	3.6	Single	4.38	3.50	3.12	2.63
747-DSA9-16F	DSA9-16F	DO-203AA	1600	11	Single	8.19	6.83	6.14	5.46
747-DSA17-16A	DSA17-16A	DO-203AA	1600	25	Single	7.92	7.16	6.45	5.66
747-DSA17-16A	DSA17-16A	DO-203AA	1600	25	Single	7.92	7.16	6.94	5.66
747-DSP25-16A	DSP25-16A	TO-247AD	1600	56	Phase Leg	4.65	3.72	3.41	2.79
747-DSP25-16AR	DSP25-16AR	ISOPLUS-247	1600	56	Phase Leg	8.97	7.47	6.72	5.98
747-DSA75-16B	DSA75-16B	DO-203AB	1600	110	Single	23.08	20.88	20.25	16.49
747-DSAI75-16B	DSAI75-16B	DO-203AB	1600	110	Single	23.08	20.88	20.25	16.49
747-DSA1-18D	DSA1-18D	Plastic	1800	2.3	Single	4.56	3.80	3.42	3.04

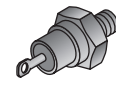

DO-203AB

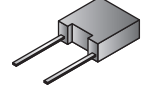

Axial

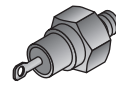

DO-203AA

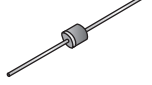

Plastic

POWER MODULES AND POWER DEVICES

For quantities greater than listed, call for quote.

MOUSER STOCK NO.	IXYS Part No.	Package Style	Volts	Amps	Configuration	Price Each			
						1	10	20	50
747-IXCP10M45S	IXCP10M45S	TO-220AB	450	10	Single	2.10	1.68	1.56	1.39
747-IXCP10M90S	IXCP10M90S	TO-220AB	900	100	Single	3.60	3.00	2.70	2.40
747-DSA1-18D	DSA1-18D	Plastic	1800	2.3	Single	4.56	3.80	3.42	3.04

IXBD4411 ISOLATED HALF BRIDGE DRIVER CHIP SET AND EVALUATION BOARD



For quantities greater than listed, call for quote.

MOUSER STOCK NO.	IXYS Part No.	Package Style	Description	Ipk Tc=25°C (A)	PD Tc=25°C (W)	Price Each			
						1	10	20	50
747-IXBD4411SI	IXBD4411SI	SOIC-CT-16	High Side Driver	2	33	4.44	3.70	3.33	2.96
Evaluation Board Description									
747-EVBD4400	EVBD4400		Half Bridge Driver Evaluation Board			176.24	-	-	-

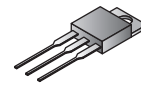

TO-220AB

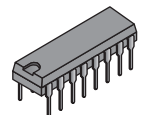

SOIC-CT-16